

BENCH MARKS:

CP#1 @ "1" IN SOUTH WALK ON MAPLE ST &
CENTER LINE EXTENDED OF ALLEY = 628.39
RR1 SPIKE 2nd PP#79195005 S. OF MAPLE = 633.00
CP#10 @ N.L. OF WINSLOW ST & ALLEY = 627.64

LEGEND:

- 4" SIDEWALK REMOVAL & REPLACEMENT=
- 6" DRIVEWAY REMOVAL & REPLACEMENT=
- 6" SIDEWALK REMOVAL & REPLACEMENT=
- 8" DRIVEWAY REMOVAL & REPLACEMENT=

NOTES:

- ① ADJUST SANITARY MANHOLE-REPLACE EXISTING MANHOLE FRAME & COVER WITH A NEW FRAME & SELF-SEALING LID (SUPPLIED BY THE CITY). INSTALL 3" INTERNAL / EXTERNAL ADAPTOR SEAL (I.A.S.) WITH 10" RUBBER SLEEVE (SUPPLIED BY THE CONTRACTOR).
- ② RECONSTRUCT SANITARY MANHOLE-REPLACE EXISTING MANHOLE FRAME & COVER WITH A NEW FRAME & SELF-SEALING LID (SUPPLIED BY THE CITY). INSTALL 3" INTERNAL / EXTERNAL ADAPTOR SEAL (I.A.S.) WITH 10" RUBBER SLEEVE (SUPPLIED BY THE CONTRACTOR).
- ③ RECONSTRUCT TYPE A STORM WATER INLET.
- ④ RECONSTRUCT TYPE B STORM WATER INLET.
- ⑤ INSTALL/ADJUST STORM MANHOLE FRAME & COVER, IF NEW IS NEEDED THE CITY WILL SUPPLY.
- ⑥ INSTALL/ADJUST STORM INLET FRAME & COVER, IF NEW IS NEEDED THE CITY WILL SUPPLY.
- ⑦ THE CONTRACTOR SHALL INSTALL INLET PROTECTION TYPE C ON ALL INLETS WITHIN OR ADJACENT TO THE PAVING LIMITS OF THE CONTRACT.
- ⑧ BUILD TYPE 1 RAMP 6-INCH WITH DETECTABLE WARNING FIELD YELLOW.
- ⑨ BUILD TYPE 2 RAMP 6-INCH WITH DETECTABLE WARNING FIELD YELLOW.
- ⑩ TYPE A PAVEMENT REMOVAL AND REPLACEMENT.
- ⑪ TYPE B PAVEMENT REMOVAL AND REPLACEMENT.
- ⑫ TYPE D PAVEMENT REMOVAL AND REPLACEMENT.
- ⑬ BUILD TYPE A STORM WATER INLET.
- ⑭ BUILD TYPE B STORM WATER INLET.
- ⑮ REBUILD STORM MANHOLE.
- ⑯ REBUILD SANITARY MANHOLE.



TO OBTAIN LOCATIONS OF PARTICIPANTS UNDERGROUND UTILITIES BEFORE YOU DIG IN WISCONSIN

CALL DIGGERS HOTLINE
1-800-242-8511
WE STRIKE 1600hrs (4:00P) REQUIRES 3 WORK DAYS NOTICE BEFORE YOU EXCAVATE
TDD 1-800-542-2899
www.DiggersHotline.com

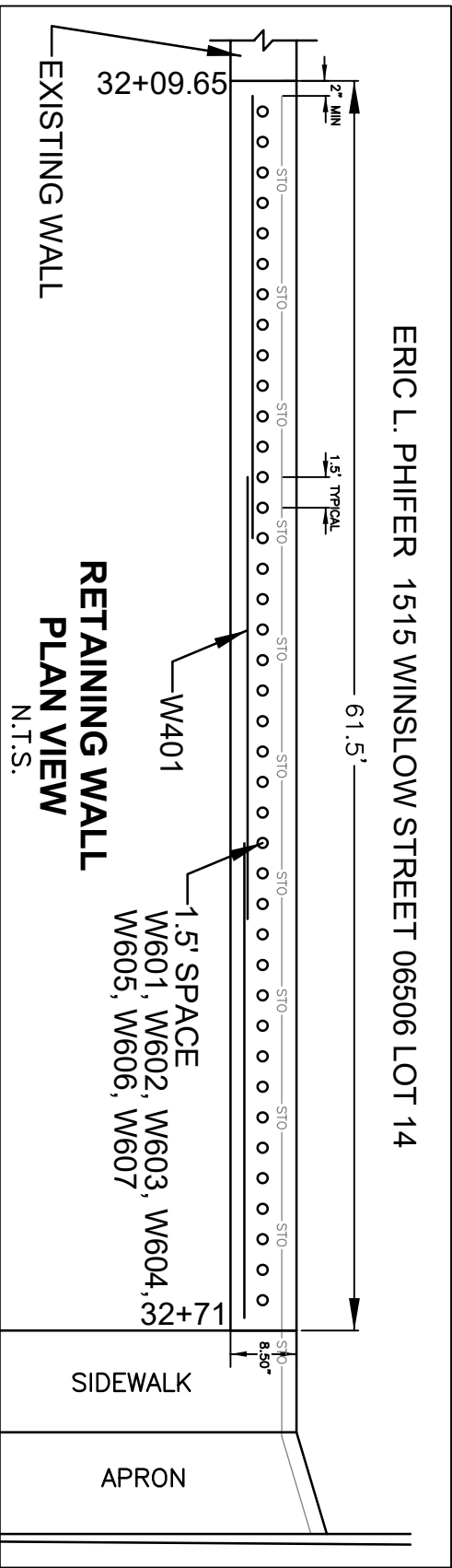
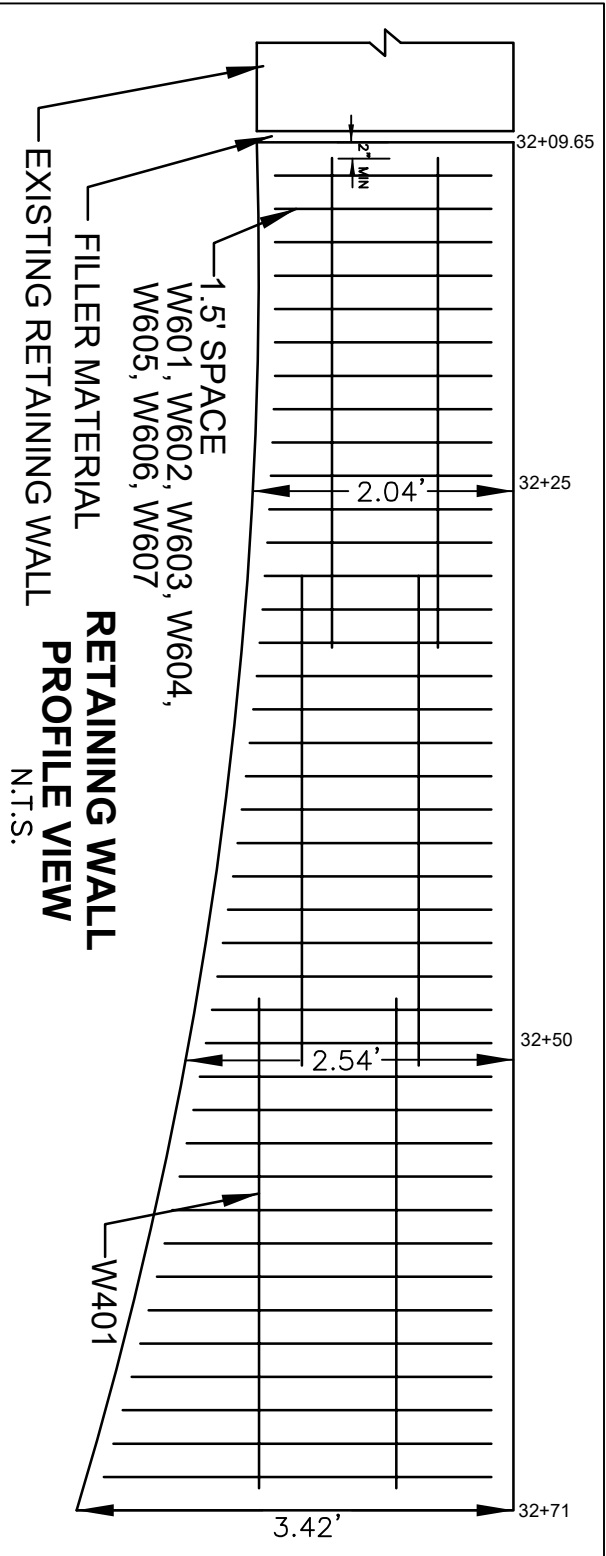
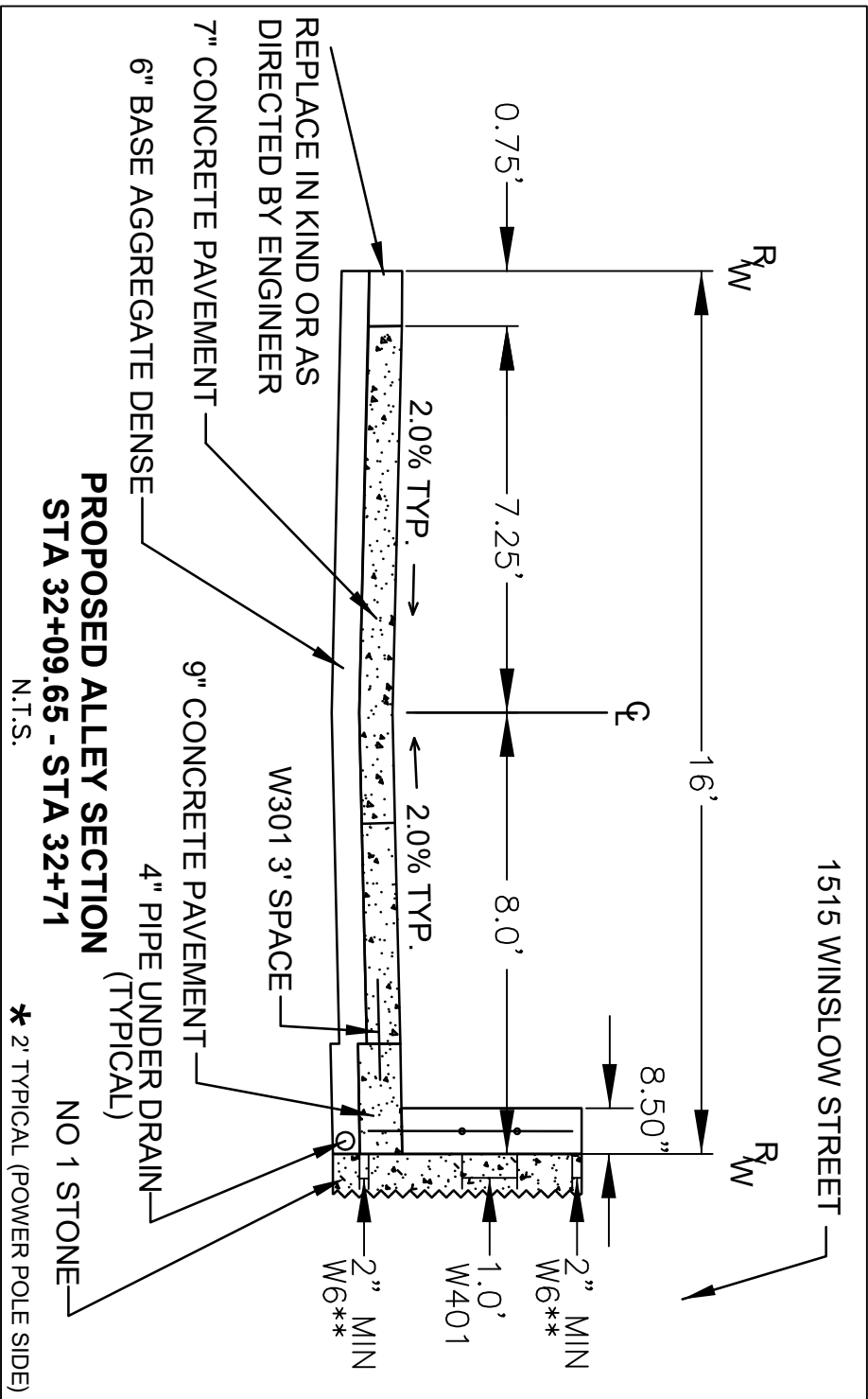

DATE	CONTRACT NUMBER	DESIGNED	DRAWN	CHECKED	SURVEYED	FIELD BOOK	PAGE	TYPE OF WORK	LOCATION	CONFINES	SCALE	OFFICE OF THE CITY ENGINEER	SHEET
MM-YY	2021006	RLF 12-20	JCK 01-21	APM 02-21	JCK 10-20	2020	73	CONCRETE MASONRY RETAINING WALL	ALLEY	MAPLE STREET TO WINSLOW STREET/ JONES STREET TO N. MEMORIAL DRIVE	1" = 20' 1" = 2' VERIFY SCALES LENGTH OF BAR IS 1" ON THIS DRAWING IF BAR IS NOT 1" ADJUST SCALES ACCORDINGLY	<div>Richard S. Trautner</div> <div>January 28, 2022</div>	23 OF 25
												CASE	DRAWER
													FOLDER