

TOTAL SQUARE
FOOTAGE FOR
BUILDING: 79,652

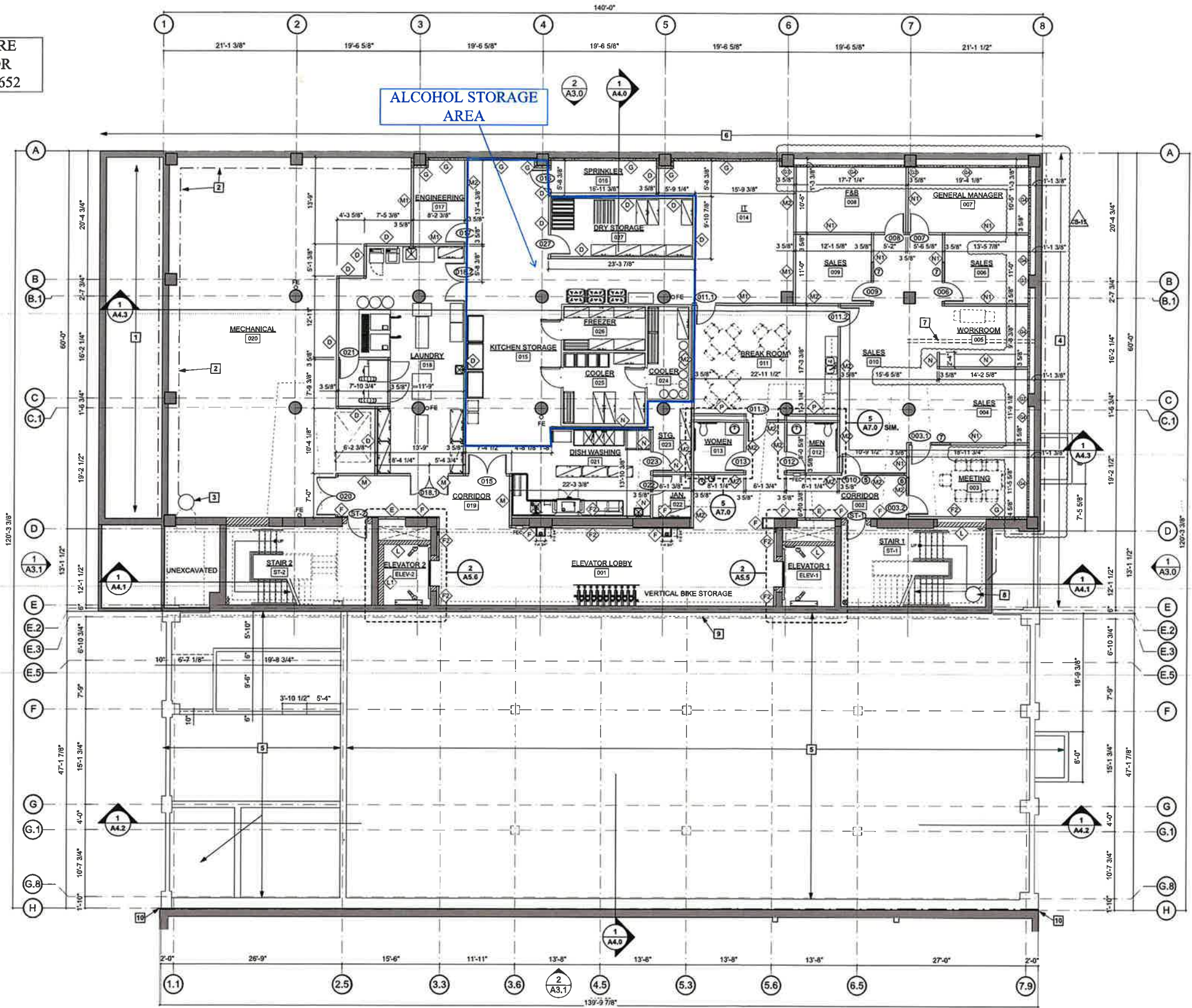

1 LOWER FLOOR PLAN
A1.0 SCALE: 1/8" = 1'-0"

- PLAN GENERAL NOTES**
- 1 PLAN DIMENSIONS ARE TO FACE OF STUD, UNLESS NOTED OTHERWISE.
 - 2 FURNITURE & MILLWORK SHOWN FOR REFERENCE ONLY. REFER TO INTERIOR DESIGN SHEETS FOR INFORMATION INCLUDING BUT NOT LIMITED TO FINISHES & FF&E.
 - 3 PLUMBING AND ELECTRICAL DESIGN-BUILD CONTRACTORS TO COORDINATE ALL REQUIRED SERVICES WITH CLIENT AND EQUIPMENT DRAWINGS

- PLAN KEYED NOTES**
- 1 EXISTING INFILLED VAULT AREA BENEATH SIDEWALK. EXCAVATE DOWN 4". WATERPROOF AND ADD 2" OF RIGID INSULATION @ WEST LOWER LEVEL WALL.
ADD DRAIN TILE, AND CONNECT TO EXISTING SUMP CROCK.
 - 2 NEW DRAIN TILE CONNECTED TO EXISTING SUMP CROCK, AND NEW CONCRETE FLOOR ABOVE.
 - 3 EXISTING SUMP CROCK.
 - 4 EXCAVATE DOWN 4". WATERPROOF AND ADD 2" OF RIGID INSULATION @ EAST LOWER LEVEL WALL.
ADD DRAIN TILE, AND CONNECT TO NEW SUMP CROCK.
 - 5 BACKFILL WITH COMPACTED LIFTS OF WELL DRAINING GRANULAR FILL, AND PROVIDE NEW CONCRETE SIDEWALK PER CITY STANDARDS.
 - 6 REMOVE UNCOMPACTED GRANULAR FILL DOWN TO VIRGIN SOIL. REINSTALL IN COMPACTED LIFTS PER GEOTECHNICAL REPORT.
 - 7 AT JOINT BETWEEN BUILDING WALL AND SIDEWALK, INSTALL BACKER ROD AND SEALANT TO MINIMIZE STORM WATER INFILTRATION @ NORTH LOWER LEVEL WALL. ALSO ADD SEALANT TO ALL SIDEWALK JOINTS ON NORTH SIDE OF BUILDING.
 - 8 PATCH CONCRETE FLOOR.
 - 9 NEW SUMP CROCK.
 - 10 EXISTING DRAIN TILE AND WATERPROOFING. CONTRACTOR TO VERIFY EXISTANCE AND FUNCTIONALITY.
 - 11 COLUMN LINE 'H' IS ESTABLISHED AS THE SOUTH FACE OF THE BUILDING ADDITION / FACE OF CONCRETE FOUNDATION WALL / FACE OF PRECAST CONCRETE WALL PANELS. EXISTING BUILDING TO THE SOUTH IS NOT PARALLEL TO COLUMN LINE 'H'. COLUMN LINE 'H' IS APPROXIMATELY 1" NORTH OF THE EXISTING BLDG. AT THE SOUTHWEST CORNER AND 3 1/2" NORTH OF THE EXISTING BUILDING AT THE SOUTHEAST CORNER. RIGID BOARD INSULATION IS TO BE INSTALLED AGAINST THE EXISTING BUILDING TO FILL THE TAPERED GAP BETWEEN THE SOUTH FACE OF THE NEW ADDITION (COLUMN LINE 'H') AND THE EXISTING BUILDING.

- SYMBOL KEY**
- DEMO EXISTING CONSTRUCTION
 - EXISTING CONSTRUCTION TO REMAIN
 - NEW WALL
 - FIRE EXTINGUISHER CABINET
 - FEC WALL MOUNTED FIRE EXTINGUISHER
 - FE
 - xx WINDOW TAG
 - 000 DOOR TAG
 - X GUEST BATHROOM TYPE
 - NEW DOOR
 - XXX ROOM NAME & NUMBER
 - 000 EXTERIOR ELEVATION TAG
 - B STRUCTURAL GRID LINE
 - 0 A0.0 WALL OR BUILDING SECTION
 - WALL TYPE
 - 0 A0.0 INTERIOR ELEVATION TAG



The Kubala Washko Architects, Inc.
W61 N617 Mequon Avenue
Cedarburg, WI 53012
p: 262.377.8039 | f: 262.377.2954

PROJECT
**HOTEL
VERDANT**

500 Main Street
Racine, WI 53403

OWNER
THE MAIN ATTRACTION, LLC
2025 N. Summit Ave
Milwaukee, WI 53202
p: 414.264.5901

CONSTRUCTION MANAGER
CG SCHMIDT
11777 Wisconsin Lakes Drive
Milwaukee, WI 53224
p: 414.577.1177

INTERIOR DESIGNER
THE GETTYS GROUP
55 W. Wacker Drive, 4th Floor
Chicago, IL 60601
p: 312.532.2444

STRUCTURAL ENGINEER
PIERCE ENGINEERS, INC.
181 N. Broadway
Milwaukee, WI 53202
p: 414.278.5850

CIVIL & LANDSCAPE
R.A. SMITH, INC.
221 S. 2nd Street
Milwaukee, WI 53204
p: 262.781.1000

PLUMBING/FF&E ENGINEER (DESIGN ASSIST)
RING & DUCHATEAU, LLP
17400 W. Capital Drive
Brookfield, WI 53005
p: 414.778.7438

HVAC ENGINEER
RING & DUCHATEAU, LLP
17400 W. Capital Drive
Brookfield, WI 53005
p: 414.778.7438

ELECTRICAL ENGINEER (DESIGN ASSIST)
RING & DUCHATEAU, LLP
17400 W. Capital Drive
Brookfield, WI 53005
p: 414.778.7438

LIGHTING DESIGNER
RING & DUCHATEAU, LLP
17400 W. Capital Drive
Brookfield, WI 53005
p: 414.778.7438

ACOUSTICAL CONSULTANT
SHINER & ASSOCIATES, INC.
225 W. Washington St. Suite 1625
Chicago, IL 60606
p: 312.849.3340

FOOD SERVICE/LAUNDRY
CAPITAL FOODSERVICE
DESIGN, LLC
1522 Lakar View Avenue
Madison, WI 53704
p: 608.514.4372

REVISIONS

CB-1	January 10, 2022
CB-6	March 16, 2022
CB-7	April 19, 2022
CB-9	May 11, 2022
CB-15	August 05, 2022

DATE
May 5, 2021

PROJECT NUMBER
222718.01

SHEET TITLE

**Lower Floor
Plan**

SHEET NUMBER
A1.0

Copyright © 2021 The Kubala Washko Architects, Inc.
All Rights Reserved

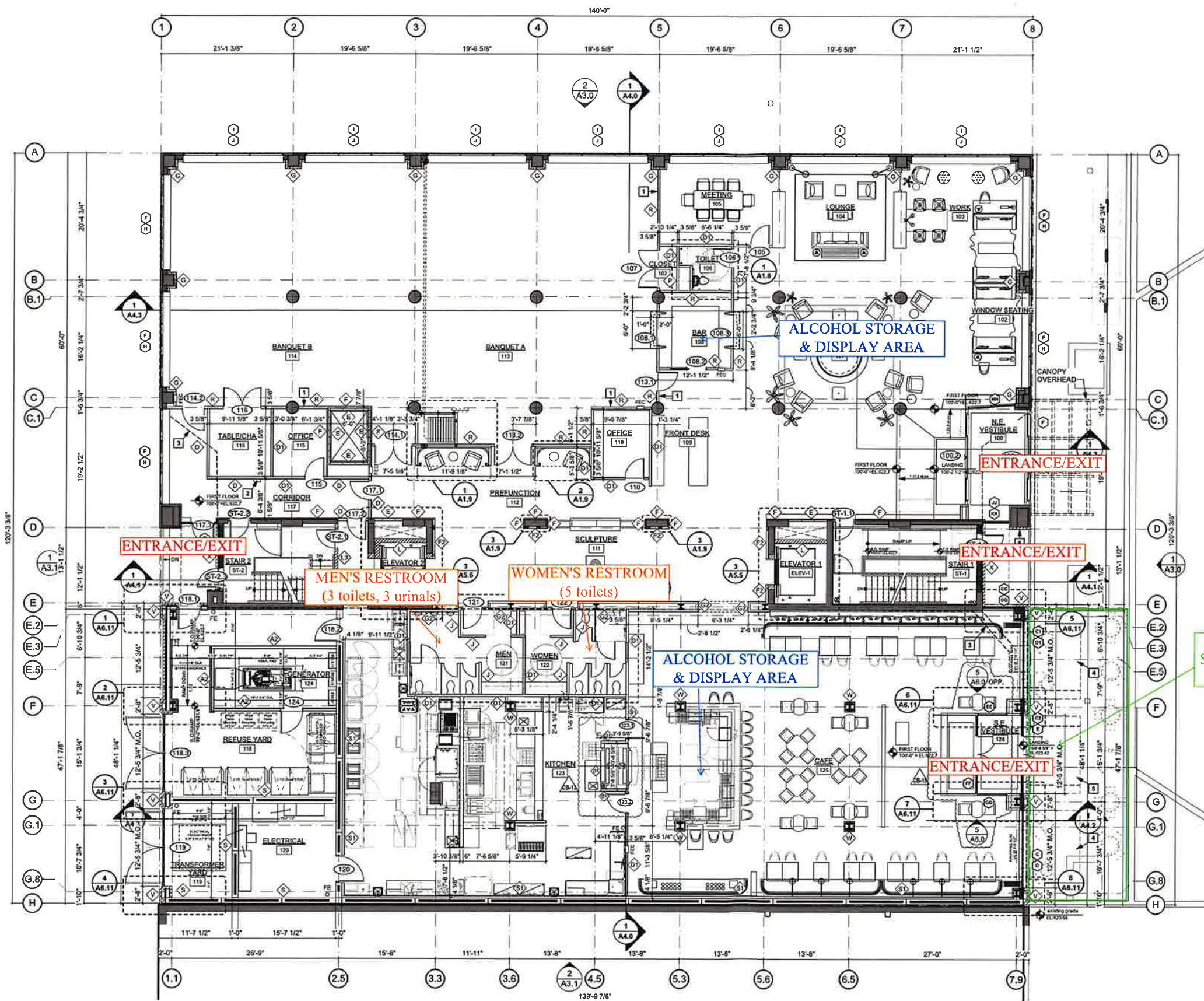

1 FIRST FLOOR PLAN
 SCALE: 1/8" = 1'-0"

PLAN GENERAL NOTES

- 1 PLAN DIMENSIONS ARE TO FACE OF STUD, UNLESS NOTED OTHERWISE.
- 2 FURNITURE & MILLWORK SHOWN FOR REFERENCE ONLY. REFER TO INTERIOR DESIGN SHEETS FOR INFORMATION INCLUDING BUT NOT LIMITED TO FINISHES & FF&E.
- 3 PLUMBING AND ELECTRICAL DESIGN-BUILD CONTRACTORS TO COORDINATE ALL REQUIRED SERVICES WITH CLIENT AND EQUIPMENT DRAWINGS.

PLAN KEYED NOTES

- 1 CENTER PARTITION ON COLUMN CENTERLINE.
- 2 WALL MOUNTED DEFIBRILLATOR STATION.
- 3 LINE OF EXISTING BUILDING SHOWN DASHED.
- 4 MORTORIZED RETRACTABLE FABRIC AWNING WITH ROLL-DOWN SCREEN, AWNING TO PROJECT 8'-6" FROM FACE OF BUILDING.
- 5 MORTORIZED RETRACTABLE FABRIC AWNING, AWNING TO PROJECT 8'-6" FROM FACE OF BUILDING.
- 6 PROVIDE 1899 FACEBRICK EXTENDING FROM CONCRETE BRICK LEDGE UP TO ELEVATION OF TOP OF CAST STONE ACCENTS (PREVIOUSLY REMOVED). CONCRETE BRICK LEDGE TO BE CREATED BY PARTIAL DEMO OF EXISTING CONCRETE BASE. INTENT IS TO REPLICATE EXISTING CONDITION ON EAST FACE ON NEW SOUTH AND WEST FACES. (1" CHAMFER TOP).

SYMBOL KEY

- DEMO EXISTING CONSTRUCTION
- EXISTING CONSTRUCTION TO REMAIN
- NEW WALL
- FE FIRE EXTINGUISHER CABINET
- FE WALL MOUNTED FIRE EXTINGUISHER
- XX WINDOW TAG
- 000 DOOR TAG
- X GUEST BATHROOM TYPE
- NEW DOOR
- XXX ROOM NAME & NUMBER
- 0 EXTERIOR ELEVATION TAG
- 8 — STRUCTURAL GRID LINE
- 0 WALL OR BUILDING SECTION
- X WALL TYPE
- 0 INTERIOR ELEVATION TAG

OUTDOOR AREA FOR SEASONAL SALE, SERVICE & CONSUMPTION



The Kubala Washatko Architects, Inc.
 W61 N617 Mequon Avenue
 Cedarburg, WI 53012
 p: 262.377.6039 | f: 262.377.2954

PROJECT
HOTEL VERDANT

500 Main Street
 Racine, WI 53403

OWNER
 THE MAIN ATTRACTION, LLC
 2025 N. Summit Ave
 Milwaukee, WI 53202
 p: 414.264.5961

CONSTRUCTION MANAGER
 CG SCHMIDT
 1777 West Lake Park Drive
 Milwaukee, WI 53224
 p: 414.577.1177

INTERIOR DESIGNER
 THE GETTYS GROUP
 55 W. Wacker Drive, 4th Floor
 Chicago, IL 60601
 p: 312.632.2444

STRUCTURAL ENGINEER
 PIERCE ENGINEERS, INC.
 181 N. Broadway
 Milwaukee, WI 53202
 p: 414.275.0000

CIVIL & LANDSCAPE
 R.A. SMITH, INC.
 221 S. 2nd Street
 Milwaukee, WI 53204
 p: 262.781.1000

PLUMBING/FP ENGINEER (DESIGN ASSIST)
 RING & DUCHATEAU, LLP
 17400 W. Capitol Drive
 Brookfield, WI 53045
 p: 414.778.7438

HVAC ENGINEER
 RING & DUCHATEAU, LLP
 17400 W. Capitol Drive
 Brookfield, WI 53045
 p: 414.778.7438

ELECTRICAL ENGINEER (DESIGN ASSIST)
 RING & DUCHATEAU, LLP
 17400 W. Capitol Drive
 Brookfield, WI 53045
 p: 414.778.7438

LIGHTING DESIGNER
 RING & DUCHATEAU, LLP
 17400 W. Capitol Drive
 Brookfield, WI 53045
 p: 414.778.7438

ACOUSTICAL CONSULTANT
 SHINER & ASSOCIATES, INC.
 225 W. Washington St, Suite 1625
 Chicago, IL 60606
 p: 312.849.3340

FOOD SERVICE/LAUNDRY
 CAPITAL FOODSERVICE DESIGN, LLC
 1522 Laker View Avenue
 Madison, WI 53704
 p: 608.514.4373

REVISIONS

AD-1	Addendum #1	May 19, 2021
CB-1	January 10, 2022	
CB-6	March 16, 2022	
CB-7	April 19, 2022	
CB-9	May 11, 2022	
CB-15	August 05, 2022	

DATE
 May 5, 2021

PROJECT NUMBER
 222718.01

SHEET TITLE
 First Floor Plan

SHEET NUMBER
 A1.1

Copyright © 2021 The Kubala Washatko Architects, Inc.
 All Rights Reserved

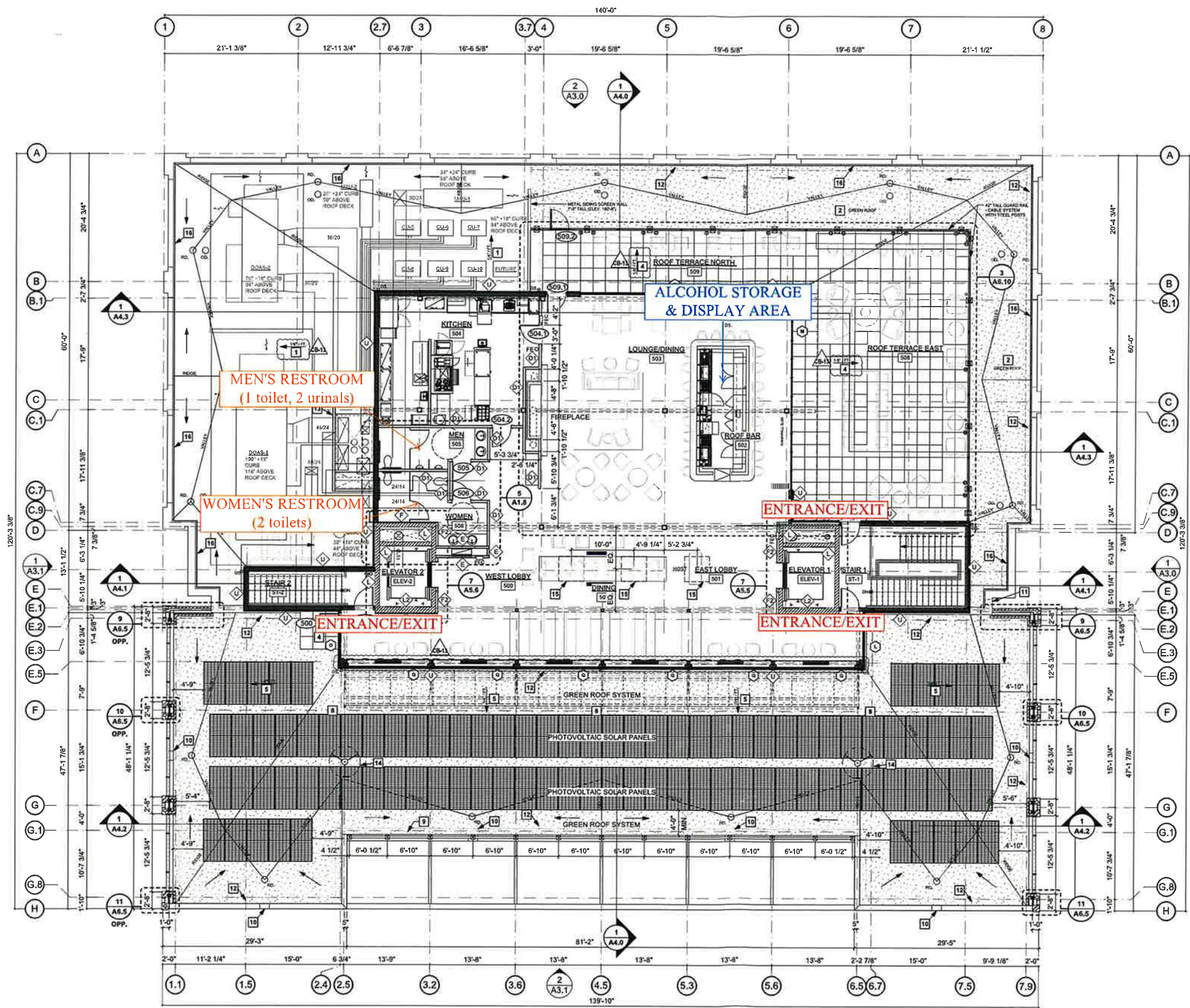

1 FIFTH FLOOR AND LOW ROOF PLAN
 A1.5 SCALE: 1/8" = 1'-0"

PLAN GENERAL NOTES

- 1 PLAN DIMENSIONS ARE TO FACE OF STUD, UNLESS NOTED OTHERWISE.
- 2 FURNITURE & MILLWORK SHOWN FOR REFERENCE ONLY. REFER TO INTERIOR DESIGN SHEETS FOR INFORMATION INCLUDING BUT NOT LIMITED TO FINISHES & FF&E.
- 3 PLUMBING AND ELECTRICAL DESIGN-BUILD CONTRACTORS TO COORDINATE ALL REQUIRED SERVICES WITH CLIENT AND EQUIPMENT DRAWINGS.

PLAN KEYED NOTES

- 1 FULLY ADHERED MEMBRANE ROOF, SLOPED TO ROOF DRAINS, OVER TAPERED INSULATION (1/8" / FT.).
- 2 GREEN ROOF SYSTEM OVER FULLY ADHERED MEMBRANE ROOF, SLOPED TO ROOF DRAINS, OVER TAPERED INSULATION (1/8" / FT.). NOTE: GREEN ROOF SYSTEM - NOT IN CONTRACT.
- 3 FULLY ADHERED MEMBRANE ROOF OVER SLOPED STRUCTURE.
- 4 EXTERIOR DECK PAVERS ON PEDESTAL SUPPORTS OVER FULLY ADHERED MEMBRANE ROOF, SLOPED TO ROOF DRAINS, OVER TAPERED INSULATION (1/8" / FT.).
- 5 GREEN ROOF SYSTEM OVER FULLY ADHERED MEMBRANE ROOF, SLOPED TO ROOF DRAINS, OVER TAPERED INSULATION (1/8" / FT.). GREEN ROOF SYSTEM TO PROVIDE BALLAST FOR PV SOLAR PANELS. NOTE: GREEN ROOF SYSTEM - NOT IN CONTRACT.
- 6 STANDING SEAM METAL ROOFING.
- 7 SOLAR PANELS ON STEEL BRACKETS.
- 8 RAIN CHAIN.
- 9 PAINTED STEEL PIPE RAILING.
- 10 ROOF OVERFLOW SCUPPER THRU PARAPET WALL.
- 11 FOR OVERFLOW DRAINS AT NORTH EXISTING BUILDING, ROUTE PIPING TO TERMINATE AT SCUPPER THRU PARAPET WALL.
- 12 12 INCH WIDE DECORATIVE GRAVEL STRIP, SEE GREEN ROOF PLAN.
- 13 RAISED ROOF ABOVE DUCT SHAFT TO ACCOMMODATE SIDEWALL DUCT AND PIPE PENETRATIONS. COVER ALL SIDES WITH T.P.O. ROOF MEMBRANE. COORDINATE WITH HVAC FOR HEIGHT. CONSTRUCT RAISED ROOF FROM 2 HR SHAFTWALL.
- 14 WIND TURBINE.
- 15 SKYLIGHT.
- 16 NEW GUARDRAIL MOUNTED TO BACKSIDE OF EXISTING PARAPET WALL.

SYMBOL KEY

- DEMO EXISTING CONSTRUCTION
- EXISTING CONSTRUCTION TO REMAIN
- NEW WALL
- FE FIRE EXTINGUISHER CABINET
- WALL MOUNTED FIRE EXTINGUISHER
- ⊠ WINDOW TAG
- ⊞ DOOR TAG
- ⊞ GUEST BATHROOM TYPE
- NEW DOOR
- XXX ROOM NAME & NUMBER
- ⊞ EXTERIOR ELEVATION TAG
- STRUCTURAL GRID LINE
- ⊞ WALL OR BUILDING SECTION
- ⊞ WALL TYPE
- ⊞ INTERIOR ELEVATION TAG

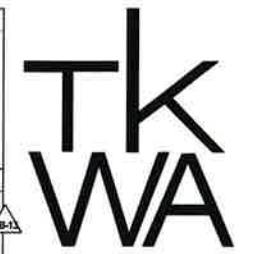

The Kubala Washatko Architects, Inc.
 W61 N617 Mequon Avenue
 Cedarburg, WI 53012
 p. 262.377.6039 | f. 262.377.2954

PROJECT
HOTEL VERDANT
 500 Main Street
 Racine, WI 53403

OWNER
THE MAIN ATTRACTION, LLC
 2025 N. Summit Ave
 Milwaukee, WI 53202
 p. 414.254.5901

CONSTRUCTION MANAGER
CG SCHMIDT
 11777 West Lake Park Drive
 Milwaukee, WI 53224
 p. 414.577.1177

INTERIOR DESIGNER
THE GETTYS GROUP
 55 W. Wacker Drive, 4th Floor
 Chicago, IL 60601
 p. 312.632.2444

STRUCTURAL ENGINEER
PIERCE ENGINEERS, INC.
 181 N. Broadway
 Milwaukee, WI 53202
 p. 414.278.6000

CIVIL & LANDSCAPE
R.A. SMITH, INC.
 221 S. 2nd Street
 Milwaukee, WI 53204
 p. 262.781.1000

PLUMBING/FP ENGINEER (DESIGN ASSIST)
RING & DUCHATEAU, LLP
 17400 W. Capitol Drive
 Brookfield, WI 53005
 p. 414.778.7438

HVAC ENGINEER
RING & DUCHATEAU, LLP
 17400 W. Capitol Drive
 Brookfield, WI 53005
 p. 414.778.7438

ELECTRICAL ENGINEER (DESIGN ASSIST)
RING & DUCHATEAU, LLP
 17400 W. Capitol Drive
 Brookfield, WI 53005
 p. 414.778.7438

LIGHTING DESIGNER
RING & DUCHATEAU, LLP
 17400 W. Capitol Drive
 Brookfield, WI 53005
 p. 414.778.7438

ACOUSTICAL CONSULTANT
SHINER & ASSOCIATES, INC.
 225 W. Washington St, Suite 1625
 Chicago, IL 60606
 p. 312.949.3340

FOOD SERVICE/LAUNDRY
CAPITAL FOODSERVICE DESIGN, LLC
 1522 Lakar View Avenue
 Madison, WI 53704
 p. 608.514.4373

REVISIONS

NO.	DATE
CB-1	January 10, 2022
CB-6	March 16, 2022
CB-7	April 19, 2022
CB-9	May 11, 2022
CB-11	May 27, 2022
CB-13	July 22, 2022

DATE
 May 5, 2021

PROJECT NUMBER
 222718.01

SHEET TITLE

Fifth Floor And Low Roof Plan

SHEET NUMBER
A1.5

Copyright © 2021 The Kubala Washatko Architects, Inc. All Rights Reserved.