



Application for Design Review

Applicant Name: Veridian Development LLC
Address: 701 Grand Avenue City: Racine
State: WI Zip: 53403
Telephone: 2629898087 Cell Phone: _____
Email: ZPrideaux@SienaCatholicSchools.Org

Agent Name: Zach Prideaux
Address: 701 Grand Avenue City: Racine
State: WI Zip: 53403
Telephone: 2629898087 Cell Phone: _____
Email: ZPrideaux@SienaCatholicSchools.Org

Property Address (Es): 701 Grand Avenue
Current Zoning: B-4
Current/Most Recent Property Use: Private Office
Proposed Use: Private Office

Numerous areas of the City have design guidelines which are specific to projects and must be adhered to. The design guidelines can be found at the following link under the design review district heading on the page: <https://www.buildupracine.org/business-tools/planning/>





DEPARTMENT OF CITY DEVELOPMENT



Acknowledgement and authorization signatures

Design Review is not like a building permit; applying does not mean it will be approved.

The approval may contain conditions related to the improvement of the site which must be met prior to the occupancy of the building, approval of the final work, or otherwise specified. Improvements may include but are not limited to landscaping, fencing, lighting, pavement surfacing and sealing, dumpster enclosures, and exterior building improvements.

The signature(s) hereby certify that the statements made by myself and constituting part of this application are true and correct. I am fully aware that any misrepresentation of any information on this application may be grounds for denial of this application.

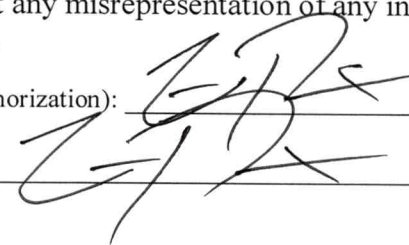
Owner Signature (acknowledgement and authorization):  Date: 5/16/25

Applicant Signature (acknowledgement):  Date: 5/16/25





Veridian Development LLC
701 Grand Avenue
Racine, WI 53403

May 19th, 2025

Project Description: Perimeter Security Enhancement - 701 Grand Avenue Parking Lot

We would like to commend the Department of City Development for their ongoing and successful efforts in supporting the 'Build Up Racine' initiative, which has significantly contributed to the positive transformation of our downtown area. In the spirit of further enhancing the safety and appeal of our community, we submit this project description for consideration.

This project entails the installation of a vinyl privacy fence around the perimeter parking lot located at 701 Grand Avenue. This private office space, situated on the northwest corner of the property with existing parking accessible from both 7th Street and Grand Avenue, has experienced recurring issues with vagrancy and vandalism. The proposed fencing aims to mitigate these issues by providing a visual and physical barrier, thereby enhancing the security and maintenance of the property.

Hours of Operation: Construction activities for the fence installation are anticipated to occur between the hours of 8:00 AM and 5:00 PM daily.

Anticipated Delivery Schedule: The project is scheduled to commence on Thursday, June 5th, 2025, and is expected to be completed by Sunday, June 8th, 2025.

Maintenance Plan: The installed vinyl privacy fence is designed for low maintenance. Routine visual inspections will be conducted by property management to identify and address any potential damage or necessary repairs. Cleaning will be performed as needed to maintain its appearance. The gates will be regularly checked to ensure proper functionality.

General Use of the Building and Lot: The building at 701 Grand Avenue serves as a private office space and is not open to the general public. The surrounding parking lot provides private parking for employees and visitors of the office. The proposed fence will screen this existing parking area from public sidewalks, enhancing security without altering the fundamental use of the building or the provision of necessary parking. Two gated entrances will be incorporated into the fence design to maintain existing vehicular access points from both 7th Street and Grand Avenue. This design ensures continued functionality while addressing the security concerns and aligning with the aesthetic considerations of the Downtown Design Review Corridor.



Veridian Development LLC
701 Grand Avenue
Racine, WI 53403

May 19th, 2025

Subject: Site and Landscape Plan - 701 Grand Avenue Security Enhancement

To ensure a comprehensive and informative submission, we have prepared a detailed site and landscape plan for the property located at 701 Grand Avenue, incorporating all relevant design and access considerations.

The existing building is situated on the northwest corner of the property. The current parking area extends around the eastern and southern sides of the building, with existing vehicular access points from both Grand Avenue and 7th Street.

The proposed security enhancement involves the installation of a new perimeter fence, depicted in red on the attached plan. The fence design is as follows:

1. **Northeastern Section:** The fence will commence at the building's northeastern corner, extending eastward along the property line for fifteen feet. A driving gate will be strategically incorporated into this section. This placement directly on the property line is intended to eliminate any concealed areas, thereby enhancing visibility and security from street view.
2. **Eastern Section:** From the north-easternmost point, the fence will continue southward, following the property line. It will terminate two feet north of the south-eastern edge of the property line. This deliberate two-foot setback on the southern side is maintained to facilitate future maintenance access for the fence and to ensure unimpeded access for neighboring properties to their driveway, accommodating any potential future repairs or replacements.
3. **Southern Section:** From its south-eastern terminus, the fence will turn westward for 49 feet, leading to the southwestern corner of the property. It will then extend northward for 25 feet. This specific placement ensures clear access to existing utilities located on the southwest corner of the building. A second driving gate will be integrated into this section of the design to maintain full vehicular accessibility.

The current visibility of the parking lot from both 7th Street and Grand Avenue has inadvertently allowed for unauthorized pedestrian traffic and created areas within the lot that are obscured from public view, contributing to instances of vagrancy and vandalism. This proposed fencing plan directly addresses these security concerns by screening the parking area while preserving necessary access.

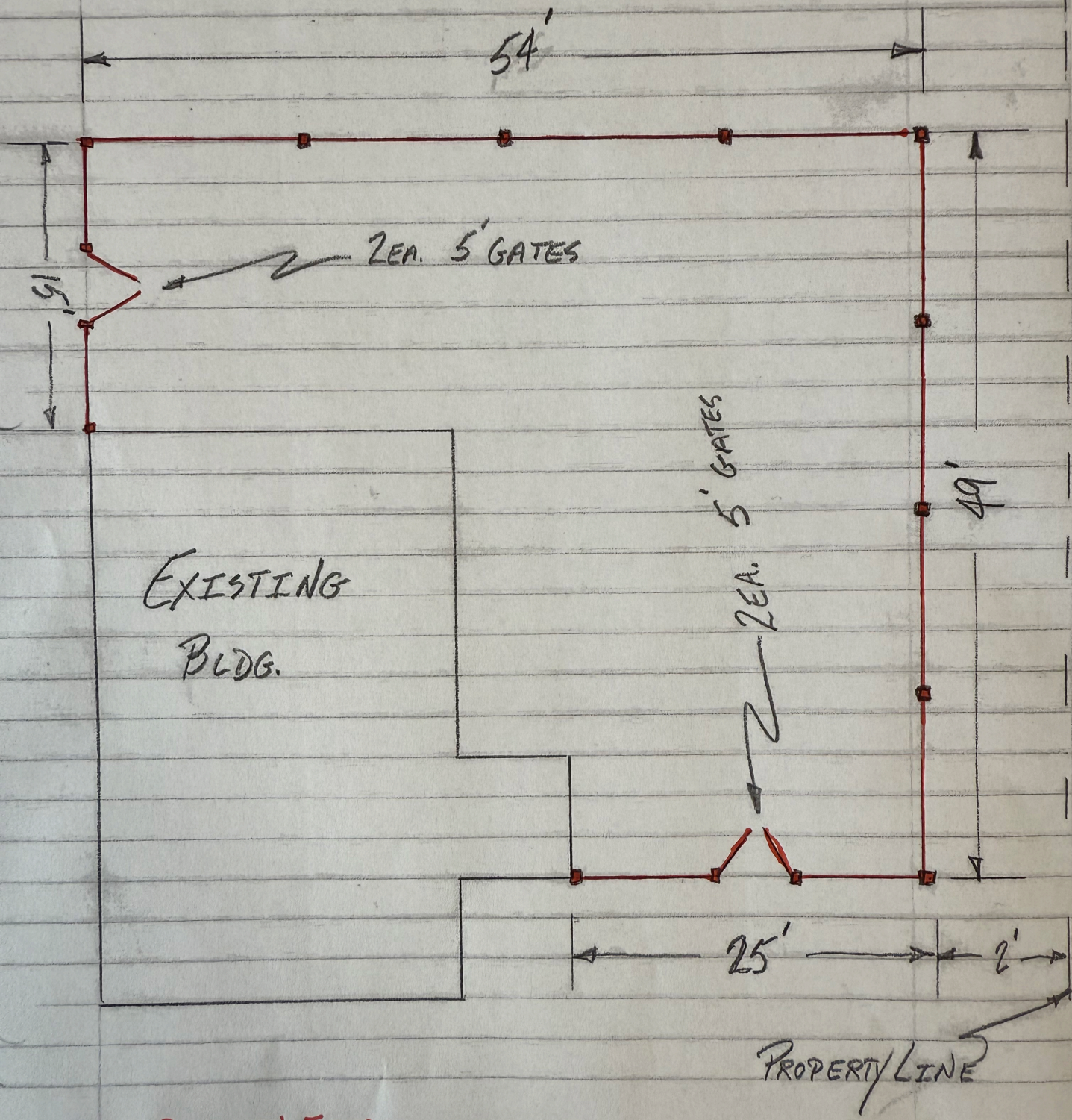

■ - Proposed Fence





THE OUTSIDE COMPANY™



Get outside and live your best life

We realize that inside each of us, there is an Outside Side™ — a side begging to get out there, to be outgoing, to break out of our same old inside routines and to outdo ourselves with our outdoor space. At Barrette Outdoor Living, we help your Outside Side run free with products that constantly beckon you out there. We know there is an Outside Side in everyone and we're firm believers that it's our best side because we're The Outside Company™.

Your vision

Your home is more than just a space. It's where you raise a family. It's where friends gather, and seasons come and go. It is a living, breathing picture of your life. With our diverse and flexible range of outdoor living solutions, Barrette Outdoor Living can help you bring any vision to life.

Our mission

Barrette Outdoor Living strives to be the best in product design and innovation, inspired by those who work with and for us to create superior outdoor living solutions both professionals and homeowners demand. At the core of our business is a place where integrity, ingenuity and skill meet.



Our promise to you

At Barrette Outdoor Living, we believe in making things right. We proudly stand behind our products by providing dedicated support, superior customer service and product warranties that feature some of the most comprehensive coverage in the industry. With decades of experience behind us, we are quite confident in the craftsmanship and quality of our products, but we also realize things happen. If that thing happens, we promise to make it right within the constraints of our warranties.



Leading the way



Crafting quality



Making it right



Being responsible

As a leading provider of outdoor living products to the residential market, Barrette Outdoor Living manufactures vinyl, aluminum, steel and composite fencing and railing; composite decking; and other complementary outdoor products. **To learn more, visit us at barretteoutdoorliving.com/warranty.**

VINYL FENCING

Barrette Outdoor Living offers vinyl fencing to meet your every need. With a variety of styles, sizes, colors and accessories — we are sure to have a fence for you. Extremely durable, Barrette Outdoor Living Vinyl Fencing will keep its looks for years to come.



StaySquare®

The StaySquare patented gate design with internal gate pockets, provides structural integrity that decreases sagging and bending over the years.



SolarGuard®

SolarGuard is a material composition that provides fade resistance* so that your outdoor living products will look good for years to come.

**Does not apply to white vinyl products*



StayStraight®

StayStraight is a unique material composition within vinyl fence rails that provides structural durability helping to decrease bending or sagging over time*.

**Does not apply to all products.*



6' H x 8' W • 1¾" x 7" RAIL (72" HIGH)

| DESCRIPTION | White | | Sand | | Clay | |
|---|----------|-----|----------|-----|----------|-----|
| | MFG# | QTY | MFG# | QTY | MFG# | QTY |
| 6' x 8' Solid Privacy Panel (72") | 73013794 | | 73014127 | | 73054022 | |
| 5" x 5" x 108" Line Post | 73013726 | | 73014133 | | 73054016 | |
| 5" x 5" x 108" Corner Post | 73013724 | | 73014131 | | 73054019 | |
| 5" x 5" x 108" End Post | 73013725 | | 73014132 | | 73054015 | |
| 5" x 5" x 80" Short Bottom Line Post | 73047060 | | 73047061 | | 73054018 | |
| 5" x 5" Pyramid Post Cap | 73003093 | | 73003769 | | 73054107 | |
| 5" x 5" Internal Post Cap | 73007092 | | 73007093 | | 73024884 | |
| 5" x 5" New England Post Cap | 73045003 | | 73045004 | | 73054108 | |
| 6' x 46" Solid Privacy Walk Gate (72") | 73014797 | | 73014799 | | 73054331 | |
| 6' x 58" Solid Privacy Drive Gate (72") | 73014798 | | 73014832 | | 73054332 | |

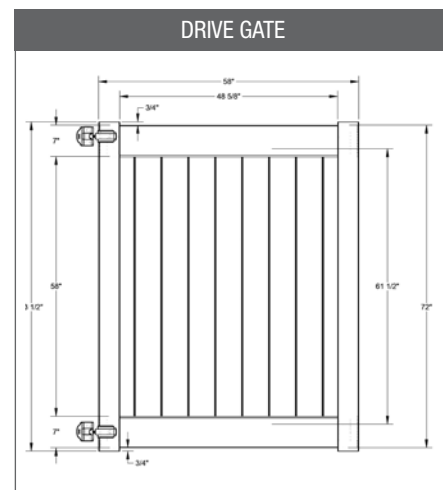
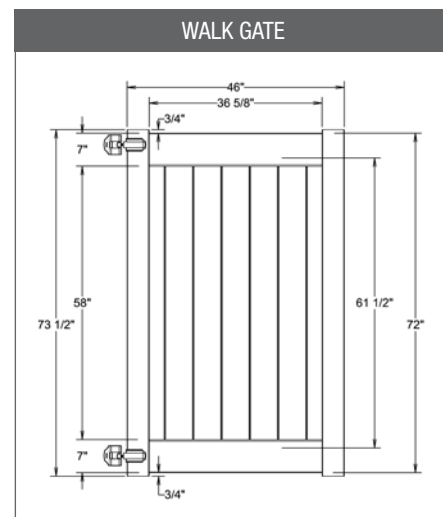
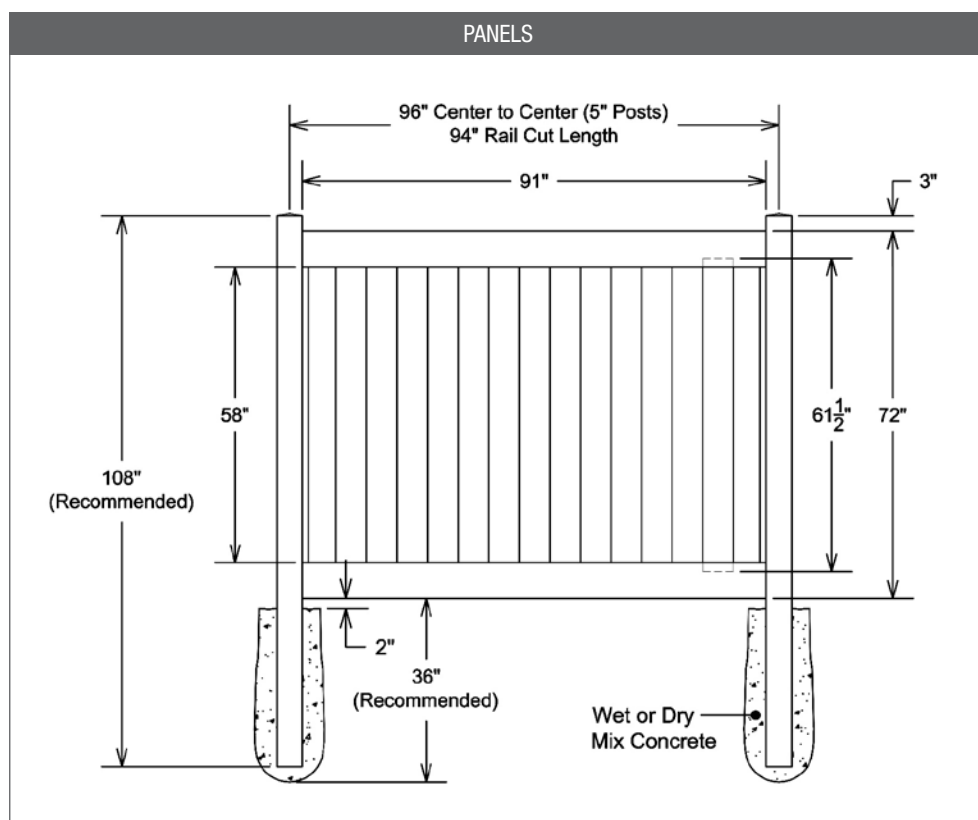

| FENCE PANEL COMPONENTS | |
|--|----------|
| DESCRIPTION | QTY |
| 1¾" x 7" x 94" Rails | 2 |
| ⅞" x 6' x 61½" Boards T&G | 15 |
| 57⅞" U-Channels | 2 |
| Also Available With White Rails and Sand Infill | MFG# |
| 6' x 8' White with Sand Infill Panel (72"), | 73024519 |
| 6' x 46" White with Sand Infill Walk Gate (72") | 73025002 |
| 6' x 58" White with Sand Infill Drive Gate (72") | 73025003 |

| HARDWARE | Black |
|--|----------|
| | SKU |
| Heavy-Duty Contemporary Wrap Hinge | 73014300 |
| Gate Handle | 73014320 |
| Gate Stop | 73014321 |
| 24" Heavy-Duty Drop Rod | 73014305 |
| Locking Gravity Latch 2-Sided Key Access | 73050187 |
| 5" x 5" x 106" Gate Post Insert | 73003463 |



Rail Profile



GATE HARDWARE

| DESCRIPTION | Black | | White | |
|--|----------|-----|----------|-----|
| | MFG# | QTY | MFG# | QTY |
| HINGES | | | | |
| Standard Wrap Hinge | 73028117 | | 73025512 | |
| Standard Wrap Hinge Pair (Stainless Steel) | 73014252 | | N/A | |
| Standard Butterfly Hinge | 73025681 | | 73025673 | |
| Heavy-Duty Butterfly Hinge | 73025668 | | 73025670 | |
| Heavy-Duty Contemporary Hinge | 73014300 | | 73025542 | |
| Heavy-Duty Contemporary Hinge Pair (Stainless Steel) | 73014250 | | 73025521 | |
| Heavy-Duty Modern Hinge | 73014301 | | 73025523 | |
| Standard Walk Gate Strap Hinge | 73023172 | | 73002181 | |
| Heavy-Duty Drive Gate Strap Hinge | 73014322 | | 73014323 | |
| Compact Butterfly Hinge — 1" or Higher Upright | 73024441 | | N/A | |
| Compact Butterfly Hinge — 1" Upright | 73025667 | | N/A | |
| Compact Polymer Butterfly Hinge | 73024445 | | N/A | |
| DROP RODS | | | | |
| Standard Drop Rod — 36" | 73014303 | | 73014304 | |
| Heavy-Duty Drop Rod — 24" | 73014305 | | 73014306 | |
| Heavy-Duty Drop Rod — 36" | 73024430 | | N/A | |
| Heavy-Duty Drop Rod — 48" | 73025499 | | 73025500 | |
| Heavy-Duty Drop Rod — 24" Stainless Steel | 73024431 | | N/A | |
| Heavy-Duty Drop Rod — 36" Stainless Steel | 73024432 | | N/A | |
| Heavy-Duty Drop Rod — 48" Stainless Steel | 73025503 | | 73025504 | |
| ACCESSORIES | | | | |
| Gate Handle | 73014320 | | N/A | |
| Gate Stop | 73014321 | | 73025508 | |
| EZ Grip Gate Handle | 73024421 | | 73004735 | |
| LATCHES | | | | |
| Gravity Latch | 73002252 | | 73025491 | |
| Gravity Latch Stainless Steel | 73014251 | | N/A | |
| Decorative Gravity Latch | 73050190 | | N/A | |
| Standard Gate Latch | 73023772 | | 73002183 | |
| Heavy-Duty Gate Latch (Stainless Steel) | 73041359 | | N/A | |
| Heavy-Duty Gate Latch | 73002218 | | 73002219 | |
| Locking Gravity Latch with 1-Sided Key Entry | 73050184 | | N/A | |
| Locking Gravity Latch with 2-Sided Key Entry/Push Button | 73050187 | | 73050188 | |
| Locking Pool Safety Latch | 73050191 | | N/A | |
| Compact Locking Pool Safety Latch | 73050192 | | N/A | |
| Flip Latch | 73024426 | | N/A | |
| Flip Latch (Stainless Steel) | 73024427 | | N/A | |
| Slide Bar Latch | 73024428 | | N/A | |
| Slide Bar Latch (Stainless Steel) | 73024429 | | N/A | |

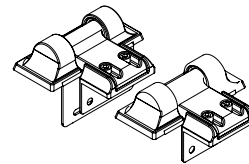

Standard Wrap Hinge

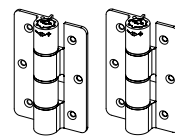

Standard Butterfly Hinge

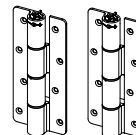

Heavy-Duty Butterfly Hinge

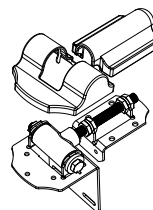

Heavy-Duty Contemporary Hinge Pair

NOTE: All gates come standard with wrap hinges included. Gate hardware and extras can be used for all series fences.

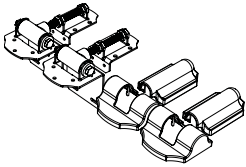

Heavy-Duty Modern
Gate Hinge Pair

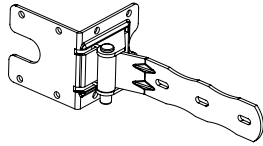

Standard Walk Gate
Strap Hinge

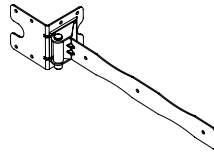

Heavy-Duty Drive
Gate Strap Hinge

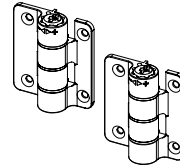

Compact Aluminum
Butterfly Hinge

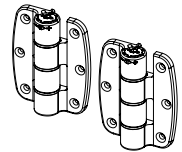

Compact Polymer
Butterfly Hinge

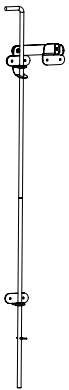

36" Standard
Drop Rod



24" Heavy-Duty
Drop Rod



36" Heavy-Duty
Drop Rod



48" Heavy-Duty
Drop Rod

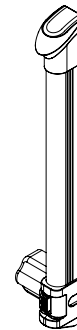

Compact Locking
Pool Safety Latch

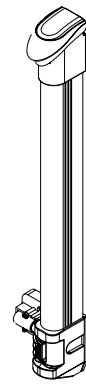

Locking Pool
Safety Latch

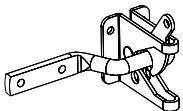

Gravity Latch

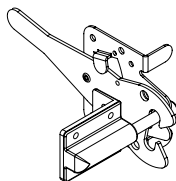

Heavy-Duty
Gate Latch

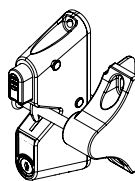

Locking Gravity
Latch with 1-sided
Key Entry

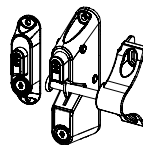

Locking Gravity
Latch with 2-sided Key
Entry/Push Button

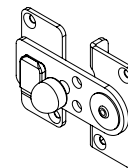

Flip Latch

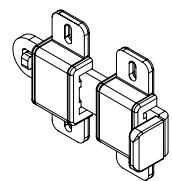

Slide Bar
Latch

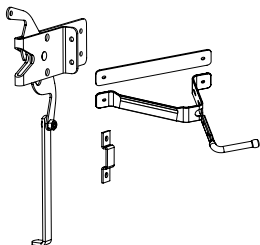

Standard
Gate Latch



Gate
Handle

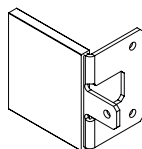

Gate
Stop

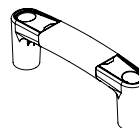

EZ Grip
Gate Handle

POSTS & INSERTS

POSTS

| DESCRIPTION | White | | Sand | | Clay | | Gray | |
|----------------------------------|----------|-----|----------|-----|----------|-----|----------|-----|
| | MFG# | QTY | MFG# | QTY | MFG# | QTY | MFG# | QTY |
| 4" x 4" x 72" Post (.100 wall) | 73014067 | | 73014066 | | 73054311 | | 73055415 | |
| 4" x 4" x 194½" Post (.100 wall) | 73051590 | | 73051581 | | 73051555 | | 73051578 | |

BLANK POSTS

| DESCRIPTION | White | | Sand | | Clay | | Gray | |
|---------------------------------------|----------|-----|----------|-----|----------|-----|----------|-----|
| | MFG# | QTY | MFG# | QTY | MFG# | QTY | MFG# | QTY |
| 5" x 5" x 60" Blank Post (.135 Wall) | 73051998 | | 73051992 | | 73054314 | | N/A | |
| 5" x 5" x 84" Blank Post (.135 Wall) | 73003872 | | 73051997 | | 73054974 | | 73055418 | |
| 5" x 5" x 96" Blank Post (.135 Wall) | 73003873 | | 73051668 | | 73051631 | | 73051656 | |
| 5" x 5" x 102" Blank Post (.135 Wall) | 73003694 | | 73014148 | | 73054315 | | 73055420 | |
| 5" x 5" x 108" Blank Post (.135 Wall) | 73003874 | | 73051659 | | 73051619 | | 73051646 | |

| DESCRIPTION | Cypress | | Driftwood | |
|---------------------------------------|----------|-----|-----------|-----|
| | MFG# | QTY | MFG# | QTY |
| 5" x 5" x 60" Blank Post (.135 Wall) | N/A | | N/A | |
| 5" x 5" x 84" Blank Post (.135 Wall) | N/A | | N/A | |
| 5" x 5" x 96" Blank Post (.135 Wall) | N/A | | N/A | |
| 5" x 5" x 102" Blank Post (.135 Wall) | N/A | | N/A | |
| 5" x 5" x 108" Blank Post (.135 Wall) | 73013858 | | 73042814 | |

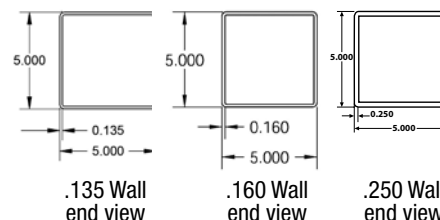

GATE POST INSERTS

| DESCRIPTION | Aluminum | |
|---------------------------------|----------|-----|
| | MFG# | QTY |
| 4" x 4" x 58" Gate Post Insert | 73014646 | |
| 5" x 5" x 58" Gate Post Insert | 73012352 | |
| 5" x 5" x 82" Gate Post Insert | 73003718 | |
| 5" x 5" x 94" Gate Post Insert | 73012353 | |
| 5" x 5" x 100" Gate Post Insert | 73040719 | |
| 5" x 5" x 106" Gate Post Insert | 73041348 | |

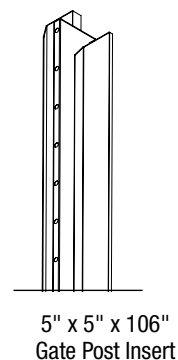
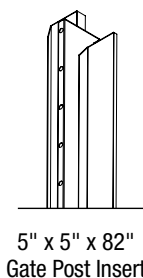

RAIL INSERTS

| DESCRIPTION | Aluminum | |
|----------------------------------|----------|-----|
| | MFG# | QTY |
| 2" x 3½" x 93" Rail Post Insert | 73003318 | |
| 2" x 6" x 93" Rail Post Insert | 73012643 | |
| 1½" x 5½" x 93" Rail Post Insert | 73003717 | |
| 1¾" x 5½" x 70" Rail Post Insert | 73003718 | |
| 1¾" x 5½" x 93" Rail Post Insert | 73007058 | |

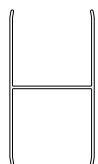

2" x 3½" x 93"
Rail Post Insert

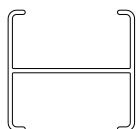

2" x 6" x 93"
Rail Post Insert

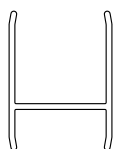

1½" x 5½" x 93"
Rail Post Insert

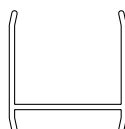

1¾" x 5½" x 70"
Rail Post Insert

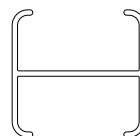

1¾" x 5½" x 93"
Rail Post Insert

| DESCRIPTION | White | | Sand | | Clay | | Gray | |
|-------------------------------|----------|-----|----------|-----|----------|-----|----------|-----|
| | MFG# | QTY | MFG# | QTY | MFG# | QTY | MFG# | QTY |
| 5" x 5" Pyramid Post Cap | 73003093 | | 73003769 | | 73054107 | | 73053068 | |
| 5" x 5" Internal Post Cap | 73007092 | | 73007093 | | 73024884 | | N/A | |
| 5" x 5" New England Post Cap | 73045003 | | 73045004 | | 73054108 | | 73053093 | |
| 5" x 5" Gothic Post Cap | 73003094 | | 73003760 | | 73024885 | | N/A | |
| 5" x 5" Ball Post Cap | 73007099 | | 73007100 | | 73040213 | | N/A | |
| 5" x 5" Federation Post Cap | 73003721 | | 73003762 | | 73040215 | | N/A | |
| 5" x 5" Contemporary Post Cap | 73013124 | | 73013807 | | 73024887 | | N/A | |
| 5" x 5" Solar Post Cap | 73013110 | | 73025652 | | N/A | | N/A | |
| 6" x 6" Pyramid Post Cap | 73054353 | | 73054354 | | N/A | | N/A | |
| 6" x 6" New England Post Cap | 73054355 | | 73054356 | | N/A | | N/A | |

| DESCRIPTION | Cypress | | Driftwood | |
|-------------------------------|----------|-----|-----------|-----|
| | MFG# | QTY | MFG# | QTY |
| 5" x 5" Pyramid Post Cap | 73013829 | | 73042811 | |
| 5" x 5" Internal Post Cap | 73013827 | | 73042812 | |
| 5" x 5" New England Post Cap | 73045007 | | 73045008 | |
| 5" x 5" Gothic Post Cap | N/A | | N/A | |
| 5" x 5" Ball Post Cap | N/A | | N/A | |
| 5" x 5" Federation Post Cap | N/A | | N/A | |
| 5" x 5" Contemporary Post Cap | 73013836 | | N/A | |
| 5" x 5" Solar Post Cap | N/A | | N/A | |
| 6" x 6" Pyramid Post Cap | N/A | | N/A | |
| 6" x 6" New England Post Cap | N/A | | N/A | |

| DESCRIPTION | Coastal Cedar | | Weathered Aspen | | Mesquite | |
|-------------------------------|---------------|-----|-----------------|-----|----------|-----|
| | MFG# | QTY | MFG# | QTY | MFG# | QTY |
| 5" x 5" Pyramid Post Cap | 73053064 | | 73053069 | | 73053065 | |
| 5" x 5" Internal Post Cap | N/A | | N/A | | N/A | |
| 5" x 5" New England Post Cap | 73053088 | | 73053094 | | 73053091 | |
| 5" x 5" Gothic Post Cap | N/A | | N/A | | N/A | |
| 5" x 5" Ball Post Cap | N/A | | N/A | | N/A | |
| 5" x 5" Federation Post Cap | N/A | | N/A | | N/A | |
| 5" x 5" Contemporary Post Cap | N/A | | N/A | | N/A | |
| 5" x 5" Solar Post Cap | N/A | | N/A | | N/A | |
| 6" x 6" Pyramid Post Cap | N/A | | N/A | | N/A | |
| 6" x 6" New England Post Cap | N/A | | N/A | | N/A | |

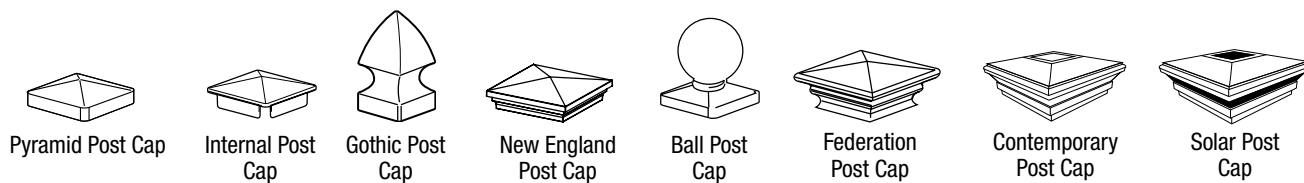

DROP RODS • HINGES • HANDLES

| DESCRIPTION | Black | | White | |
|--|-------|----------|-------|----------|
| | QTY | MFG# | QTY | MFG# |
| HINGES | | | | |
| Standard Wrap Hinge | | 73028117 | | 73025512 |
| Standard Wrap Hinge Pair (Stainless Steel) | | 73014252 | | N/A |
| Standard Butterfly Hinge | | 73025681 | | 73025673 |
| Heavy-Duty Butterfly Hinge | | 73025668 | | 73025670 |
| Heavy-Duty Contemporary Hinge | | 73014300 | | 73025542 |
| Heavy-Duty Contemporary Hinge Pair (Stainless Steel) | | 73014250 | | 73025521 |
| Heavy-Duty Modern Hinge | | 73014301 | | 73025523 |
| Standard Walk Gate Strap Hinge | | 73023172 | | 73002181 |
| Heavy-Duty Drive Gate Strap Hinge | | 73014322 | | 73014323 |
| Compact Butterfly Hinge — 1" or Higher Upright | | 73024441 | | N/A |
| Compact Butterfly Hinge — 1" Upright | | 73025667 | | N/A |
| Compact Polymer Butterfly Hinge | | 73024445 | | N/A |
| DROP RODS | | | | |
| Standard Drop Rod — 36" | | 73014303 | | 73014304 |
| Heavy-Duty Drop Rod — 24" | | 73014305 | | 73014306 |
| Heavy-Duty Drop Rod — 36" | | 73024430 | | N/A |
| Heavy-Duty Drop Rod — 48" | | 73025499 | | 73025500 |
| Heavy-Duty Drop Rod — 24" Stainless Steel | | 73024431 | | N/A |
| Heavy-Duty Drop Rod — 36" Stainless Steel | | 73024432 | | N/A |
| Heavy-Duty Drop Rod — 48" Stainless Steel | | 73025503 | | 73025504 |
| ACCESSORIES | | | | |
| Gate Handle | | 73014320 | | N/A |
| Gate Stop | | 73014321 | | 73025508 |
| EZ Grip Gate Handle | | 73024421 | | 73004735 |
| LATCHES | | | | |
| Gravity Latch | | 73002252 | | 73025491 |
| Gravity Latch Stainless Steel | | 73014251 | | N/A |
| Decorative Gravity Latch | | 73050190 | | N/A |
| Standard Gate Latch | | 73023772 | | 73002183 |
| Heavy-Duty Gate Latch (Stainless Steel) | | 73041359 | | N/A |
| Heavy-Duty Gate Latch | | 73002218 | | 73002219 |
| Locking Gravity Latch with 1-Sided Key Entry | | 73050184 | | N/A |
| Locking Gravity Latch with 2-Sided Key Entry/Push Button | | 73050187 | | 73050188 |
| Locking Pool Safety Latch | | 73050191 | | N/A |
| Compact Locking Pool Safety Latch | | 73050192 | | N/A |
| Flip Latch | | 73024426 | | N/A |
| Flip Latch (Stainless Steel) | | 73024427 | | N/A |
| Slide Bar Latch | | 73024428 | | N/A |
| Slide Bar Latch (Stainless Steel) | | 73024429 | | N/A |

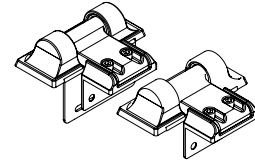

Standard Wrap Hinge

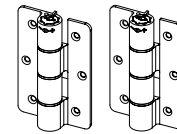

Standard Butterfly Hinge

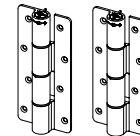

Heavy-Duty Butterfly Hinge

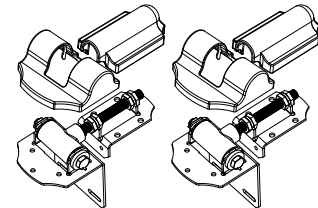

Heavy-Duty Contemporary Hinge Pair

NOTE: All gates come standard with wrap hinges included. Gate hardware and extras can be used for all series fences.

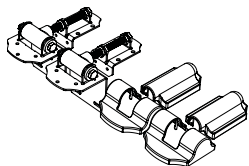

Heavy-Duty Modern
Gate Hinge Pair

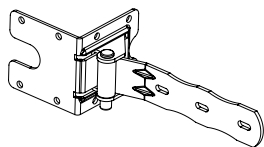

Standard Walk Gate
Strap Hinge

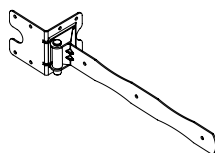

Heavy-Duty Drive
Gate Strap Hinge

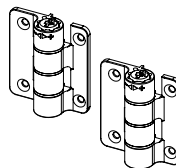

Compact Aluminum
Butterfly Hinge

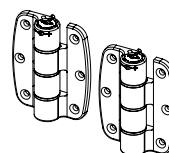

Compact Polymer
Butterfly Hinge

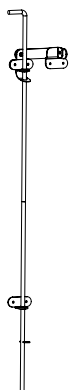

36" Standard
Drop Rod



24" Heavy-Duty
Drop Rod



36" Heavy-Duty
Drop Rod



48" Heavy-Duty
Drop Rod

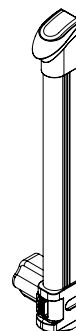

Compact Locking
Pool Safety Latch

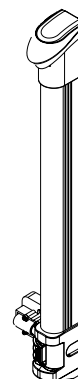

Locking Pool
Safety Latch

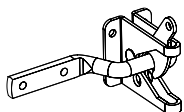

Gravity Latch

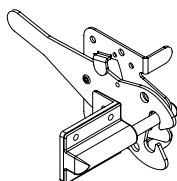

Heavy-Duty
Gate Latch

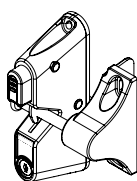

Locking Gravity
Latch with 1-sided
Key Entry

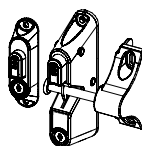

Locking Gravity
Latch with 2-sided Key
Entry/Push Button

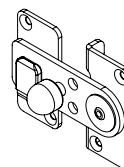

Flip Latch

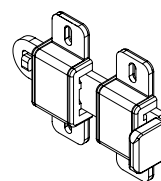

Slide Bar
Latch

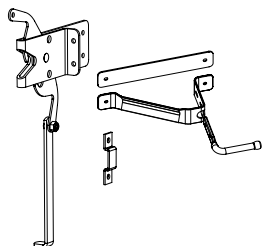

Standard
Gate Latch



Gate
Handle

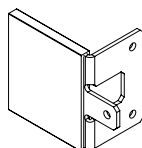

Gate
Stop

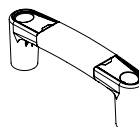

EZ Grip
Gate Handle

VINYL FENCE — TRANSFERABLE LIMITED LIFETIME WARRANTY

WHO IS COVERED:

- The limited lifetime warranty covers single-family residential properties only. This limited warranty extends to the original purchaser and one (1) individual transferee as specified herein.
- A thirty (30) year limited warranty covers any other type of building or property including those owned by corporations, governmental agencies, partnerships, trusts, religious organizations, schools, condominiums, homeowner associations, cooperative housing arrangements and apartment buildings. The warranty period will be thirty (30) years following the original date of Product purchase.

WHAT IS COVERED: Barrette Outdoor Living warrants that its vinyl fencing products ("Product") will be free from defects in material and workmanship for the warranty period. This limited warranty is valid beginning on the date of Product purchase.

Barrette Outdoor Living warrants the Product against peeling, flaking, rotting, chipping, cracking, blistering, or abnormal discoloration/fading* under normal atmosphere and weather conditions.

**After prolonged exposure to outdoor environments, all products will experience some gradual fading over time and is considered normal (up to a standard variation determined by Delta E color measurement, not to exceed Delta 5). Degrees of fading vary depending on geographical location, air pollution, exposure and other factors.*

WHAT THIS WARRANTY DOES NOT COVER: This limited warranty will not cover a change in color due to a buildup of accumulation of stains, dirt, mold, mildew or any other deficiency caused by lack of any maintenance by the owner. This limited warranty does not cover damage resulting from: misuse, abuse, improper storage or handling, improper installation, other vinyl products and accessories not manufactured by Barrette Outdoor Living, or manufactured for specific use in vinyl fence applications; impact of foreign objects, fire, earthquake, flood, lightning, hail, hurricane, tornado or other casualty or act of God; movements, distortion, collapse or settling of ground or structure on which the fence is installed; distortion or melting due to external heat sources; fence that has been painted, varnished, or coated over manufacturer's finish. This limited warranty does not cover costs of removal or disposal of product, or reinstallation of replacement product.

WHAT BARRETTE OUTDOOR LIVING DOES TO REMEDY THE PROBLEM: Should your Barrette Outdoor Living product prove defective under warranty, visit the website or call the phone number listed below. Barrette Outdoor Living requires written notice or phone call within thirty (30) days of discovering the defect and you must show original proof of purchase receipt. You will be required to provide to Barrette Outdoor Living pictures and/or samples of the defective Product. If it is determined by Barrette Outdoor Living, in its sole discretion, the Product has a manufacturer defect in material or workmanship, Barrette Outdoor Living will replace or repair with new or equivalent products; labor is not included in warranty. If the Product is discontinued, Barrette Outdoor Living will repair or replace the Product with a product in comparable quality or price range.

Barrette Outdoor Living reserves the right to discontinue or modify any of its products, including the color of its products

without notice to the purchaser. Barrette Outdoor Living does not warrant that any replacement material will match or be identical to the original Product as replacement products may vary in color or gloss in comparison to the original Product as a result of normal weathering.

TRANSFeree COVERAGE: Limited lifetime warranty coverage will be extended to one (1) transferee with the following limitations: the one (1) transfer shall only be from residential homeowner (original Product purchaser) to a second homeowner. After a transfer, the warranty is valid thirty (30) years from the date of the original purchase.

The thirty (30) year limited warranty for commercial installations cannot be transferred.

REGISTRATION: To activate this warranty, fill out the product registration form on the website listed below, or mail the completed registration card to Barrette Outdoor Living. Registration of Product must be within thirty (30) days from date of Product purchase for warranty to be valid.

Except as expressly set forth in this warranty, Barrette Outdoor Living HEREBY EXPRESSLY DISCLAIMS ANY REPRESENTATION, WARRANTY, PROMISE, GUARANTEE OR OTHER ASSURANCE OF ANY KIND, EXPRESS OR IMPLIED, ORAL OR WRITTEN, STATUTORY OR OTHERWISE, RELATING TO THE PRODUCT. STATE LAW WILL DETERMINE THE PERIOD OF TIME FOLLOWING THE SALE THAT YOU MAY SEEK A REMEDY UNDER THE IMPLIED WARRANTY OF MERCHANTABILITY OR FITNESS FOR A PARTICULAR PURPOSE.

NO DISTRIBUTOR, DEALER OR OTHER PERSON IS AUTHORIZED BY BARRETTE OUTDOOR LIVING TO CHANGE THIS WARRANTY OR TO MAKE ANY ADDITIONAL REPRESENTATION, WARRANTY, PROMISE, GUARANTEE OR OTHER ASSURANCE ON BEHALF OF BARRETTE OUTDOOR LIVING RELATING TO THE PRODUCT. THIS WARRANTY GIVES YOU SPECIFIC LEGAL RIGHTS, AND YOU MAY ALSO HAVE OTHER RIGHTS WHICH VARY STATE TO STATE.

LIMITATION OF LIABILITY: THE REMEDIES DESCRIBED ABOVE ARE YOUR SOLE AND EXCLUSIVE REMEDIES AND BARRETTE OUTDOOR LIVING'S ENTIRE LIABILITY FOR ANY BREACH OF THIS LIMITED WARRANTY. BARRETTE OUTDOOR LIVING'S LIABILITY SHALL UNDER NO CIRCUMSTANCES EXCEED THE ACTUAL AMOUNT PAID BY YOU FOR THE DEFECTIVE PRODUCT, NOR SHALL BARRETTE OUTDOOR LIVING BE LIABLE FOR ANY CONSEQUENTIAL, INCIDENTAL, SPECIAL OR PUNITIVE DAMAGES OR LOSSES, WHETHER DIRECT OR INDIRECT. SOME STATES DO NOT ALLOW THE EXCLUSION OR LIMITATION OF INCIDENTAL OR CONSEQUENTIAL DAMAGES, SO THE ABOVE LIMITATION OR EXCLUSION MAY NOT APPLY TO YOU.

THIS WARRANTY IS VALID ONLY IN THE UNITED STATES AND CANADA.

This warranty is effective for products purchased after January 1, 2021.

This warranty can also be found online at:

www.BarretteOutdoorLiving.com

In case of a warranty claim, call 1-800-336-2383

HARDWARE — LIMITED LIFETIME WARRANTY

WHO IS COVERED: The limited lifetime warranty covers residential and commercial properties. This limited warranty extends to the original purchaser and one (1) transferee as specified herein.

WHAT IS COVERED: Barrette Outdoor Living warrants that its hardware products ("Product") will be free from defects in design, material and workmanship for the warranty period. This limited warranty is valid beginning on the date of Product purchase.

WHAT THIS WARRANTY DOES NOT COVER: This limited warranty will not cover normal wear and tear; failure to follow any procedures specified or recommended by Barrette Outdoor Living for the installation, operation and maintenance of the Product; any act or circumstance beyond Barrette Outdoor Living's control including tampering, unauthorized repairs, misuse, abnormal use, abuse, accident, damage after delivery to the consumer, damage caused by events beyond human control including but not limited to damage caused by animals or natural events, surface tarnishing and/or damage to components caused by corrosion or other environmental conditions; any defect of or in any framework or material supporting the Product; faulty workmanship of any person other than Barrette Outdoor Living, including the installer of the Product. This limited warranty does not cover costs of removal or disposal of product, or reinstallation of replacement product. Any service provided outside the scope of this limited warranty shall be at Barrette Outdoor Living's standard rate and terms then in effect.

WHAT BARRETTE OUTDOOR LIVING DOES TO REMEDY THE PROBLEM: Should your Barrette Outdoor Living Product prove defective under warranty, visit the website or call the phone number listed below. Barrette Outdoor Living requires written notice or phone call within thirty (30) days of discovering the defect and you must show original proof of purchase receipt. You will be required to provide to Barrette Outdoor Living pictures and/or samples of the defective Product. If it is determined by Barrette Outdoor Living, in its sole discretion, the Product has a manufacturer defect in material or workmanship, Barrette Outdoor Living will replace or repair with new or equivalent products; labor is not included in warranty. If the Product is discontinued, Barrette Outdoor Living will repair or replace the Product with a product in comparable quality or price range.

Barrette Outdoor Living reserves the right to discontinue or modify any of its products, including the color of its products without notice to the purchaser. Barrette Outdoor Living does not warrant that any replacement material will match or be identical to the original Product as replacement products may vary in color or gloss in comparison to the original Product as a result of normal weathering.

Except as expressly set forth in this warranty, Barrette Outdoor Living HEREBY EXPRESSLY DISCLAIMS ANY REPRESENTATION, WARRANTY, PROMISE, GUARANTEE OR OTHER ASSURANCE OF ANY KIND, EXPRESS OR IMPLIED, ORAL OR WRITTEN, STATUTORY OR OTHERWISE, RELATING TO THE PRODUCT. STATE LAW WILL DETERMINE THE PERIOD OF TIME FOLLOWING THE SALE THAT YOU MAY SEEK A REMEDY UNDER THE IMPLIED WARRANTY OF MERCHANTABILITY OR FITNESS FOR A PARTICULAR PURPOSE.

NO DISTRIBUTOR, DEALER OR OTHER PERSON IS AUTHORIZED BY BARRETTE OUTDOOR LIVING TO CHANGE THIS WARRANTY OR TO MAKE ANY ADDITIONAL REPRESENTATION, WARRANTY, PROMISE, GUARANTEE OR OTHER ASSURANCE ON BEHALF OF BARRETTE OUTDOOR LIVING RELATING TO THE PRODUCT. THIS WARRANTY GIVES YOU SPECIFIC LEGAL RIGHTS, AND YOU MAY ALSO HAVE OTHER RIGHTS WHICH VARY STATE TO STATE.

LIMITATION OF LIABILITY: THE REMEDIES DESCRIBED ABOVE ARE YOUR SOLE AND EXCLUSIVE REMEDIES AND Barrette Outdoor Living'S ENTIRE LIABILITY FOR ANY BREACH OF THIS LIMITED WARRANTY. BARRETTE OUTDOOR LIVING'S LIABILITY SHALL UNDER NO CIRCUMSTANCES EXCEED THE ACTUAL AMOUNT PAID BY YOU FOR THE DEFECTIVE PRODUCT, NOR SHALL BARRETTE OUTDOOR LIVING BE LIABLE FOR ANY CONSEQUENTIAL, INCIDENTAL, SPECIAL OR PUNITIVE DAMAGES OR LOSSES, WHETHER DIRECT OR INDIRECT. SOME STATES DO NOT ALLOW THE EXCLUSION OR LIMITATION OF INCIDENTAL OR CONSEQUENTIAL DAMAGES, SO THE ABOVE LIMITATION OR EXCLUSION MAY NOT APPLY TO YOU.

THIS WARRANTY IS VALID ONLY IN THE UNITED STATES AND CANADA.

This warranty is effective for products purchased after January 1, 2021.

This warranty can also be found online at:

www.BarretteOutdoorLiving.com

In case of a warranty claim, call 1-800-336-2383

VINYL FENCE WIND CODE

Stamped engineering drawings can be obtained through your Barrette Outdoor Living representative.



POOL CODE APPROVED

Certain styles of Barrette Outdoor Living vinyl fences are pool code approved at the national level. Please note that codes not only vary by state, but also by locality. Our pool code products may not meet your local pool code requirements. Be sure to check the codes in your area before ordering.



National Fence Specifications

Panel Specifications:

- Fence panel must be at least 48" tall
- Distance from the top of the bottom rail to the top of the next highest rail must be at least 45"
- Spacing between pickets must be less than 4"
- Space from the bottom of the bottom rail to the ground must be less than 4"

Gate Specifications:

- Must have self-closing hinges
- Must have self-closing latches
- Need to open out (away from pool area)
- Opening mechanism of the latch must be at least 54" above the ground
- Must not use a cross brace on gates

INSTALLATION

Please see full installation instructions available in product packaging.

CARE AND MAINTENANCE

Vinyl Fence Cleaning

- Most dirt can be washed off with a mild soap and water solution.
- Heavier stains can be cleaned with any non-toxic household cleaner.

How Do I Clean My Vinyl Fence?

- On occasion you may want to spray your fence with a garden hose. This will remove grass clippings, dirt and fertilizer chemicals and keep it looking as new as possible.
- To remove minor stains use a non-abrasive liquid cleaner.
- For removal of major stains follow the manufacturer's directions for one of the following cleaning agents:
 - Simple Green® All Purpose Cleaner
 - Mr. Clean® Magic Eraser
 - Mineral Spirits
 - Trichloroethylene
 - CLR (Calcium, Lime and Rust) Cleaner
 - Vinegar

**Note: Goof Off® and Goo Gone® are not recommended to remove stains.*

Maintenance Tips

To maximize the life of your fence address these areas:

- Adjust the gate every Spring — As a reminder, gate adjustments and leveling are normal care and maintenance items that the homeowner is responsible for.
- Oil the gate hinges and tighten the screws once a year.
- Do not let the gate swing in the wind. Keep it secured.
- Deter children from swinging on the gate.
- Re-tamp and realign loose posts.

