

EASEMENT

That part of Lot 14 of Block 1 in Hamilton's Addition, a recorded plat in the City of Racine, Racine County, Wisconsin that is part of the Southeast 1/4 of Section 17, Township 3 North, Range 23 East described as follows:

Commence at the Northwest corner of said Lot 14; run thence South 2 degrees 29 minutes 55 seconds East along the west line of said Lot, a distance of 295.73 feet to the Point of Beginning of this description run thence South 87 degree 37 minutes 14 seconds East, a distance of 9.00 feet; thence South 2 degrees 22 minutes 46 seconds West, a distance of 105.00 feet; thence North 87 degree 37 minutes 14 seconds West, a distance of 9.00 feet; thence North 2 degrees 22 minutes 46 seconds East, a distance of 105.00 feet and the Point of Beginning; said tract containing 945 sq. ft. more-or-less.

northwest corner of Lot 14, Block 1, Hamilton's Addition

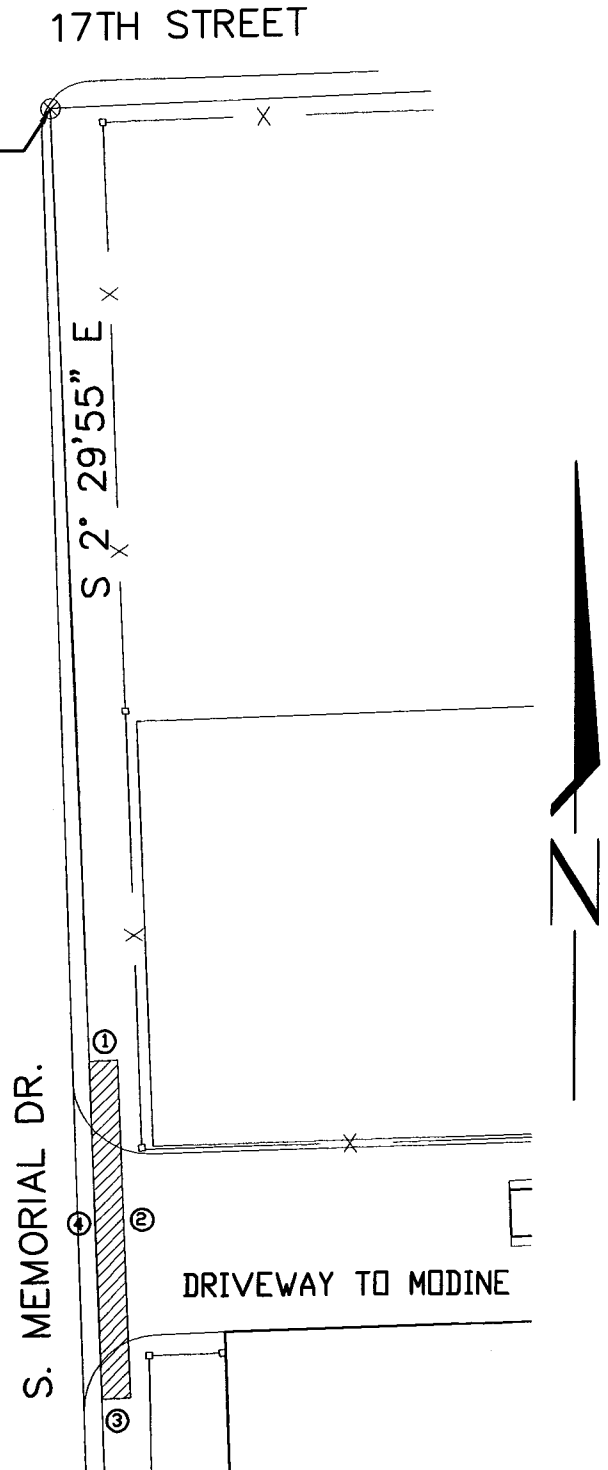

COURSES

No.	DIRECTION	DISTANCE
1	S 87° 37' 14" E	9.00'
2	S 2° 22' 46" W	105.00'
3	N 87° 37' 14" W	9.00'
4	N 2° 22' 46" E	105.00'

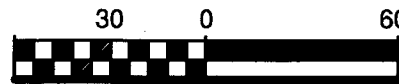

CITY ENGINEER'S OFFICE RACINE, WISCONSIN

1/4_A	1/4_B	Revisions : REV2
DOCUMENT NUMBER : D	1/4_C	Revisions : REV1
APPROVED : EA DATE : DA	DRAWN : TJJ DATE : 10/29/07	Scale : 1'=60'
RESOLUTION NO : RES_NO	_Shared\Engineering\Easements\U-05\South Side Ind Site\Modine Easement\Easement.DWG	
Parcel Identification Number : 168 48000 PIN	CODE : CP	FILE NUMBER : FN