

From: Robert P Jorgensen [mpo_medic@yahoo.com]
Sent: Wednesday, September 08, 2010 3:56 PM
To: McCarthy, Terry; Wisneski, Aron
Subject: Blaine Ave Proposal

Dear Sirs,

Attached are documents to support and show the proposal I would like to see made to Blaine Ave between Kinzie Ave and Osborne Blvd. The idea is to make parking easier for residents on both sides of the street by allowing alternate night parking next to the boulevard. Cost would be painting of white parking lane and possible signs which state alternate street parking. It would also make snow plowing and sweeping the same as the rest of the areas in the city. I knocked on all of the houses one weekend and this is the response I got. There was one who did not like the idea as she was afraid it might cause accidents.

I have it figured out that curb to curb is 29.5 ft. If there are 2 parking lanes 9 ft, that leaves 11.5 ft of driving lane down the center at all times. At night there would be 20.5 ft only shifting dependent on the calendar day. Parking could be done during daylight hours on both sides of the street.

This would allow the resident's more parking closer to their home, a big plus in the winter.

--

Robert P Jorgensen
262-637-0911

I the undersigned, do hereby consent and agree with the proposed change to Blaine Ave
alternate street parking between Kinzie Ave and Osborne Blvd.

	Name	Address	Phone Number	Signature
1	James Hutton	1228 Blaine Ave	456-7303	James Hutton
2	George Spinoza	119 Blaine Ave	633-8229	George Spinoza
3	Demestha Hunter	704 Blaine Ave	630-0854	Demestha Hunter
4	Judi Tremmel	712 Blaine Ave	634-5410	Judi Tremmel
5	Chris Pycus	722 Blaine Ave	551-2266	Chris Pycus
6	Janet Winter	726 Blaine Avenue	638-2817	Janet Winter
7	David Mondollet	729 Blaine Ave	634-3201	David Mondollet
8	Maryanne Kuiper	738 Blaine Ave	633-4225	Maryanne Kuiper
9	Dan & Neha	804 Blaine Ave	412-1543	Dan & Neha
10	Kerry Townsend	800 Blaine Ave	638-1249	Kerry Townsend
11	Koscey Stablik	812 Blaine Ave	619-0118	Koscey Stablik
12	BRANDED PAPER	816 Blaine Ave	865-1476	BRANDED PAPER
13	Allen Fillion	832 Blaine Ave	909-1689	Allen Fillion
14	Diana Harner	832 Blaine Ave	909-1673	Diana Harner
15	Edw Jares	833 Blaine Ave	634-8222	Edw Jares
16	Angie Ambler	823 Blaine Ave	632-4165	Angie Ambler
17	BILL McFARLANE	811 Blaine Ave	637-0442	BILL McFARLANE
18	Kate Stenew	725 Blaine Ave	939-9034	Kate Stenew
19	Wyle & Koller	728 Blaine Ave	939-9171	Wyle & Koller
20	Robert P Jorgensen	733 Blaine Ave	637-0911	Robert P Jorgensen
21				
22				
23				
24				
25				
26				
27				
28				
29				
30				
31				
32				
33				
34				
35				
36				
37				
38				
39				

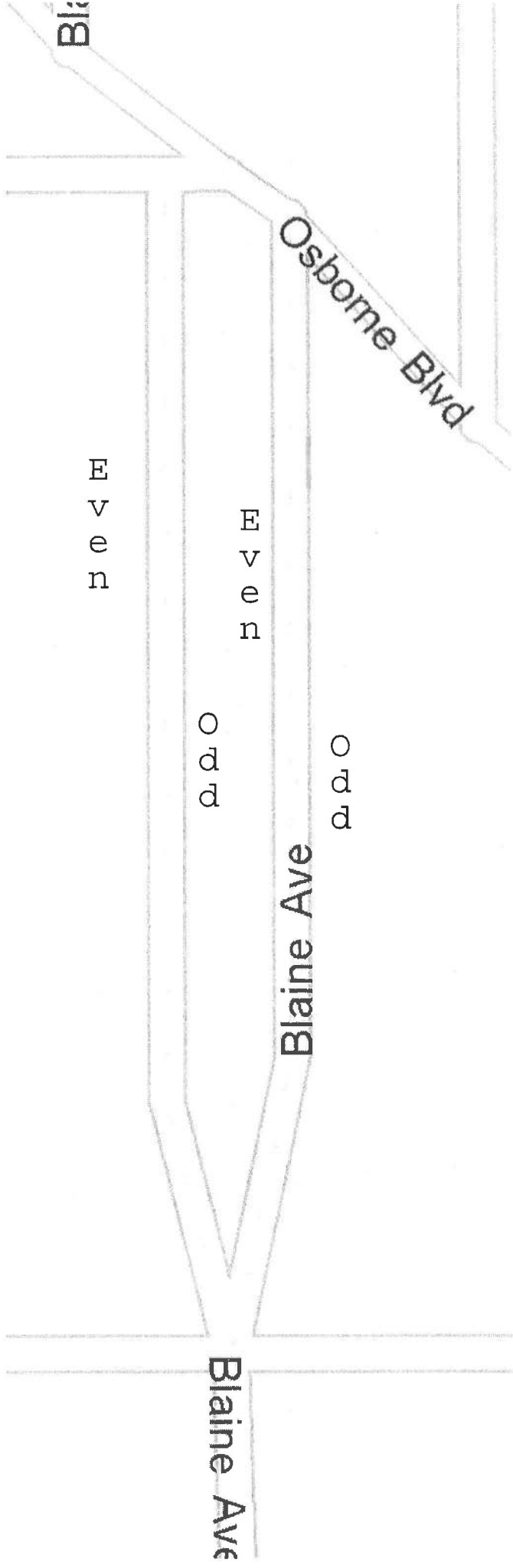

Blaine Ave

Osborne Blvd

Even

Even

Odd

Odd

Blaine Ave

Blaine Ave

