

411 Main Street Racine WI

Proposed Improvements

Scope of project:

Open up concrete floor to access plumbing and replace after installation. Frame ADA restroom and 100 ft.+ of exterior wall. Install new ADA plumbing, update wiring, install new HVAC drop new acoustical ceiling and finish new floor

Cost as follows:

Floor Demo and repair	PCR	\$ 1860.00	NAR	\$ 2200.00
Plumbing	Lepow	\$ 4260.00	NAR	\$ 6450.00
Flooring	Carpets Plus	\$8935.00	Carpets Plus	\$15325.00
Electric	Kreuser	\$ 5175.00	Shaffer	\$ 8975.00
Drywall	L&B	\$ 2540.00	Phoenix	\$ 3100.00
Frame and Trim	Phoenix	\$ 5350.00	NAR	\$5400.00
Crop Ceiling	Strictly	\$4500.00	Postorino	\$6580.00
<u>HVAC</u>	<u>K&R</u>	<u>\$ 8750.00</u>	<u>Kenosha</u>	<u>12325.00</u>

Total = \$41,370.00	\$60,355.00
<u> x 50%</u>	<u> x 50%</u>
\$20,685.00	\$30,177.50

Building Age: 169 Years Old

2000 sq. ft. x \$10.00 per sq. ft. = \$20,000.00

Maximum Grant = \$20,000.00

COMMERCIAL "WHITE BOX" GRANT APPLICATION

Applicant/Project Contact Information

Name: MICHAEL BAIN
MT ROYAL PROPERTY MANAGEMENT
Address: 524-MAIN ST RACINE WI 53403
Phone: 262 770-4482

Business or Leaseholder Information

Name of business: UNKNOWN / WHITE BOX

Business Owner's/Leaseholder's Name:

Address: 411-MAIN ST

Phone:

Property Owner Information

Name: 401-WISCONSIN LLC - MICHAEL BAIN AGENT

Address: 212-WEST FOOTHILL BLVD., MARIETTA GA 30066

Years Owned Building: MONTHS

Age of Building: 100+

Area of First Floor (Square Feet): 2030

Proposed Improvements (describe in detail)

SEE ATTACH

PCR SERVICES LLC
 583 SHERIDAN ROAD
 RACINE , WI 53403

Estimate

Date	Estimate #
2/15/2019	343

Name / Address
MIKE BAIN 4619- PLEASANT TRAIL MT PLEASANT , WI 53403

Project

Description	Total
MOUNTAIN ROYAL PROPERTY MANAGEMENT LLC	
WORK PERFORMED @ 107- 4TH STREET LLC	
1. SAWCUT CONCRETE, REMOVE AND DISPOSE OF. INSTALL 4" THICK CONCRETE FOR APPROXIMATELY 164 SQ. FT	3,280.00
2. SAWCUT CONCRETE , REMOVE AND DISPOSE OF. INSTALL 4" THICK CONCRETE FOR 3' X 20' AREA	1,860.00
OPTION 2 SAWCUT CONCRETE , REMOVE AND DISPOSE OF , INSTALL 4" THICK CONCRETE FOR 3' X 9' AREA	1,340.00
WORK PERFORMED @ 411 MAIN STREET	
PLUMBING DEMO + REPAIR	
Total	\$6,480.00

New Again Renovation, Inc.

**4619 Pleasant Trail Drive
Mount Pleasant, Wisconsin 53403
262-909-7150**

Proposal

RE:411 Main Street

4/10/2019

**Mt.Royal Property Management
524 Main Street
Racine WI 53403**

Saw cut 60 Square Feet area to open area for plumbing, re-pour at 4" Thick. We will dispose concrete .

\$2200.00

New Again Renovations

**PLUMBING
DEMO + REPAIR**

LEPow Plumbing
262-664-1755

Proposal

PROPOSAL NO.
SHEET NO.
DATE <u>2-14-2019</u>

OPTION #2 - White Box

PROPOSAL SUBMITTED TO:

WORK TO BE PERFORMED AT:

NAME <u>Mike Bairn - Mount Royal</u>	ADDRESS <u>411 main st - Retail SPACE</u>
ADDRESS <u>Property MANAGEMENT</u>	<u>RACINE, WI 53402</u>
PHONE NO.	DATE OF PLANS
	ARCHITECT

We hereby propose to furnish the materials and perform the labor necessary for the completion of Installation of sanitary waste + vent, Hot + Cold water lines to Accomodate - 1-toilet, 1-Lav, 1-Floor drain and 1-Hot water Heater - 50 gallon. Tie into existing sanitary drain, and existing water meter. Tie into existing GAS and run to new Furnace in basement Area. NO Provisions for future Retail SPACE. Plumbing PERMIT included. All materials included in Price to Complete Plumbing. Fixtures: none

All material is guaranteed to be as specified, and the above work to be performed in accordance with the drawings and specifications submitted for above work and completed in a substantial workmanlike manner for the sum of Four thousand two hundred sixty dollars + 00/100 Dollars (\$ 4,260.⁰⁰) with payments to be made as follows.

50% - down Payment 25% - upon Completion
25% - upon Roughin

Any alteration or deviation from above specifications involving extra costs will be executed only upon written order and will become an extra charge over and above the estimate. All agreements contingent upon strikes, accidents, or delays beyond our control.

Respectfully submitted David Lepow
Per LEPow Plumbing

Note — this proposal may be withdrawn by us if not accepted within 30 days.

T+M Basis

ACCEPTANCE OF PROPOSAL

The above prices, specifications, and conditions are satisfactory and are hereby accepted. You are authorized to do the work as specified. Payments will be made as outlined above.

Signature _____

Date _____ Signature _____

New Again Renovation, Inc.

**4619 Pleasant Trail Drive
Mount Pleasant, Wisconsin 53403
262-909-7150**

Proposal

RE: 411-MA, nb

2/14/2019

**Mt. Royal Property Management
524 Main Street
Racine WI 53403**

The following quote is for ADA bathroom at 411 Main Street, Racine WI 50403

Rough in waste piping for 1) Toilet 1) sink 1) floor drain. Rough in water piping for fixtures and 50 Gal hot water heater. Furnish and install all fixtures. Includes all permits and inspections

\$6450.00



New Again Renovations

CARPETS PLUS OUTLET

1241 22nd Avenue, Kenosha WI 53140
Ph. 262-883-9494 * Fx. 262-883-9495
www.carpetsplusoutlet.com

Prices Valid for 30 Days

Date: 2/14/19

Salesperson: _____

Area _____ Installer _____ Date _____

Area _____ Installer _____ Date _____

Area _____ Installer _____ Date _____

Name Mount Royal Const.

Job Site 711 MAIN ST. Rental? Y N

City/State/Zip RACINE WI Selling? Y N

Home Ph. _____

Cell/Work MIKE BAIN - 909-7150

Bill to Address: _____

City/State/Zip _____

EMAIL:

Room/Area	Description (Include product manufacturer and type of flooring)	Pattern Match	Qty.	Price	Total Price
MAIN FLOOR	KRAVUS- ASPEN PEAK - COLOR T.35 GLUE DOWN VINYL PLANK		1872 sq ft	1.69/sf	3163.68
	EMBOSS (SKIM) EXISTING CONCRETE FLOOR				1068.00
	LABOR TO PREP FLOOR AND INSTALL				3726.00
	STAIRNOSEING TRANSITION				20.00
	PROVIDE AND INSTALL 4" CORE BASE ON WALLS				624.00
				GLUE	468.32
				FREIGHT	65.00
(PLANK DIRECTION TO BE DETERMINED)					
(IT MUST BE 65° INSIDE BUILDING)					
				Concrete	
				Adhesive	
				Metals	
				Step Labor	
				Subtotal	
				Sale Tax	
				Total	8775.00
				Deposit	
				Balance Due	

WE DO NOT MOVE ELECTRONICS, LARGE SCREEN TV'S OR BREAKABLES

- Customer Must Do:**
- Remove Furniture
 - Disconnect Gas
 - Touch Up Baseboards
 - Customer Initial _____
 - Move Appliances
 - Cut Off Doors
 - OTHER _____
 - Remove & Replace Base or 1/4
 - Tear Up Existing Carpet & Pad
 - Remove & Replace Toilet(s)

Padding	Steps	Floor
<input checked="" type="checkbox"/> 1/2" 8#	<input checked="" type="checkbox"/> Waterfall	<input type="checkbox"/> Wood
<input checked="" type="checkbox"/> 3/8" 8#	<input checked="" type="checkbox"/> Undernose	<input checked="" type="checkbox"/> Concrete
<input checked="" type="checkbox"/> 1/2" Stainmaster Deluxe Plus		<input type="checkbox"/> Gypcrete
<input checked="" type="checkbox"/> Other		

Metals	
Qty/Type	
Color	
Qty/Type	
Color	

NOTICE OF LIEN RIGHTS: AS REQUIRED BY THE WISCONSIN CONSTRUCTION LIEN LAW, BUILDER HEREBY NOTIFIES OWNER THAT PERSONS OR COMPANIES FURNISHING LABOR OR MATERIALS FOR THE CONSTRUCTION ON OWNER'S LAND AND BUILDINGS IF NOT PAID. THOSE ENTITLED TO LIEN RIGHTS IN ADDITION TO THE UNDERSIGNED BUILDER ARE THOSE WHO CONTRACT DIRECTLY WITH THE OWNER OR THOSE WHO VIE THE OWNER NOTICE WITHIN 60 DAYS AFTER THEY FURNISH LABOR OR MATERIALS FOR THE CONSTRUCTION. ACCORDINGLY, OWNER PROBABLY WILL RECEIVE NOTICES FROM THOSE WHO FURNISH LABOR OR MATERIALS FOR THE CONSTRUCTION AND SHOULD GIVE A COPY TO THE MORTGAGE LENDER, IF ANY. BUILDER AGREES TO COOPERATE WITH THE OWNER AND THE OWNER'S LENDER, IF ANY, TO SEE THAT ALL POTENTIAL LIEN CLAIMANTS ARE DULY PAID.

IMPORTANT NOTICE, CUSTOMER READ BEFORE SIGNING: Carpet is a fabric. All seams will be visible, some are more visible than others. Buyer understands that there may be a dye-lot variation from sample. Seller is not responsible for chips, dents or conditions of existing moldings, doors, jambs or fixtures. Not responsible for wires behind door jambs/casings. Room must be clear of obstacles at time of installation. Seller is not responsible for cutting doors. Seller is not responsible for manufacturer or shipper delays. Unforeseen structural problems upon installation may require additional charges to the Buyer. A FINANCE CHARGE OF 1.5% (18% PER ANNUM) WILL BE CHARGED TO ACCOUNTS 30 DAYS PAST DUE. In the event Buyer defaults under the terms of this agreement, Buyer agrees to pay reasonable attorney fees, interest, legal fees and court costs.

TERMS: 50% DEPOSIT REQUIRED WITH BUYER/OWNER PARTY SIGNATURE(S). BALANCE DUE UPON COMPLETION OF INSTALLATION UNLESS NOTED OTHERWISE. I/WE SIGN HEREBY ACCEPTING THE ABOVE TERMS AND CONDITIONS.

PLUOTON

Buyer/Owner Authorization

Date

Co-Buyer/Co-Owner

Date

411-MAIN



February 14, 2019

Mike Bain
Mt. Royal Property Management
524 Main St.
Racine, WI 53403

Re: 411 Main St.

Carpetland USA Kenosha, Inc will supply and install the following budget bid for the Resilient work for this project referenced above. Bid is per drawing from Mt. Royal and line items below.

Resilient flooring complete. **\$15,325.00**

Bid includes:

- Toilet to removed and reset by others.
- Sand new concrete and patch any construction floor joints.
- Supply & install LVP with a material allowance of \$2.90/sf wholesale cost.
- Supply & install standard 4" vinyl cove base in store area, 6" in toilets.
- All work during normal working hours.

Bid excludes:

- Prep work beyond above.
- Protection or vacuuming of installed flooring.

Terms: 50% down and balance on day of installation

Thank you for having us quote this project.

Respectfully submitted,
Dave Kirsch
Carpetland USA Kenosha, Inc Commercial Sales
5407 Green Bay Rd
Kenosha, WI 53144
davek@carpetlandwi.com

Flork
411-MAIN

Kreuser Electric LLC

6014-28 Ave
Kenosha WI 53144
262-748-5840

Estimate

Mike Bain

302-main street Racine WI

Thank you for the opportunity to bid this work.

Price includes;

3- em/exit led lights

1-em lights for bathrooms

1- 50 cfm bath fan/light

12- duplex receptacles 20 amp

2 - GFI per code 20 amp

4- 3 way switches

2- single switches

All conduit, and associated hardware

AC circuit, Furnace circuit

2- show window signage outlets

2- egress em lights exterior

Re ground system

City of Racine electrical permit.

All work to be to code, customer has choice of lighting temp and receptacle color.

*SPK Act
NEX T GACT*

All conduit to be EMT and flex in walls. THHN wire to be used.

Labor and Material \$4825 customer supplied light fixtures

Payment as follows;

\$2000 down

\$1000 after rough inspection

\$1825 upon final electrical inspection

Alternate for 411 Main Street

All same as 302 Main with the addition of 50 ft of additional conduit and wire \$5175.00



LICENSED IN WI & IL.
COMMERCIAL * INDUSTRIAL * AGRICULTURAL * RESIDENTIAL
262.605.6968

Proposal # 02112019-1

<i>Proposed Contract Submitted To:</i>	<i>Work To Be Performed At (if different):</i>
<i>Name</i> Mike Bain / My Royal llc.	<i>Name</i> White box interior alteration
<i>Street</i> 524 Main St. Suite 105	<i>Street</i> 411 Main st
<i>City/State</i> Racine, WI	<i>City/State</i> Racine, WI
<i>Phone</i>	

We respectfully propose the following for your consideration:

1. **Completion of electrical installation for white box alteration construction located at 411 Main St. in Racine Wisconsin.**
2. **Estimate based on white box plan received via email and discussions with Mike Bain and also minimum electrical code.**
3. **All device numbers are approximate and can be upgraded at a later date.**
 - a. Provide and install (20) 2 x 4 lay in flat-panel LED light fixtures / 50 W LED / 4000 lm associated with the main floor area, bathrooms and mechanical room.
 - b. Provide and install (2) Exit / EM battery backup LED light fixtures where required by code.
 - c. Provided install (2) EM battery backup LED light fixtures for the bathrooms.
 - d. Provided install (2) 80 CFM bath fans. (Venting by others.)
 - e. Installation of (12) duplex receptacle locations and (2) GFI protected receptacles in the bathrooms.
 - f. Installation of (2) three-way switch locations for the main floor lighting & the rear entrances.
 - g. Installation of (2) single pole switch locations for the bathrooms.
 - h. Installation of a three-quarter inch conduit home run from the panel board area extended to the front of the storefront with various junction box locations and approximately (6) separate circuits to be use as needed.
 - i. Provide separate circuits or feeders for a furnace location and an air conditioner location.

411-MAIN



LICENSED IN WI & IL.
COMMERCIAL * INDUSTRIAL * AGRICULTURAL * RESIDENTIAL
262.605.6968

Proposal # 02112019-1

- j. Provide separate circuitry for show window lighting and signage circuit required by code.
- k. Provide and install (2) LED exterior egress light fixtures powered by interior remote exit light required by code.
- l. Manifest the proper city of Racine electrical permit.

We respectfully propose this contract to furnish labor and material required to complete the project aforementioned in a substantial workmanlike manner for the sum of: **\$8,975.00**



Respectfully Submitted By:

Accepted By:

Dale B Shaffer

Dale Shaffer

Certified:
WI Master Electrician
WI Commercial Electrical Inspector
WI UDC-Residential Electrical Inspector
Illinois Electrical Contractor License

Office Ph: 262-605-6968
Email: dale@shaffer-electric.com
Fax: 262-997-1326



Phoenix Construction
3101 55th Court
Kenosha, WI 53144
262-945-6543

Estimate

Mt. Royal Property Management
524 Main Street Suite 106
Racine, WI 53403

4/9/19

RE: Main Street

Frame walls and ADA washroom per print	\$2400.00
Drywall and finish All framing	\$3100.00
Trim And Doors.....	\$2950.00

Acceptance of estimate:

Name:

Date

New Again Renovation, Inc.

**4619 Pleasant Trail Drive
Mount Pleasant, Wisconsin 53403
262-909-7150**

Proposal

RE 411 Main Street

4/10/2019

**Mt.Royal Property Management
524 Main Street
Racine WI 53403**

Framing ADA washroom and exterior walls per print, trim and doors \$5400.00

New Again Renovations

INVOICE NO. 836618

Invoice

SOLD TO MT ROYAL PROPRITY MANAGEMENT		SHIPPED TO L+B DRYWALL AND PAINTING, LLC		
ADDRESS 411 main St		ADDRESS 2844 S 7th St		
CITY, STATE, ZIP Racine WI 53403		CITY, STATE, ZIP MILWAUKEE WI 53215		
CUSTOMER ORDER NO.	SOLD BY	TERMS estimate	F.O.B.	DATE 2/12/19

work and materials

DRYWALL and Finish DRYWALL

\$2540.00

411 MAIN



Phoenix Construction
3101 55th Court
Kenosha, WI 53144
262-945-6543

Estimate

Mt. Royal Property Management
524 Main Street Suite 106
Racine, WI 53403

4/9/19

RE: Main Street

Frame walls and ADA washroom per print	\$2400.00
Drywall and finish All framing	\$3100.00
Trim And Doors.....	\$2950.00

Acceptance of estimate:

Name:

Date

STRICTLY CEILINGS_{LLC}

7311 Overlook Ter. Caledonia, WI 53108 ~ Phone: (262) 822-6620 ~ Fax: (262) 835-2788 ~
~ Email: strictlyceilings@wi.rr.com ~ Website: www.strictlyceilings.com ~

PROPOSAL

February 14, 2019

PM MtRoyal
pm.mtroyal@gmail.com

PROJECT: Acoustical Ceiling Installation

PROPOSAL: We are pleased to submit a bid for the following:

107 4th St ~Supply & install 1520 sf of 2x2 15/16" white grid as per plan
~Supply & install 1400 sf of 2x2 CertainTeed HHF-154 in same.
~Supply & install 120 sf of 2x2 vinyl sheetrock in bathrooms.
~Electrical & HVAC by others

Total cost including material and labor \$3500

OPTIONAL: ~Use 2x2 flat tile in place of revealed edge tile: **Deduct \$400 from above**

4111 Main St. ~Supply & install 1760 sf of 2x2 15/16" white grid as per plan
~Supply & install 1600 sf of 2x2 CertainTeed HHF-154 in same.
~Supply & install 160 sf of 2x2 vinyl sheetrock in bathrooms.
~Custom build approx...20 lineal feet of vertical drop
~Electrical & HVAC by others

Total cost including material and labor \$4500

OPTIONAL: ~Use 2x2 flat tile in place of revealed edge tile: **Deduct \$450 from above**

TERMS:

- Proposal:** Valid for 45 days. This proposal is based on information provided by the prospective customer. Should the dimensions, site conditions, or scope change upon our arrival to complete the project, a new proposal must be agreed upon. Additional charges will apply for work required to be performed outside normal business hours.
- Special Instructions:** Strictly Ceilings does not install support wires for other trades; including but not limited to electricians for light fixtures or any other means. SC Ceilings installs wires only for suspended ceiling support.
- Payment:** Due no later than 30 days after completion of work. Pay by Credit Card: add 3.5%
- Special Order** materials will require a non-refundable down-payment upon contract acceptance.
- Insurance:** A standard Certificate of Insurance is available upon request. Additional charges will apply for each additional license, bond, waiver of subrogation, limit increase, or other special coverage request and will be added to the invoice at the completion of the project. There is no charge for "Additional Insured" requests.
- Lien Waiver:** NOTICE IS HEREBY GIVEN AS REQUIRED BY WI CONSTRUCTION LIEN LAW THAT THE CONTRACTOR THAT PERFORMS AND/OR PROCURES LABOR, FURNISHES AND/OR PROCURES MATERIALS FOR THE OWNERS PROPERTY MAY HAVE LIEN RIGHTS ON OWNERS LAND OR PROPERTY IF NOT PAID. A LIEN WAIVER IS AVAILABLE UPON RECEIPT OF PAYMENT.

Your signature on this contract or submission of a Subcontract signifies agreement to these terms. Please sign and return this Proposal along with any insurance requirements for the project.

Customer

Date

Timothy Chapel
Strictly Ceilings LLC

2/14/19
Date

411-MAIN



PM MtRoyal <pm.mtroyal@gmail.com>

Revised 411 Main Street White Box Proposal

1 message

Jim Bishop <jbishop@postorinodecorating.com>
To: PM MtRoyal <pm.mtroyal@gmail.com>

Thu, Feb 14, 2019 at 8:20 AM

2/14/19

PM Mt Royal

524 Main Street #106

Dear Mike,

Please review the following quote and feel free to contact me with any questions or if you need any additional information. We look forward to working with you on your project.

411 Main Street White Box...\$18,636.00

FRAMING, DRYWALL, DOORS.

- All demo by owner.
- Fur exterior walls using steel studs 16" on center per plan.
- Frame two restrooms per plan using steel studs 16" on center.
- Install backing as needed for restroom accessories.
- Insulate restroom walls for sound.
- Frame walls for mechanical room using steel studs 16" on center.
- Furnish and install 5/8" drywall at all new walls.
- Tape all seams and sand to a smooth finish.
- Furnish and install two 3/0x7/0 hollow metal frame and oak flush doors no hardware figured at restrooms.
- Furnish and install at pair of 3/0x7/0 hollow metal frame and oak flush doors no hardware figured at mechanical room.
- Clean and haul all debris into owners supplied dumpster.

Acoustical Ceiling...\$6,580.00

CEILING - DROE IN.

411-MAIN

- Furnish and install 15/16" white metal grid.
- Furnish and install white 12" axiom trim at ceiling height change from 8' to 9'.
- Furnish and install 2x2 tile.

Mike I know the numbers are different with this new proposal from 2/13/19 but my pricing sheet didn't carry all the numbers down to the total my fault for not double checking SORRY

Thanks,

Jim

James A Bishop Sr.

Project Manager

 : (262) 633-7805

 : (262) 620-9033

jbishop@postorinodecorating.com



"Your painting resource since 1946"

Proposal

Page No. _____

of _____

Pages _____

K & R HEATING, INC.
 21119 North Cape St
 Union Grove, Wisconsin 53182
 (262) 835-4689 Fax (262) 835-0416

PROPOSAL SUBMITTED TO

(Mike) Mountroyal Property Management

PHONE

262-909-7150

DATE

04-11-2019

STREET

524 main suite 106

JOB NAME

411-main

CITY, STATE and ZIP CODE

JOB LOCATION

Racine, WI. 53405

ARCHITECT

DATE OF PLANS

pm.mountroyal@gmail.com

JOB PHONE

We hereby submit specifications and estimates for:

Install 90,000 BTU - 95% single stage armstrong high efficiency furnace. Intake and exhaust venting to be brought out east wall of utility room. 16x26x4 media cabinet rack installed on side of unit. All gas line and high voltage wiring to be done by others.

total: \$2,700.00

Install Evaporator coil, copper lineset

total: \$1,310.00

Install 13 seer 4ton 410A puren single stage Armstrong Air conditioner in back of building.

total: \$1,690.00

NOT INCLUDING ITS OUTSIDE OF BUILDING

Finish all ducting in utility room and run 60' of spiral through main building, with All supplies cut in, new t-start and t-start wire, and add 1 big return grill. 2 Fans vented (4")

\$total: \$4,740.

Alternate 1: Permits/Plans/Balancing

\$total: Cost \$ 8750.00

TOTAL \$8750

We Propose hereby to furnish material and labor — complete in accordance with above specifications, for the sum of:

Payment to be made as follows:

60% down — partial payment when equipment is delivered, final

payment upon completion

Material is guaranteed to be as specified. All work to be completed in a workmanlike manner according to standard practices. Any alteration or deviation from above specifications involving extra costs will be executed only upon written orders, and will become an extra charge over and above the estimate. All agreements contingent upon strikes, accidents or delays beyond our control. Owner to carry fire, tornado and other necessary insurance. Our workers are fully covered by Workman's Compensation Insurance.

Authorized Signature

Note: This proposal may be withdrawn by us if not accepted within

30

days.

Acceptance of Proposal

The above prices, specifications and conditions are satisfactory and are hereby accepted. You are authorized to do the work as specified. Payment will be made as outlined above.

Signature _____

Signature _____

Date of Acceptance: _____

Kenosha Heating and Cooling, LLC.

4421 Sheridan Road
Kenosha, WI. 53140



Quote #4826

Sent on 02/08/2019

Phone 262-652-6900

Email info@kenoshaheatingandcooling.com

Website www.kenoshaheatingandcooling.com

Mike Bain

411 Main Street
Racine, Wisconsin 53403

SERVICE / PRODUCT	DESCRIPTION	QTY.	UNIT COST	TOTAL
New Construction-Commercial	Provide and Install (1) 92%, 80,000 BTU, Heil Furnace with venting Provide and Install supply and return duct work (insulate the supply) Provide and Install supply and return grille package Provide and Install (1) Honeywell T4 thermostat with low voltage wiring Provide and Install (1) 13-seer 4 ton condensing unit Provide and Install (2) bathroom exhaust fans	1	\$12,325.00	\$12,325.00*
	Notes: 1. Price and equipment based off of heat calculations for retail space 2. Five year limited parts warranty 3. One year limited labor warranty 4. Gas and Electrical to be done by others 5. Roofer is not included			

* Non-taxable

1.) This quote is valid for the next 30 days, after which values may be subject to change.
2.) "As required by the Wisconsin construction lien law, builder hereby notifies owner that persons or companies furnishing labor or materials for the construction on owner's land may have lien rights on owner's land and buildings if not paid. Customer agrees if legal action is taken to collect this account, all reasonable costs of the collection, including attorney's fees will be paid by the customer. 12% per month service charge will be assessed on late payments.
3.) The above price, specification, and conditions are satisfactory and are here accepted. You are authorized to do the work as specified with in terms of this agreement. Payments will be as outlined above. Party signing fully understands and

Subtotal	\$12,325.00
Install (0.0%)	\$0.00
Total	\$12,325.00

411 - MAIN

Kenosha Heating and Cooling, LLC.

4421 Sheridan Road
Kenosha, WI. 53140



Quote #4826

Sent on 02/08/2019

Phone 262-652-6900

Email info@kenoshaheatingandcooling.com

Website www.kenoshaheatingandcooling.com

Mike Bain

411 Main Street
Racine, Wisconsin 53403

Notes Continued...

accepts responsibility for this agreement in its entirety. Payments terms are as follows: 50% Due upon acceptance, balance upon installation.

Date: _____ Signature: _____

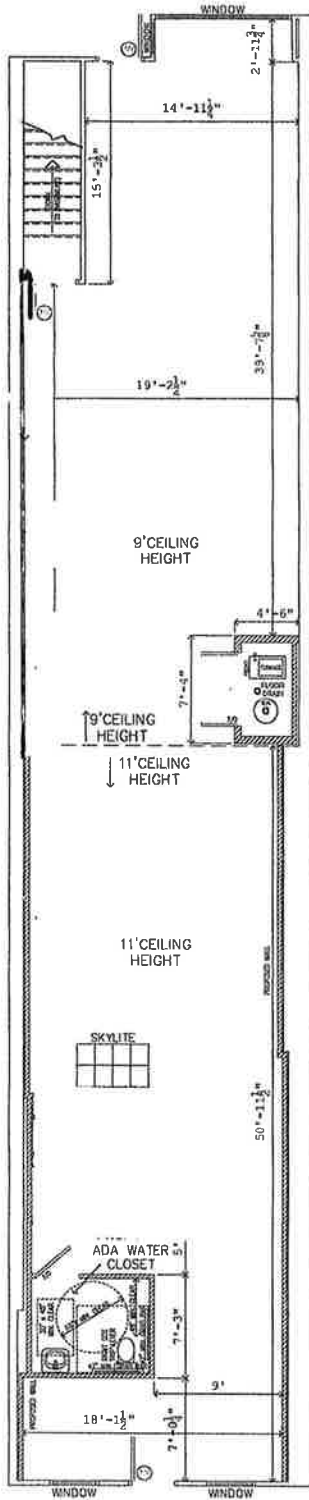

FLOOR PLAN 1,756 SQ. FT. ±

SCALE: 1/4" = 1'-0"

PROPOSED BUILD-OUT FOR:	
ADDRESS:	411 MAIN STREET
CITY:	RACINE, WI 53403
NOTICE: THE DRAWING IS THE PROPERTY OF THE ARCHITECT AND IS NOT TO BE REPRODUCED OR TRANSMITTED IN ANY FORM OR BY ANY MEANS, ELECTRONIC OR MECHANICAL, INCLUDING PHOTOCOPYING, RECORDING, OR BY ANY INFORMATION STORAGE AND RETRIEVAL SYSTEM, WITHOUT THE WRITTEN PERMISSION OF THE ARCHITECT.	
 TRUE NORTH NOMINAL TRUE ACUTUSL	
SHEET NUMBER:	
1	OF: 1
FLOOR PLAN	



Clothing

Plus Clothing
Grand Opening
APR 2019

FOR LEASE
MT. ROYAL
262-770-4482





