

Payne, Nancy

From: Johnson-Martin, Janice
Sent: Thursday, April 03, 2014 4:11 PM
To: Payne, Nancy
Cc: Zuehlke, Vikki
Subject: FW: Communication to Public Works and Services Committee
Attachments: Ruby Curblin-Cindy Magnuson.pdf; Ruby Prelim Drawing.pdf; Ara Plan Ruby Repave.pdf

14-10000

Nancy,

He wants this entered as a communication to go to Public Works. Also, at the meeting last night there was a petition and Vikki will put it in your mailbox which is part of this communication. Thanks

From: Diehl, Edward
Sent: Thursday, April 03, 2014 3:27 PM
To: Johnson-Martin, Janice; Weidner, Sandy
Cc: janet_petrik@yahoo.com; CJMagnus@SCJ.COM; jana.fiegel@sealedair.com; BTWhite@scj.com; rghalvorsen@yahoo.com
Subject: Communication to Public Works and Services Committee

Janice and Sandy:

I have been contacted by the residents of the 3000 block of Ruby Ave. concerning additions to a repaving project that was approved in early 2013. There are many negative elements involved with the new version of the project including the destruction of several beautiful, mature trees and significant changes to sidewalks, and yards. My assessment agrees with that of the residents - at stake are the beauty of this neighborhood, quality of life and significant increases in money to be spent. While well-intentioned, "straightening" the road at the cost of so much seems arbitrary and unnecessary.

I would like to send a communication to the Public Works and Services Committee to review these changes to the original plan. I would like to include the petition which was provided to your office at the 4/2/14 Common Council meeting as well as the letter from Mr. Halvorsen. I also edited some of the emails I have received from residents that describe the issue as well as three attachments for inclusion in the package for the PW&S Committee:

"Ron and I received a 2012 City of Racine Beautification Award as part of the Beauty in our Community program from Melissa Kaprelian-Becker as co-chair of Belle City in Bloom. Many of us in Racine are striving to create beautiful yards and neighborhoods, at some personal expense, I might add. I think the engineers need to be told that their objectives should be to preserve the natural beauty of the neighborhoods at all costs. Only in extreme circumstances should any trees be removed. Certainly, fixing kinks should be a low priority. As you know, they are ubiquitous on the north side. I'm not just concerned for Ruby Avenue but every single street considered for repaving. We estimate that the trees scheduled for removal on our street are about 150 years old. You can't replace those and expect that we will enjoy them in our lifetime. We have so many beautiful mature trees in our older neighborhoods. I think this is a much bigger issue than our project. But as to our project, I guess we could stop the paving entirely but I worry that in five years it will be proposed to cut down our trees all over again and we'll have to fight this battle once more. If we could just get a paving project approved we could rest easy that our trees will be safe for at least another generation."

"I was able to secure the preliminary drawing of the 3000 Ruby street improvement plan from 2013 that was voted upon, and a 1953 outline of the Curb and Gutter. The 1953 drawing is relative in sharing, because during our conversation that Ara Molitor mentioned he could not find any original drawings that illustrated "PIs", and based on what he had to create, that is what fixed the bend in the road. Ron, Janet, Lynn and I attended the city council meeting yesterday (4/2/14), with Ron submitting our petition and open letter to the council opposing the sidewalk shifting and tree removal. To recap quickly some of the points made within our 6 minutes of speaking during public comments at the 4/2/14 Common Council meeting:

- Residents are opposed, and have signed a petition
- The proposed work would make several houses be askew to the road, as opposed to fully facing the road
- Charisma of the neighborhood provided by mature trees is at risk
- In 2009/2010, many residents replaced sidewalk squares and driveway aprons at the city's request

- *In late March/early April 2013, petition was signed by approximately 85% of the residents opposing the redoing of the street. City approved repavement based on preliminary plan in April of 2013, and that preliminary plan is not aligned with proposed work illustrated in Ara's draft."*

Please contact me as soon as possible about the status of the communication and I will also be contacting the Public Works Department separately.

Thank you for your help -

Eddie

Edward E. Diehl, Ph.D.
15th District Alderman, City of Racine
Member, Board of Health
Member, Finance and Personnel Committee
Member, Racine Zoo Board
608-345-1927 cellular

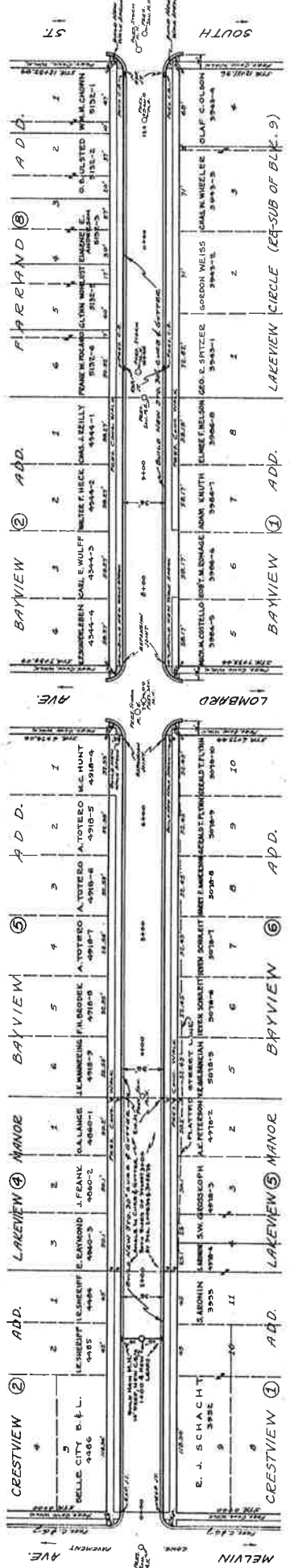

RUBY AVE.

RUBY

B.M.: HYD. COUPLING N.E. COR. LOMBARD AVE & RUBY AVE. ELEV. 4681

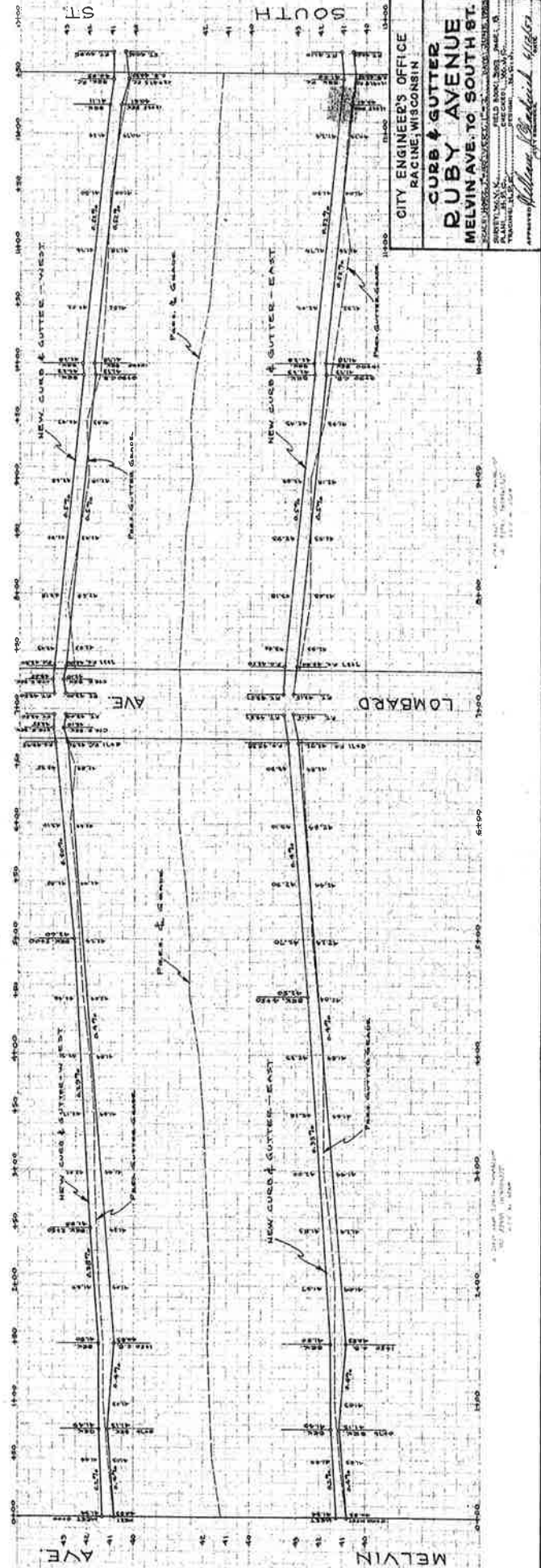

CITY ENGINEER'S OFFICE
RACINE, WISCONSIN

CURB & GUTTER
RUBY AVENUE
MELVIN AVE. TO SOUTH ST.

APPROVED: *William J. Beckwith* 1/15/20

DATE: 1/15/20

FILE NO. 2-2-20



BENCH MARKS:
 S.COUP.-HYD.-N.W. COR. XXXX-XXXX = XXX.XX
 S.COUP.-HYD.-MID BLOCK OF XXXX = XXX.XX

LEGEND:
 4" SIDEWALK REMOVAL & REPLACEMENT = [Symbol]
 6" DRIVEWAY REMOVAL & REPLACEMENT = [Symbol]
 6" SIDEWALK REMOVAL & REPLACEMENT = [Symbol]

- NOTES:**
- RECONSTRUCT SANITARY MANHOLE-REPLACE EXISTING MANHOLE FRAME & COVER WITH A NEW FRAME & SELF-SEALING LID (SUPPLIED BY THE CITY). INSTALL INTERNAL/EXTERNAL ADAPTER SEAL (EAS). WITH 10" RUBBER SLAVE (SUPPLIED BY THE CONTRACTOR).
 - RECONSTRUCT SANITARY MANHOLE-REPLACE EXISTING MANHOLE FRAME & COVER WITH A NEW FRAME & SELF-SEALING LID (SUPPLIED BY THE CITY). INSTALL INTERNAL/EXTERNAL ADAPTER SEAL (EAS). WITH 10" RUBBER SLAVE (SUPPLIED BY THE CONTRACTOR).
 - RECONSTRUCT TYPE A STORM WATER INLET.
 - RECONSTRUCT TYPE B STORM WATER INLET.
 - INSTALL NEW STORM MANHOLE FRAME & COVER (SUPPLIED BY THE CITY).
 - INSTALL NEW STORM WATER INLET FRAME & COVER (SUPPLIED BY THE CITY).

- THE CONTRACTOR SHALL INSTALL INLET PROTECTION TYPE 2 ON ALL INLETS WITH AN ADJUSTER TO THE FRONT EDGE OF THE CURB.
- BUILD TYPE 1 RAMP 6-INCH WITH DETECTABLE WARNING FIELD YELLOW.
- TYPE A PAVEMENT REMOVAL AND REPLACEMENT.
- TYPE B PAVEMENT REMOVAL AND REPLACEMENT.
- TYPE D PAVEMENT REMOVAL AND REPLACEMENT.
- BUILD TYPE A STORM WATER INLET.
- BUILD TYPE B STORM WATER INLET.

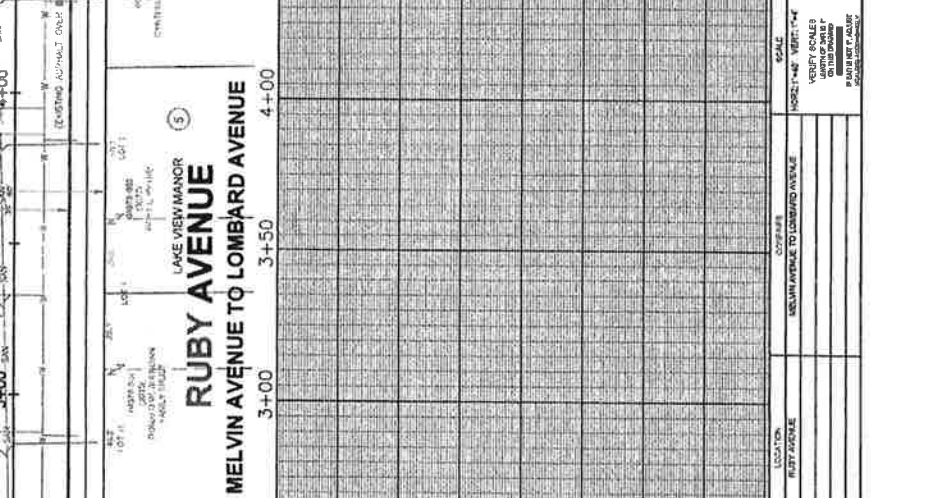
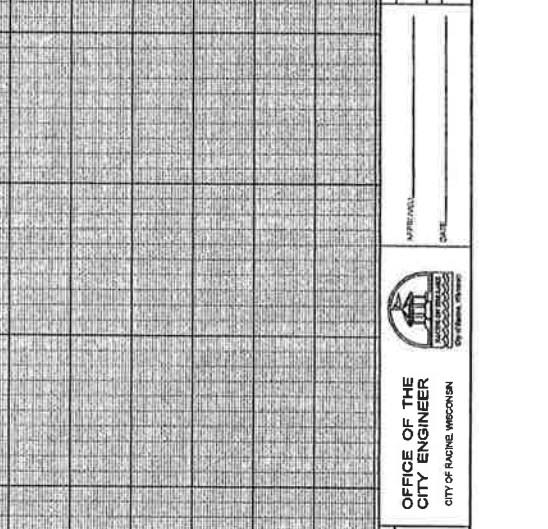

NO.	DESCRIPTION	DATE	BY	CHECKED	DATE	BY	PRICE	TYPE OF WORK	LOCATION	COST	SCALE
1	LAKE VIEW MANOR	10/15/14	J. J. JONES	J. J. JONES	10/15/14	J. J. JONES	500	PORTLAND CEMENT CONCRETE PAVEMENT	RUBY AVENUE		1"=40'
2	CREST VIEW	10/15/14	J. J. JONES	J. J. JONES	10/15/14	J. J. JONES	500	PORTLAND CEMENT CONCRETE PAVEMENT	RUBY AVENUE		1"=40'
3	LAKE VIEW MANOR	10/15/14	J. J. JONES	J. J. JONES	10/15/14	J. J. JONES	500	PORTLAND CEMENT CONCRETE PAVEMENT	RUBY AVENUE		1"=40'
4	LAKE VIEW MANOR	10/15/14	J. J. JONES	J. J. JONES	10/15/14	J. J. JONES	500	PORTLAND CEMENT CONCRETE PAVEMENT	RUBY AVENUE		1"=40'
5	LAKE VIEW MANOR	10/15/14	J. J. JONES	J. J. JONES	10/15/14	J. J. JONES	500	PORTLAND CEMENT CONCRETE PAVEMENT	RUBY AVENUE		1"=40'
6	LAKE VIEW MANOR	10/15/14	J. J. JONES	J. J. JONES	10/15/14	J. J. JONES	500	PORTLAND CEMENT CONCRETE PAVEMENT	RUBY AVENUE		1"=40'

OFFICE OF THE CITY ENGINEER
 CITY OF RAINIER, WISCONSIN

SCALE
 HORIZONTAL - 1"=40'
 VERTICAL - 1"=4'
 VERIFY SCALES
 MATCHING OTHER P
 SHEETS DRAWING

APPROVAL _____
 DATE _____

SHEET
 D. OF 01
 CASE 000
 DRAWING 000
 FOLDER 000

CALL NUMBER 1-800-848-0811
 WWW.CITYOFRAINIER.COM

