

Kids Don't Float Lifejacket Loaner Station

Materials List:

- 2 – 4' x 8' x ½" sheets treated Plywood
- 9 – 2 x 4 x 8' treated
- 3 – 2 x 6 x 7' treated
- 1 – 1 x 6 x 8' treated
- 1 – 1 x 4 x 8' treated
- 2 lbs. # 2 ½" deck screws
- 1 lb. # 1 5/8" deck screws
- 4' x 8' roof material of choice and attaching hardware
- 4 – 4" diameter vents
- 2 – 3" hinges
- 1 – 4" handle
- 6 – Rubber coated hinges for hanging life jackets
- 2 – heavy duty swivel coasters
- 2 – heavy duty stationary coasters
- 4 – 5" x ¼" carriage bolts
- 4 – 6 - 7" x ¼" carriage bolts
- 2 – ¼" lock nuts
- 6 – ¼" nuts
- 6 – ¼" washers
- +/- 12" of 1" x ¼" flat stock aluminum for sign mounting
- 1 – gallon brown oil base barn paint

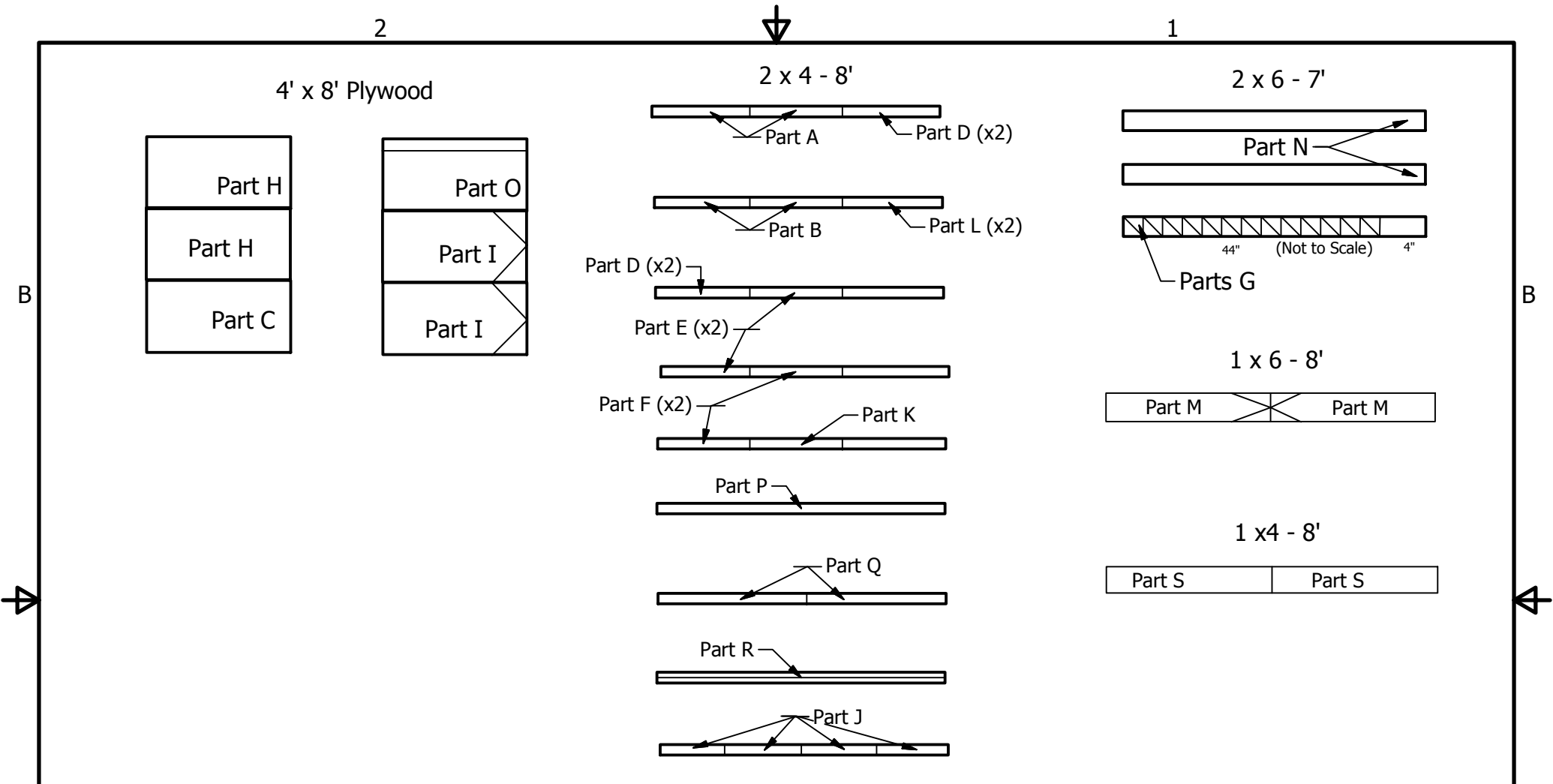

DRAWN Collin	9/14/2014
CHECKED	
QA	
MFG	
APPROVED	

<h1>Materials Breakdown</h1>			
TITLE			
SIZE A	DWG NO Materials		REV
SCALE	SHEET 1 OF 1		

Kids Don't Float Lifejacket Loaner Station

Assembly Instructions

1. Construct 32" x 47" Base Assembly:
 - a. Assemble Parts A and B.
 - b. Attach Part C using 1 5/8" deck screws.
2. Construct Box Assembly:
 - a. Attach part G to part E.
 - b. Attach part D to parts G/E.
 - c. Attach Part G to Part F.
 - d. Attach Part G/F to part D
3. Attach Box Assembly to Base Assembly:
 - a. Attach Box Assembly to Base Assembly using 8-12 2 1/2" deck screws.
 - b. For added strength, bolt the Box Assembly to the Base Assembly with four 5" x 1/4" carriage bolts, nuts, and washers.
4. Attach the front and rear panels (Part H) using 1 5/8" deck screws.
5. Attach side panels (Part I) to the sides of the box assembly using 1 5/8" deck screws.
6. Construct and attach the Cover Assembly:
 - a. Cut part K to appropriate length and angles and attach between side panels (Part I).
 - b. Cut and attach Part L below Part K as illustrated.
 - c. Cut and attach Part J to side panels (Part I), Box Assembly, and Part K/L.
7. Attach Part M (spacer board) to Part I (side panels) using several 1 5/8" deck screws (The spacer board allows the door to open freely).
8. Attach Part N (roof support posts) to Part M (spacer board) and Part I (side panels). Screw from both directions.
 - a. Provide additional strength by bolting each post through parts I, M, and the Box Assembly using two 6-7" carriage bolts, nuts, and washers on each post. Bolt through the horizontal portion of the Box Assembly (Parts F) at the base and top of the Box Assembly with the nut and washer on the interior of the assembly.

9. Complete the base by attaching Part O (rear cover) to the cover assembly using 1 5/8" deck screws.
10. Construct the Roof Assembly.
 - a. Cut and assemble parts P, Q, R, and S as illustrated.
11. Paint the interior and exterior surface of all components with a high quality oil base paint.
12. Install two 3"-4" diameter vents equally spaced in both the front and rear panels.
13. Attach two swivel coasters and two stationary coasters to the bottom of the Base Assembly. Two 4" x 4" skids, 33" in length can be used as an alternative.
14. Attach the provided front cover with two hinges. Attach handle to the front cover.
15. Attach roof material (Lexon panels, fiberglass panels, etc.) to the Roof Assembly, insuring the roof material extends beyond part R of the roof assembly by ¼" – ½" to provide a drip edge.
16. Place completed roof assembly in the roof support posts (Part N) and attach by inserting a 6-7" x ¼" bolt through both the support posts (Part N) and Roof Assembly (Part P). Use a ¼" lock nut to avoid damage to Part N. Additional stability can be provided by screwing Part Q to the support post (Part N).
17. Attach the provided sign to the roof support posts utilizing 1" flat stock aluminum bent to 90° and cut to an appropriate length. The aluminum brackets can be lag bolted to the roof support posts and bolted to the sign with appropriately sized bolts, washers, and nuts.
18. Pre-drill and insert three rubber-coated hooks on the exterior of each roof support post (Part N). Equally space the hooks along the posts.

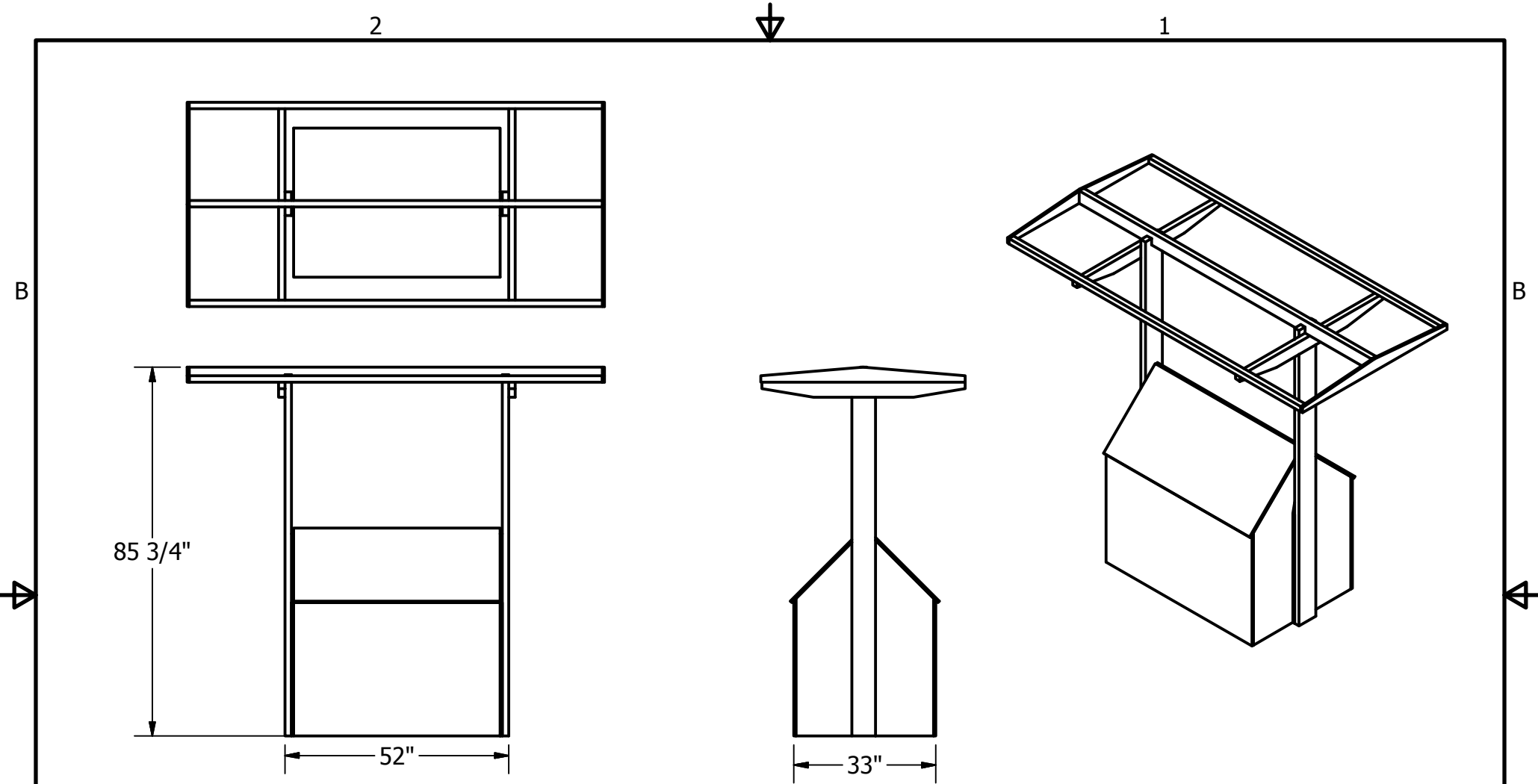

DRAWN Collin	7/9/2014
CHECKED	
QA	
MFG	
APPROVED	

Lifejacket Loaner Station

TITLE			
SIZE A	DWG NO	REV	
SCALE	Kids Don't Float		

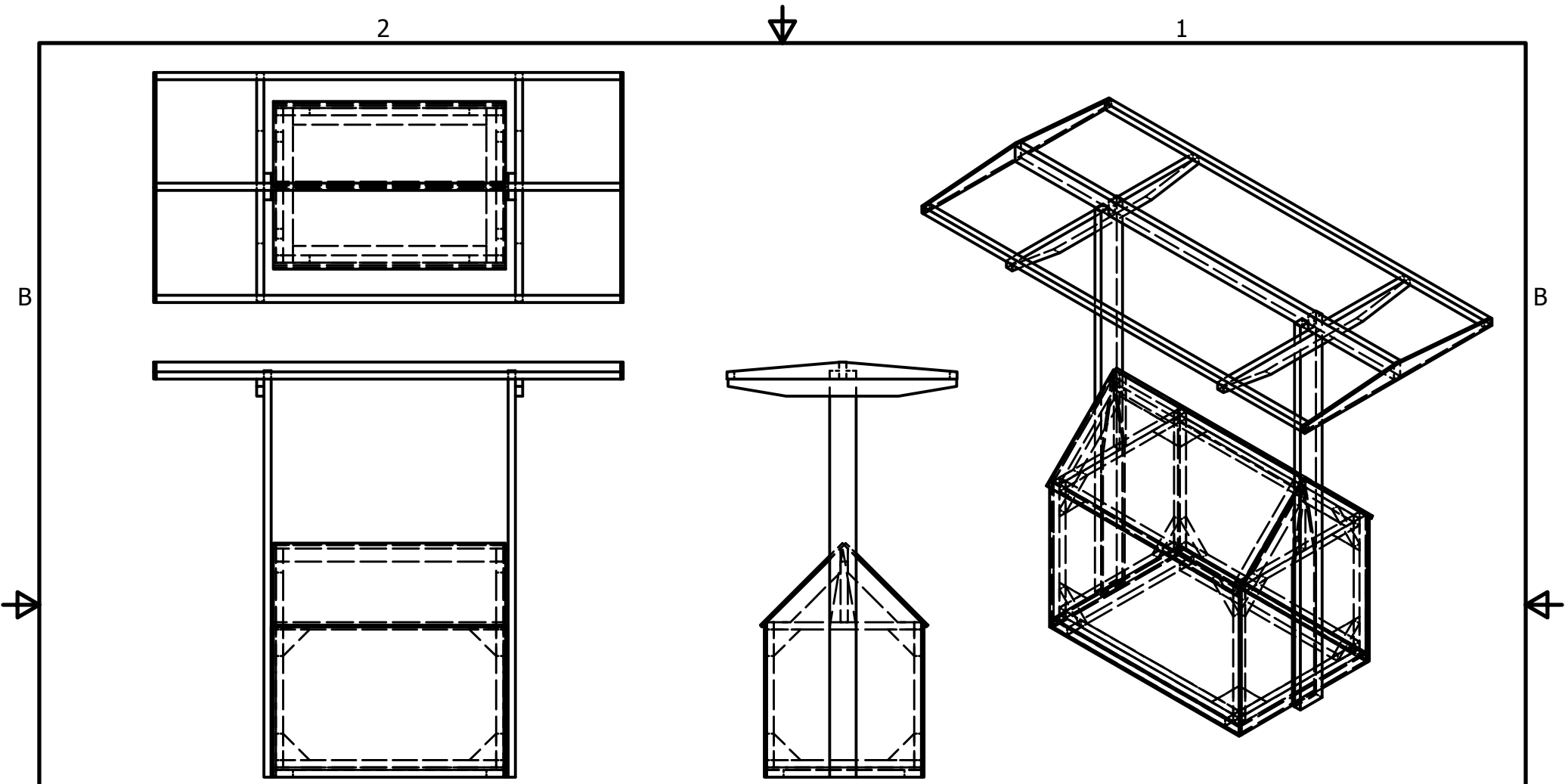

DRAWN Collin	7/10/2014
CHECKED	
QA	
MFG	
APPROVED	

Lifejacket Loaner Station

TITLE			
SIZE A	DWG NO Kids Don't Float 1	REV	
SCALE	SHEET 1 OF 1		

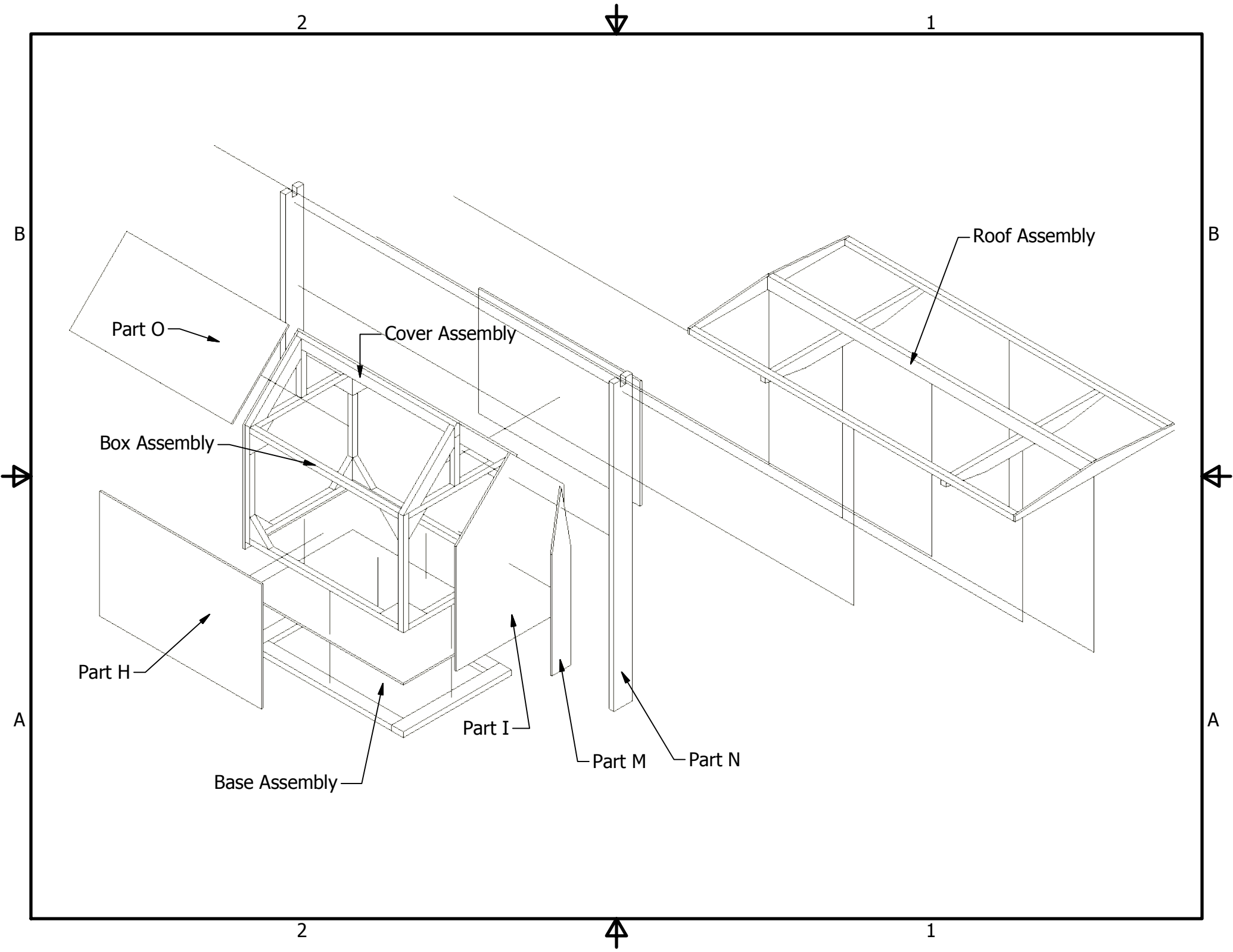

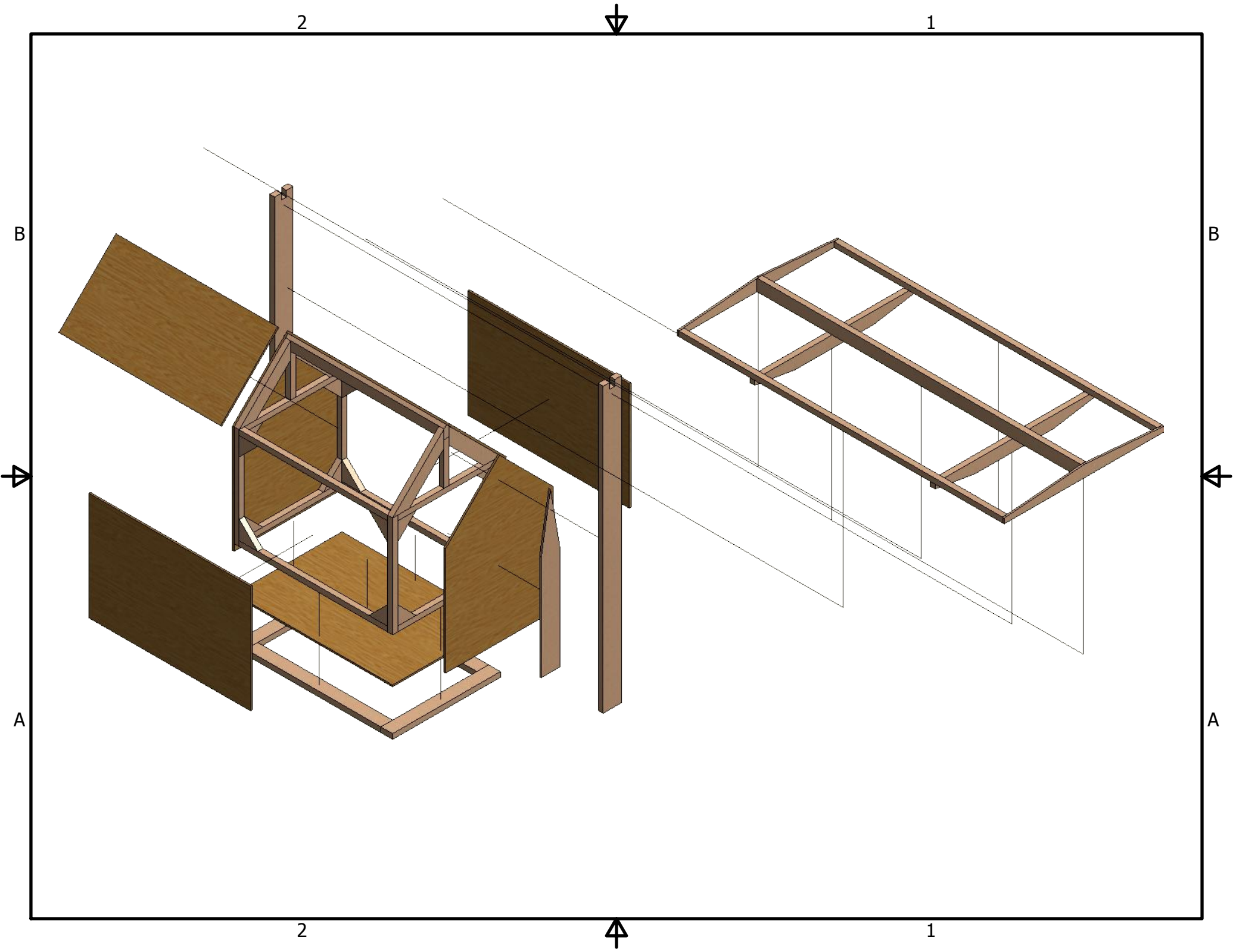

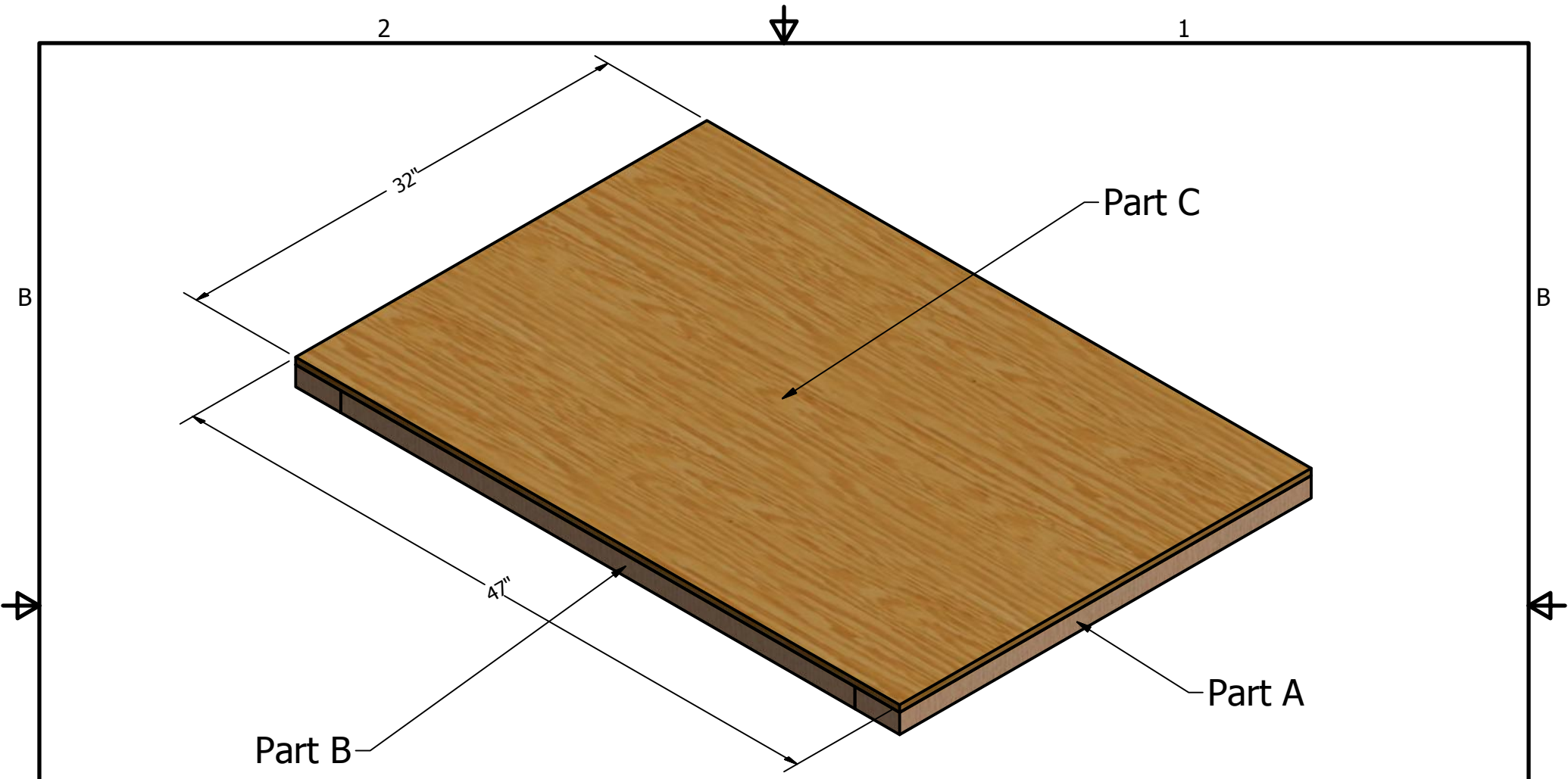

DRAWN Collin	7/8/2014
CHECKED	
QA	
MFG	
APPROVED	

<h1>Base Assembly</h1>			
TITLE Base Dimensions - 32" x 47" x 2" x2 - Part A x2 - Part B x1 - Part C			
SIZE A		DWG NO Base Assembly	REV
SCALE		SHEET 1 OF 1	

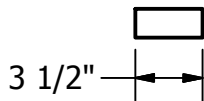
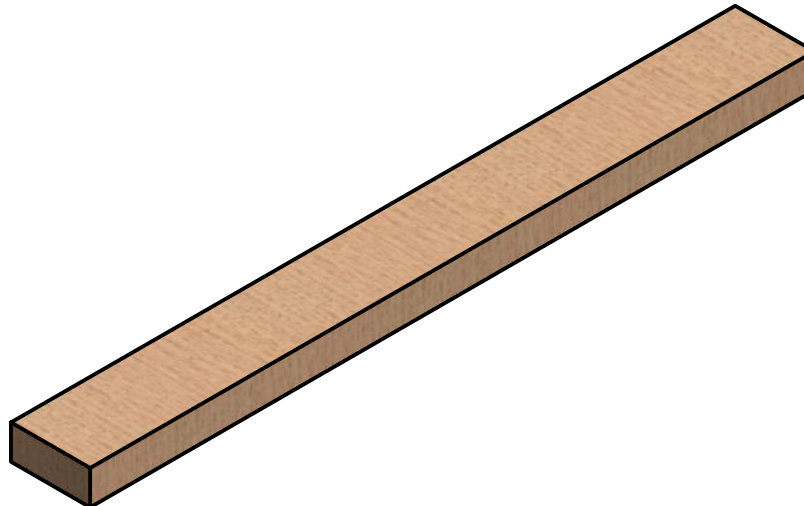
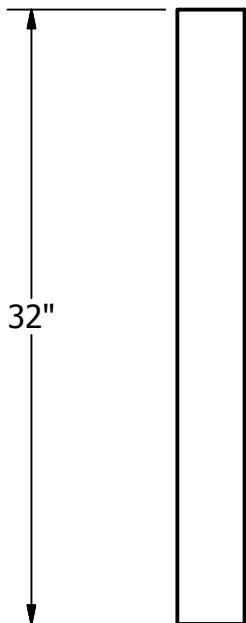

DRAWN Collin	7/8/2014	Part A - (Base Assembly)		
CHECKED				
QA		A		
MFG		A		
APPROVED		A		
		SIZE A	DWG NO Part A	REV
		SCALE		SHEET 1 OF 1

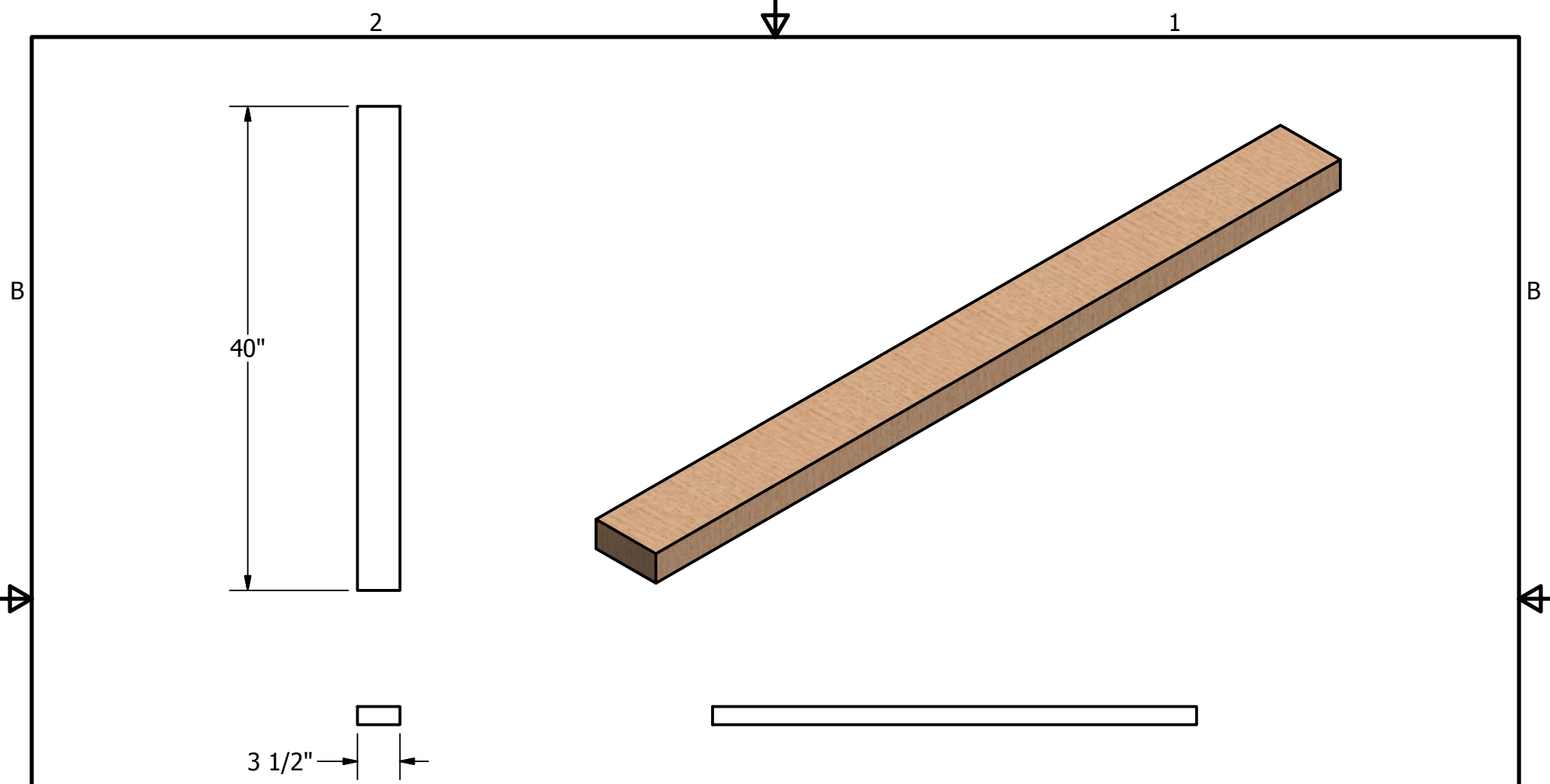

DRAWN Collin	7/8/2014	Part B - (Base Assembly)		
	CHECKED			
	QA	SIZE A	DWG NO Part B	REV
	MFG	SCALE	SHEET 1 OF 1	
	APPROVED			

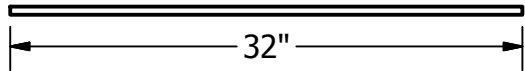
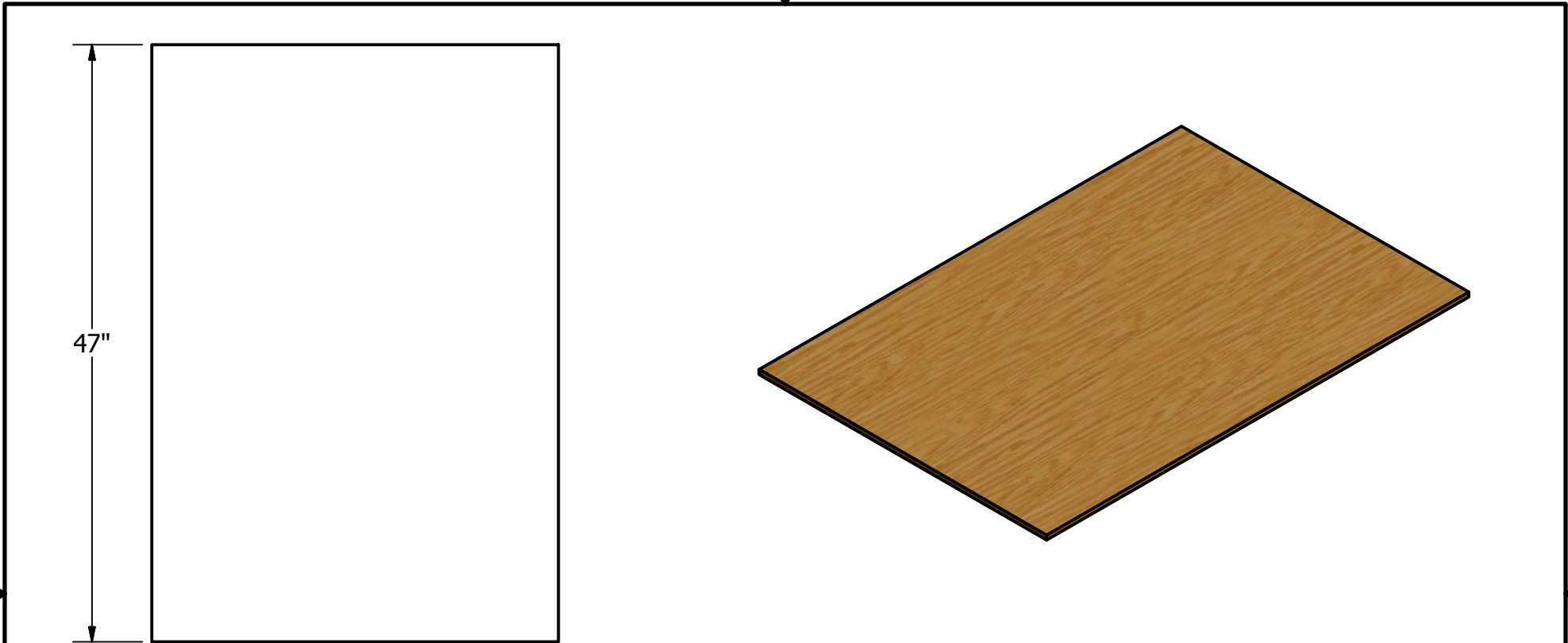

DRAWN Collin		7/7/2014		Part C - (Base Assembly)		
CHECKED						
QA				SIZE A		
MFG						
APPROVED				REV		
				SCALE		SHEET 1 OF 1

B

B

A

A

2

1

2

1

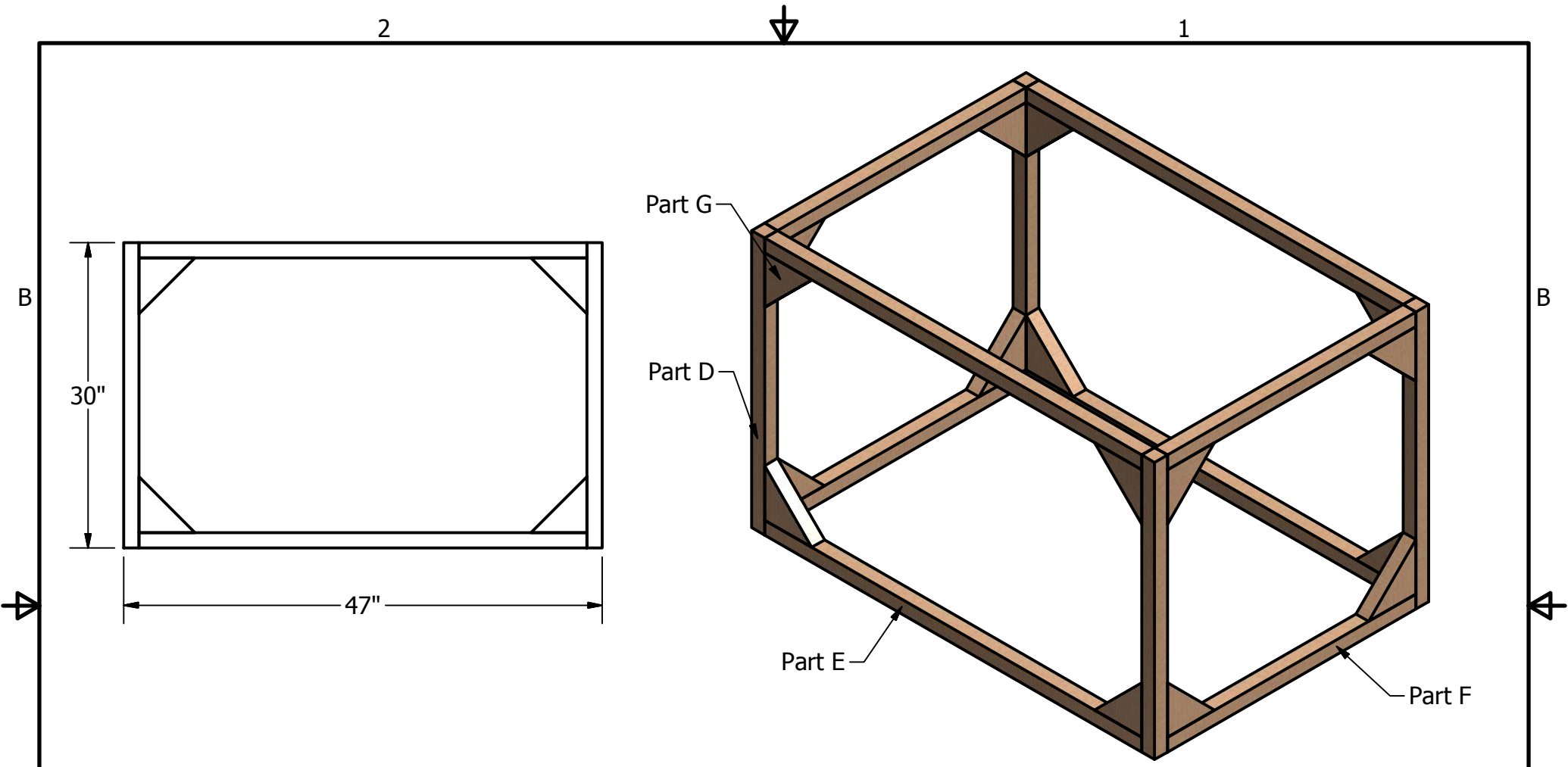

DRAWN Collin	7/8/2014
CHECKED	
QA	
MFG	
APPROVED	

<h1>Box Assembly</h1>			
TITLE Box Assembly: x4 - Part D x4 - Part E x4 - Part F x16 - Part G			
SIZE A		DWG NO Box Assembly	REV
SCALE			SHEET 1 OF 1

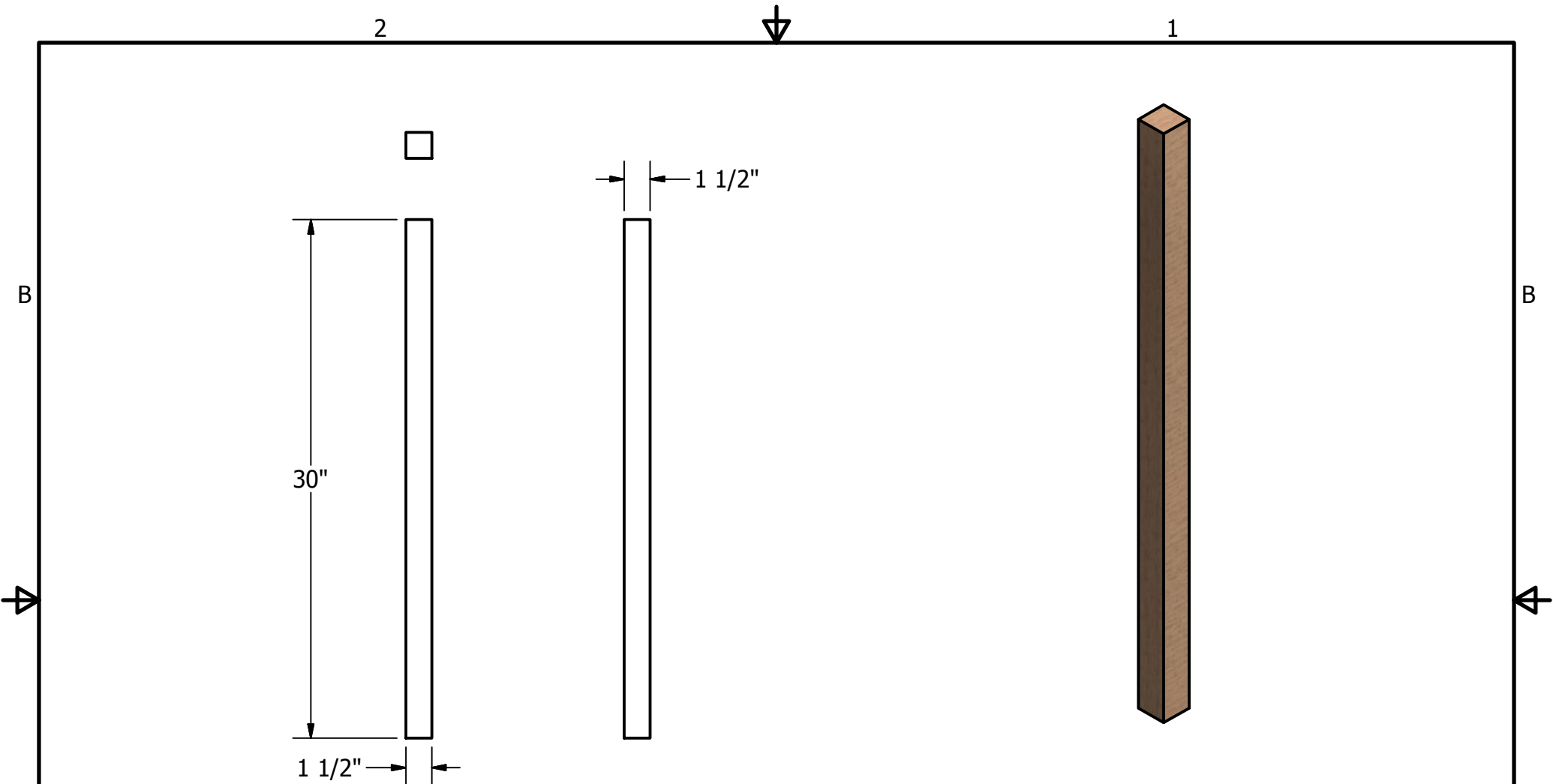

DRAWN Collin	7/8/2014
CHECKED	
QA	
MFG	
APPROVED	

Part D - (Box Assembly)			
TITLE x4 - 30" 2x2's			
SIZE A	DWG NO Part D		REV
SCALE	SHEET 1 OF 1		

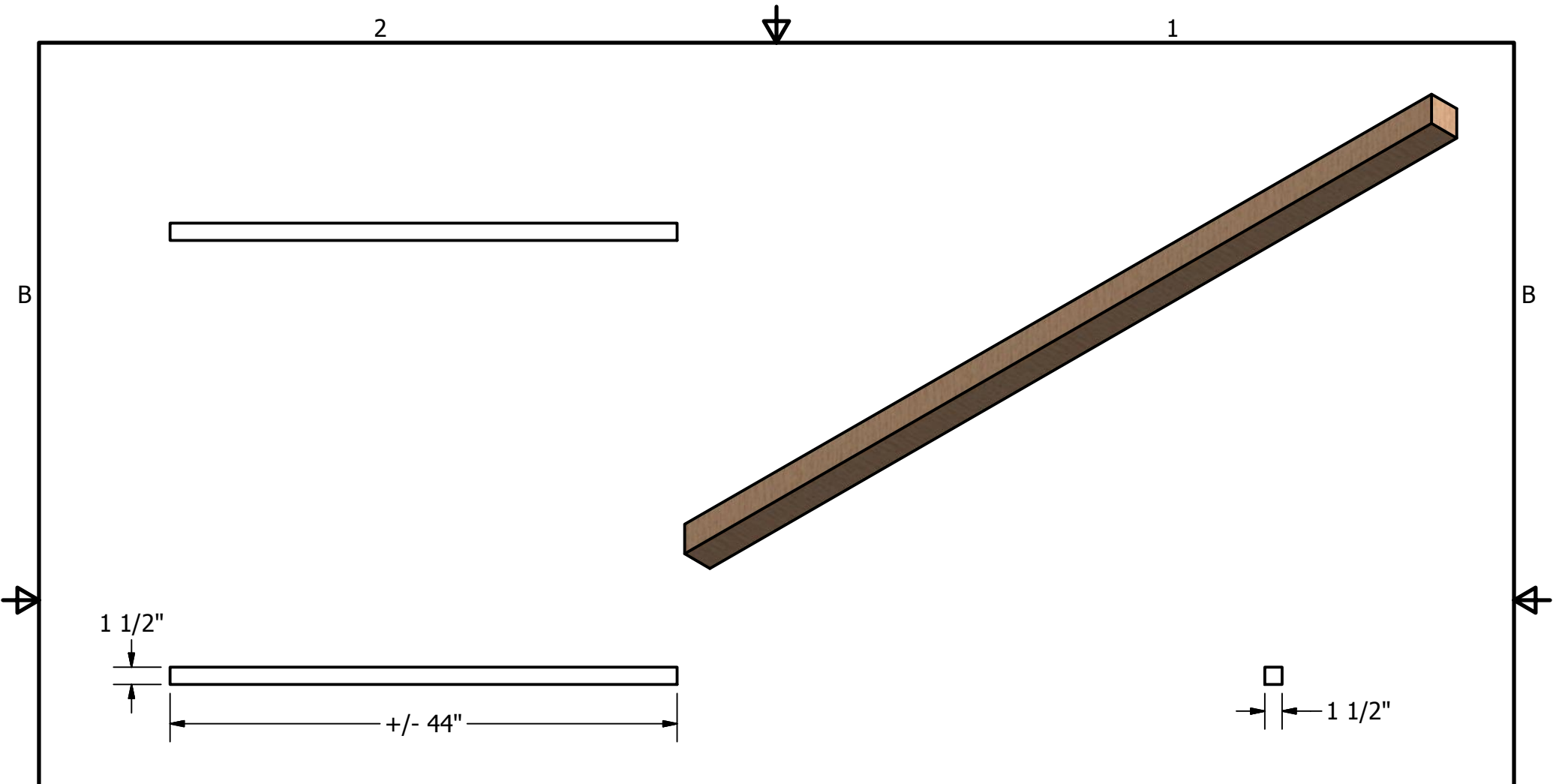

DRAWN Collin		7/8/2014		Part E - (Box Assembly)			
CHECKED							
QA				x4 - +/- 44" 2x2's			
MFG							
APPROVED							
				SIZE	DWG NO		REV
				A	Part E		
				SCALE	SHEET 1 OF 1		

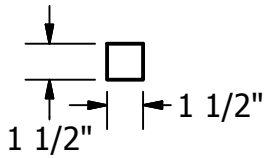
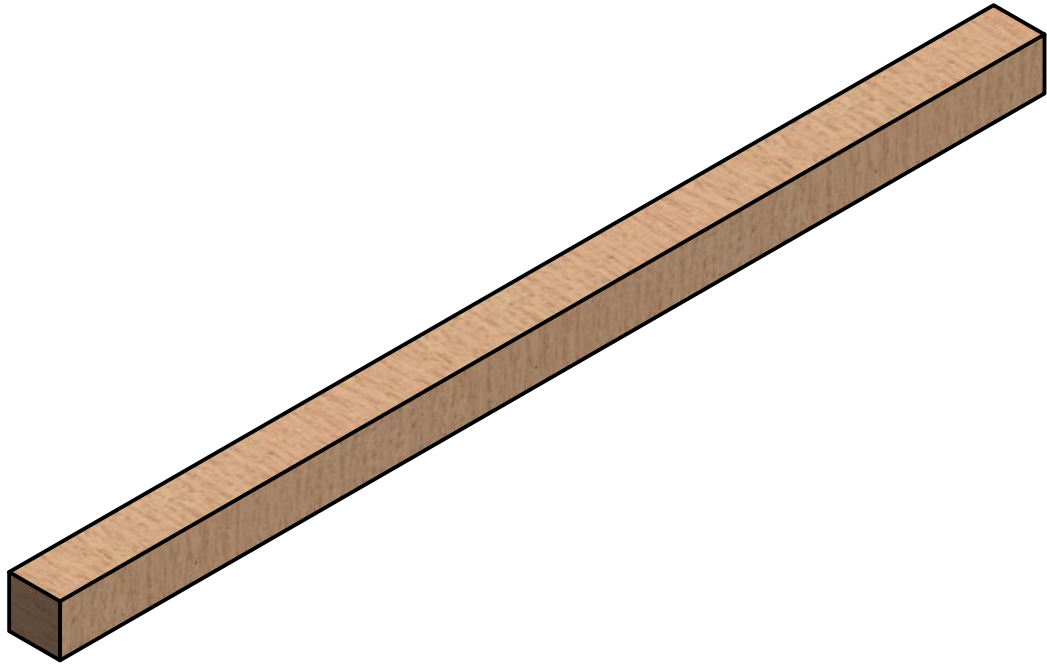
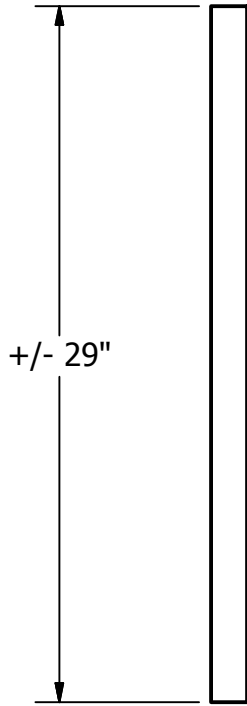

DRAWN Collin	7/8/2014	Part F - (Box Assembly)		
CHECKED				
QA		SIZE A		
MFG				
APPROVED		REV		
		SHEET 1 OF 1		

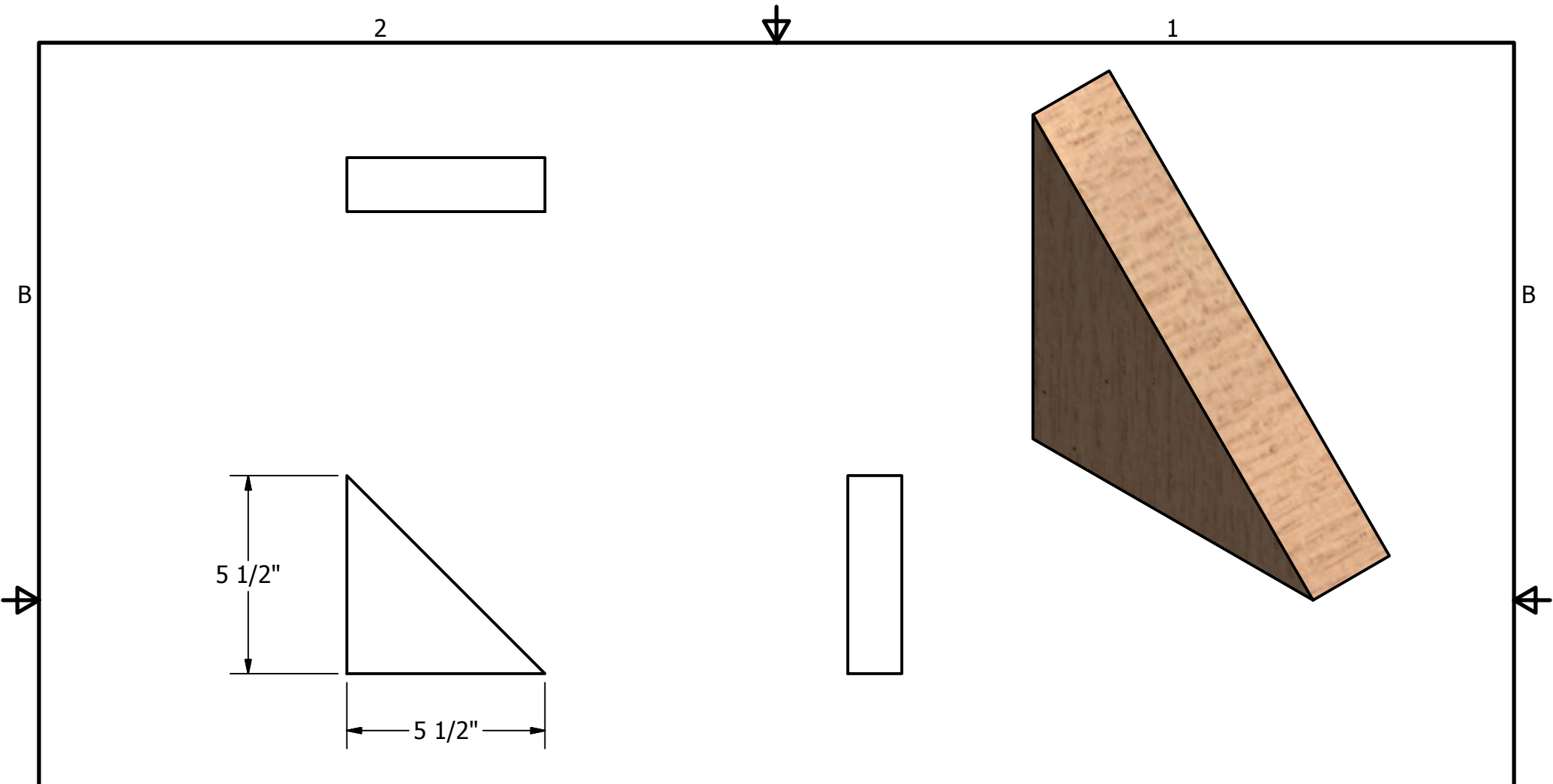

DRAWN Collin		7/8/2014		Part G - (Box Assembly)			
CHECKED							
QA				x16 - 2x6's cut into triangles			
MFG							
APPROVED							
				SIZE	DWG NO		REV
				A	Part G		
				SCALE			SHEET 1 OF 1

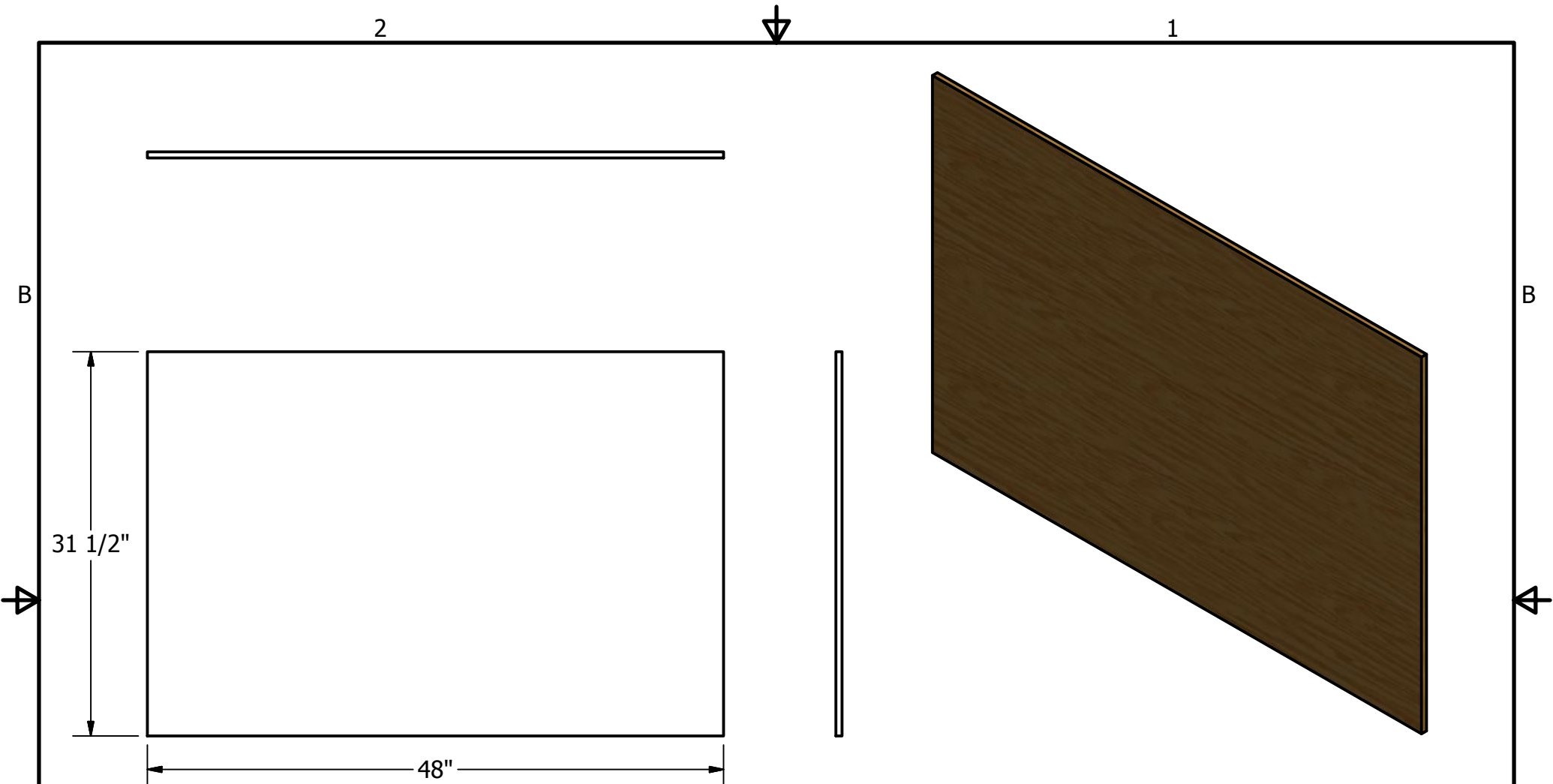

DRAWN Collin	7/8/2014
CHECKED	
QA	
MFG	
APPROVED	

Part H - Front/Rear Panels			
TITLE x2 - 32" x 48" x 1/2" Plywood - Treated			
SIZE A	DWG NO Part H		REV
SCALE		SHEET 1 OF 1	

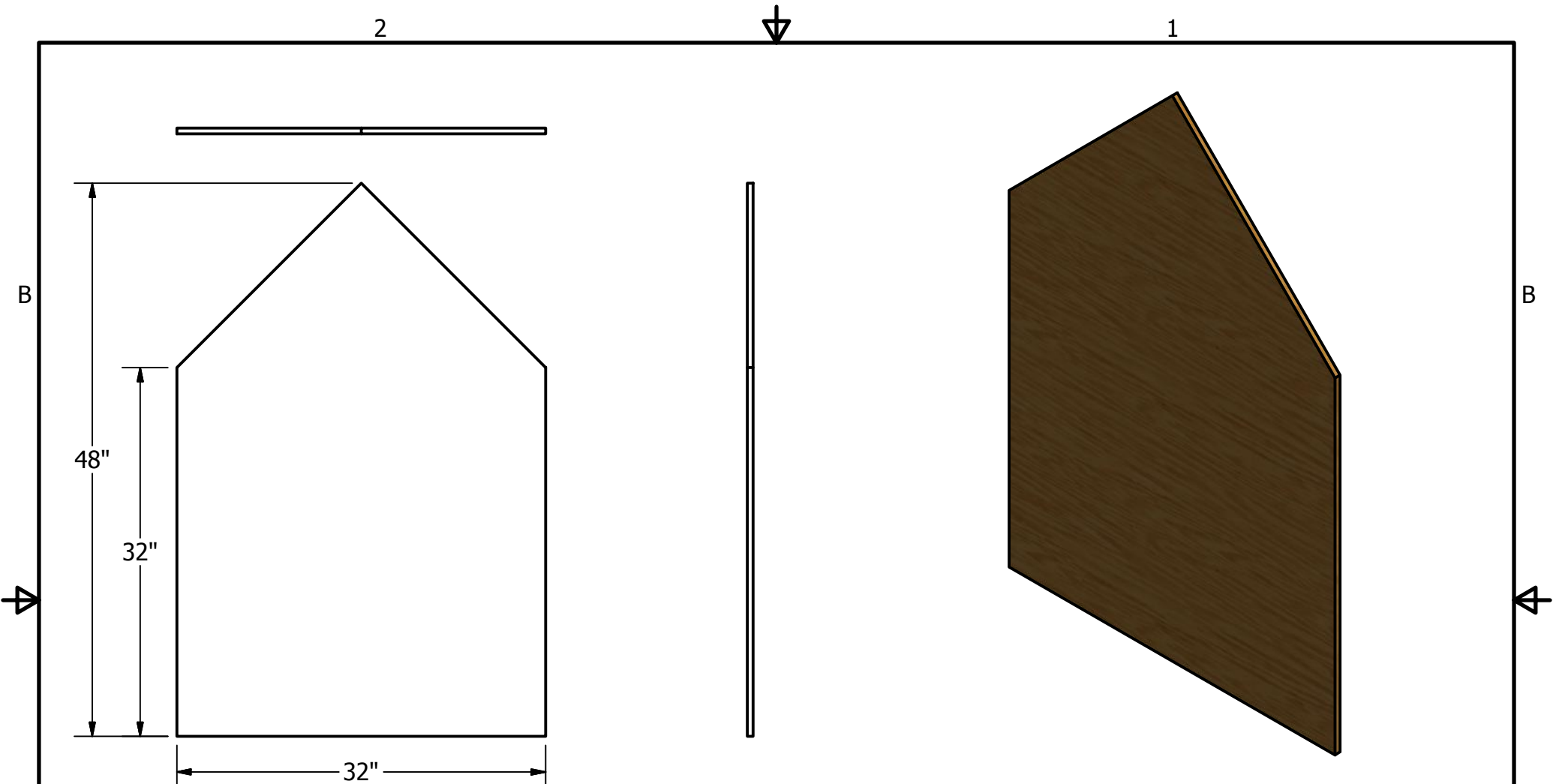

DRAWN Collin	7/8/2014
CHECKED	
QA	
MFG	
APPROVED	

Part I - Side Panels			
TITLE x2 - 32" x 48" x 1/2" Plywood - Treated			
SIZE A	DWG NO Part I		REV
SCALE	SHEET 1 OF 1		

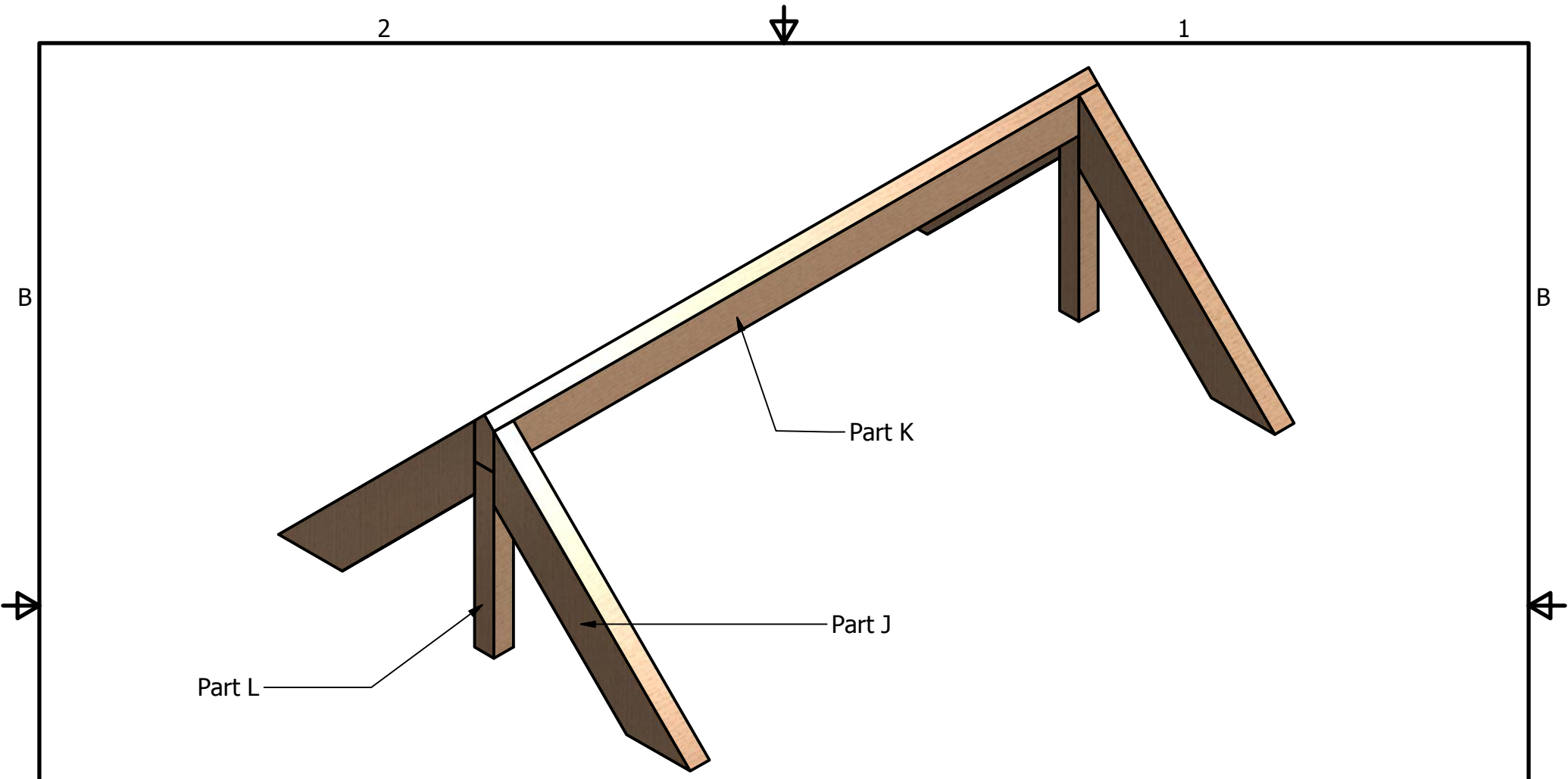

DRAWN Collin	7/17/2014	<h1>Cover Assembly</h1>	
CHECKED			
QA		TITLE x2 - Part J x1 - Part K x2 - Part L	
MFG		SIZE A	DWG NO Cover Assembly
APPROVED		SCALE	REV
			SHEET 1 OF 1

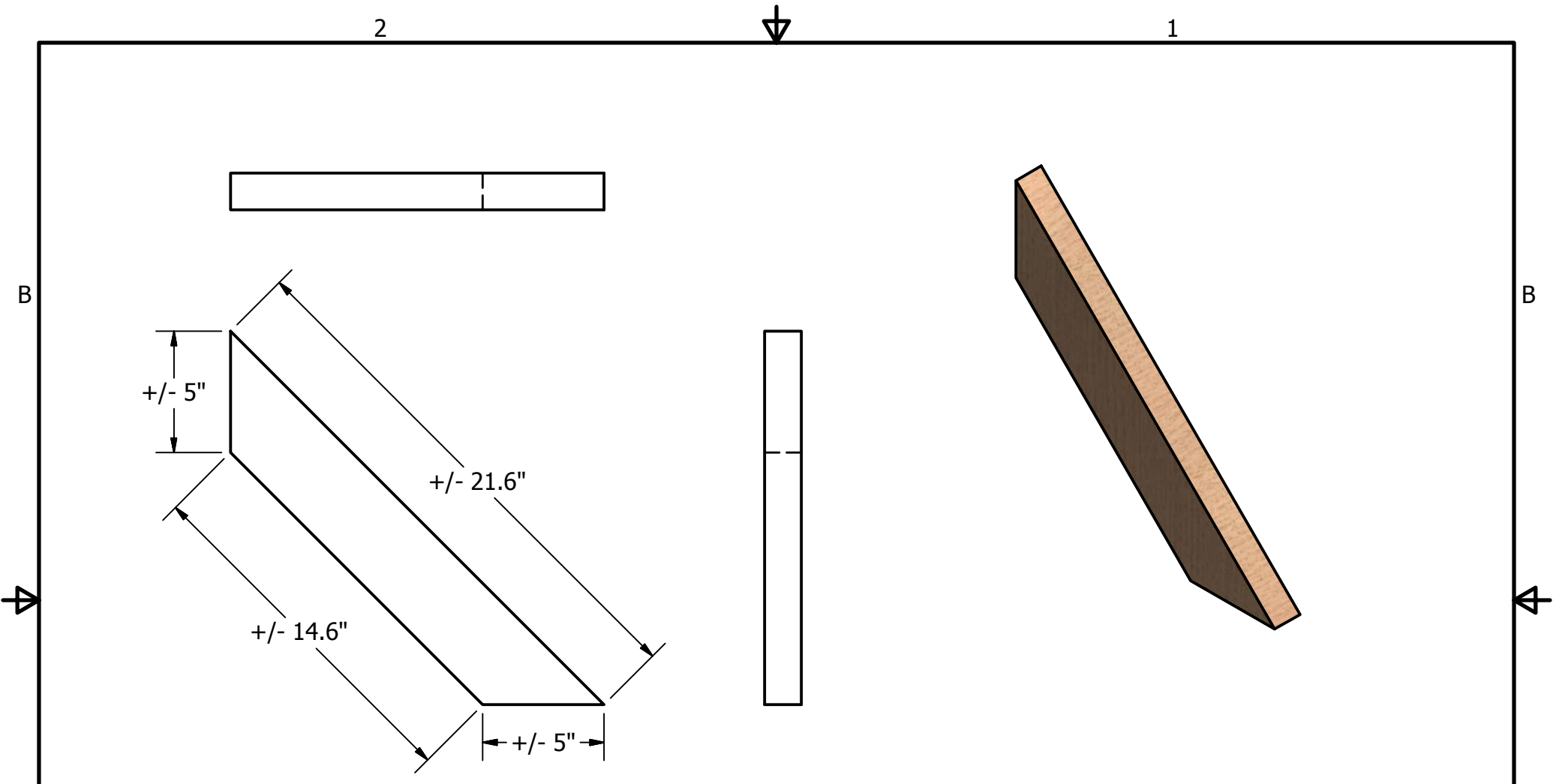

DRAWN Collin	7/9/2014
CHECKED	
QA	
MFG	
APPROVED	

Part J - (Cover Assembly)			
TITLE x4 - 2x4's cut at appropriate angles/size			
SIZE A	DWG NO Part J		REV
SCALE			SHEET 1 OF 1

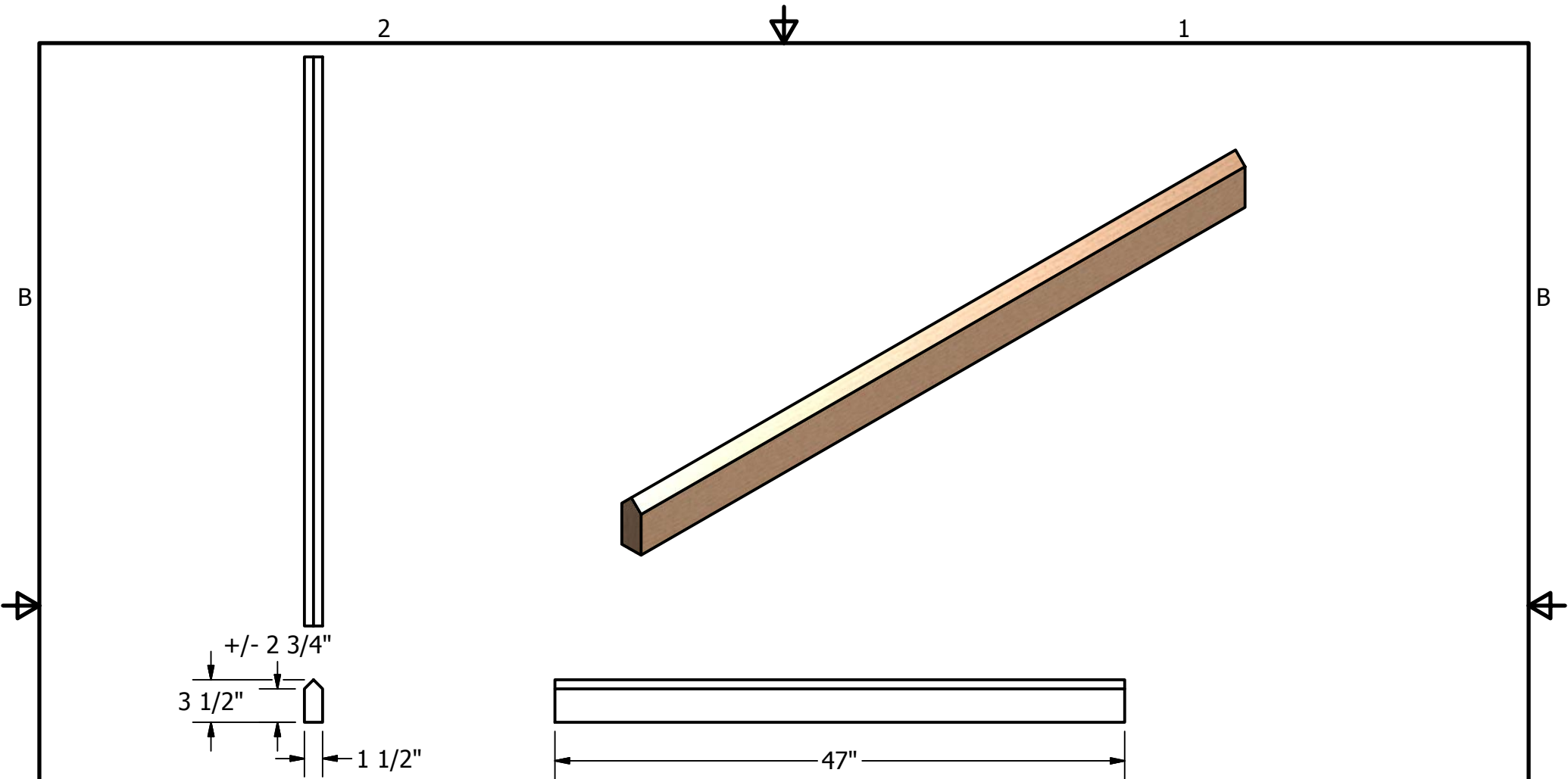

DRAWN Collin		7/9/2014		Part K - (Cover Assembly)			
CHECKED							
QA				x1 - 47" 2x4 - Treated			
MFG							
APPROVED							
				SIZE	DWG NO		REV
				A	Part K		
				SCALE			SHEET 1 OF 1

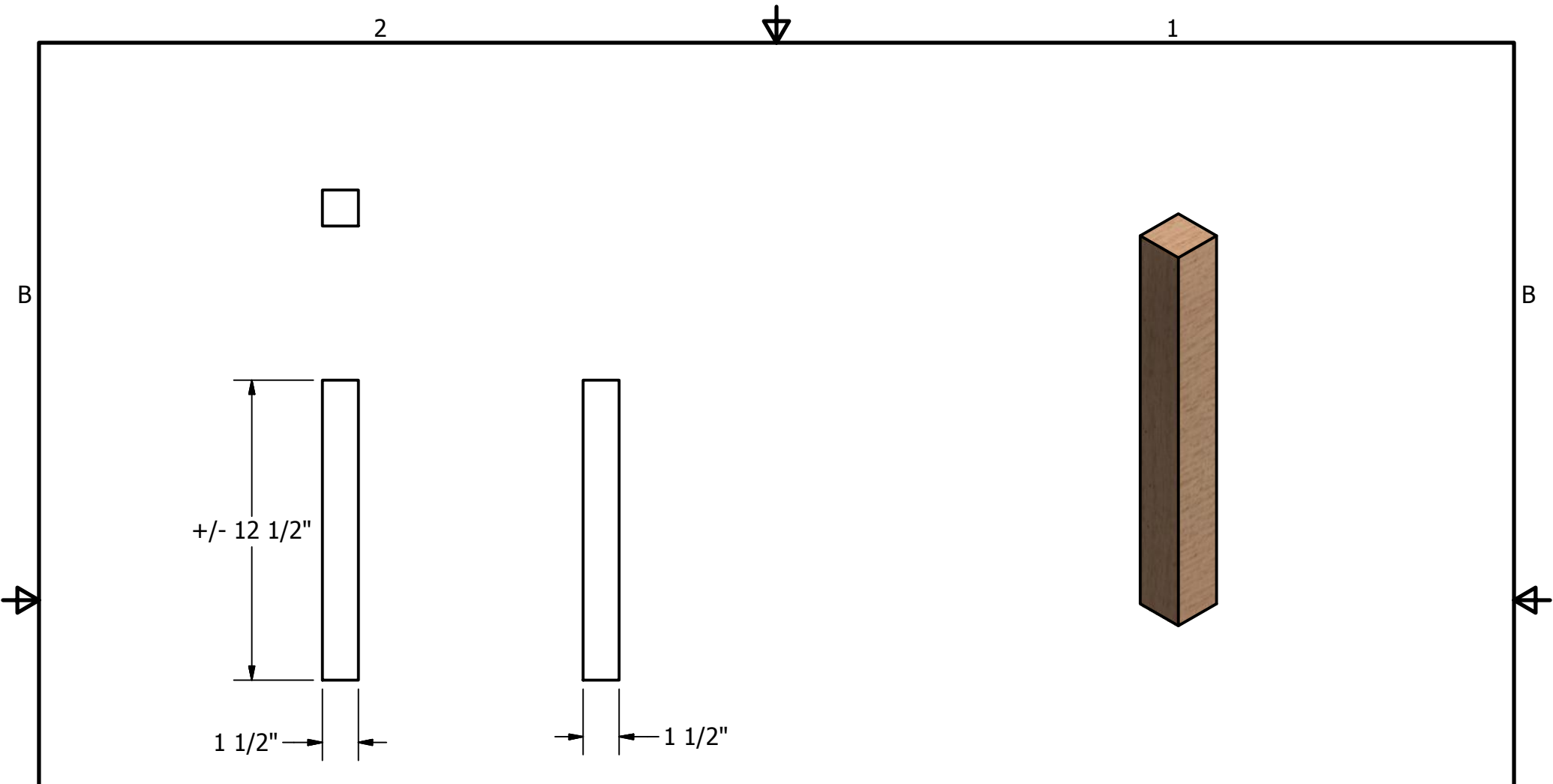

DRAWN Collin		7/8/2014		Part L - (Cover Assembly)			
CHECKED							
QA				SIZE A			
MFG							
APPROVED				REV			
				SCALE		SHEET 1 OF 1	

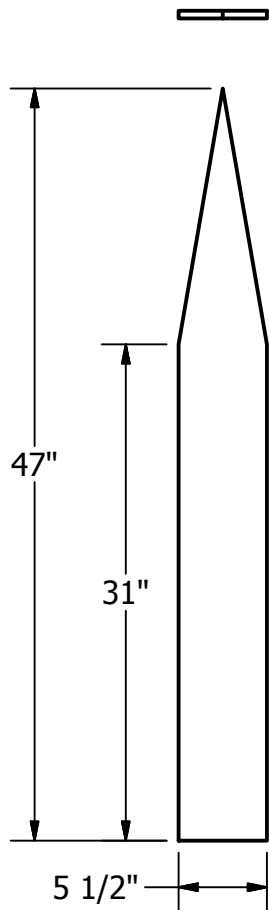

DRAWN Collin	7/8/2014	Part M - (Spacer Board)	
CHECKED			
QA		TITLE x2 - 47" 1x6's - Treated	
MFG		-Allows Door to Open Freely	
APPROVED		SIZE A	DWG NO Part M
		SCALE	REV
			SHEET 1 OF 1

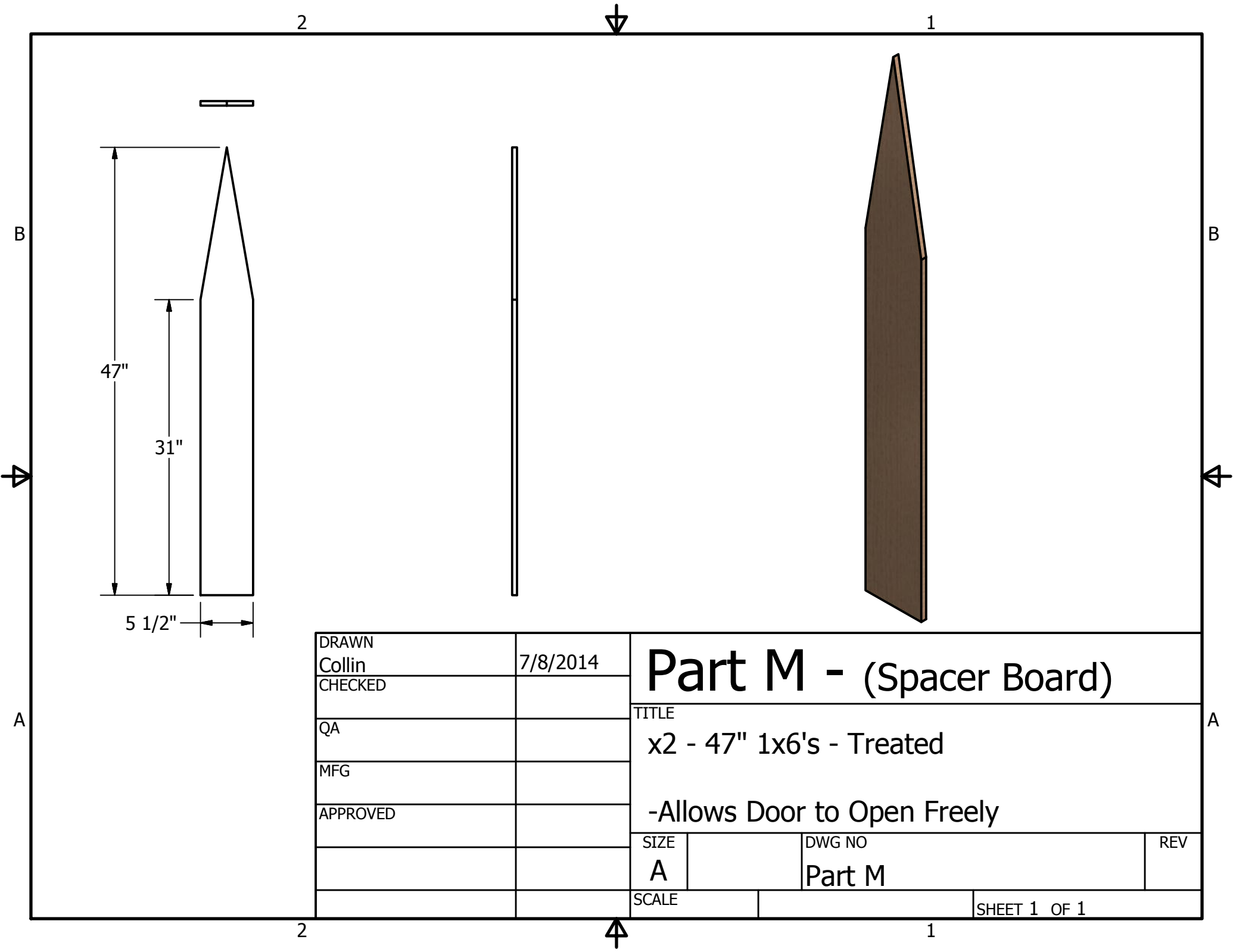

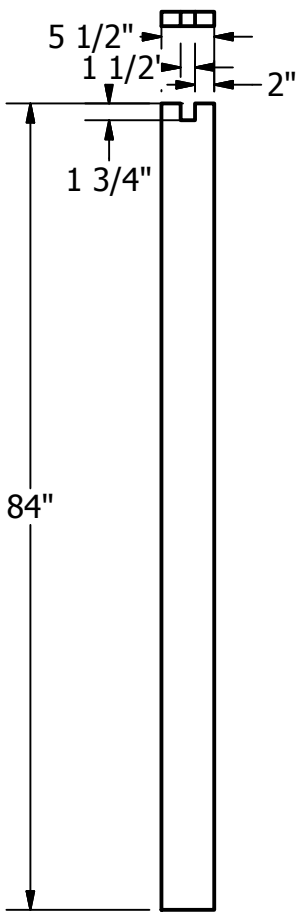

DRAWN Collin		7/8/2014		Part N - Roof Support Posts			
CHECKED							
QA				x2 - 84" 2x6's w/ slots for roof beam - Treated			
MFG							
APPROVED							
				SIZE	DWG NO		REV
				A	Part N		
				SCALE		SHEET 1 OF 1	

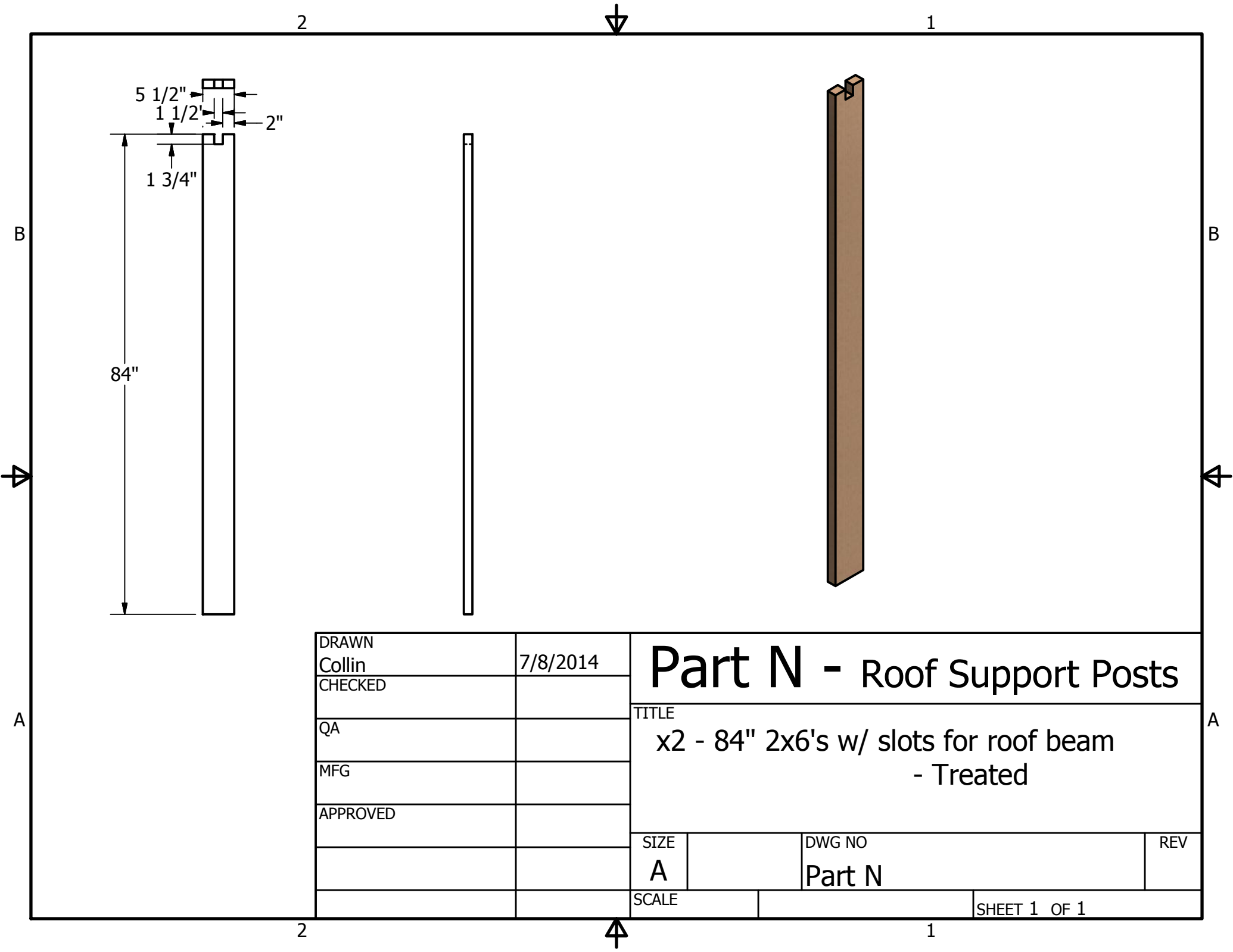

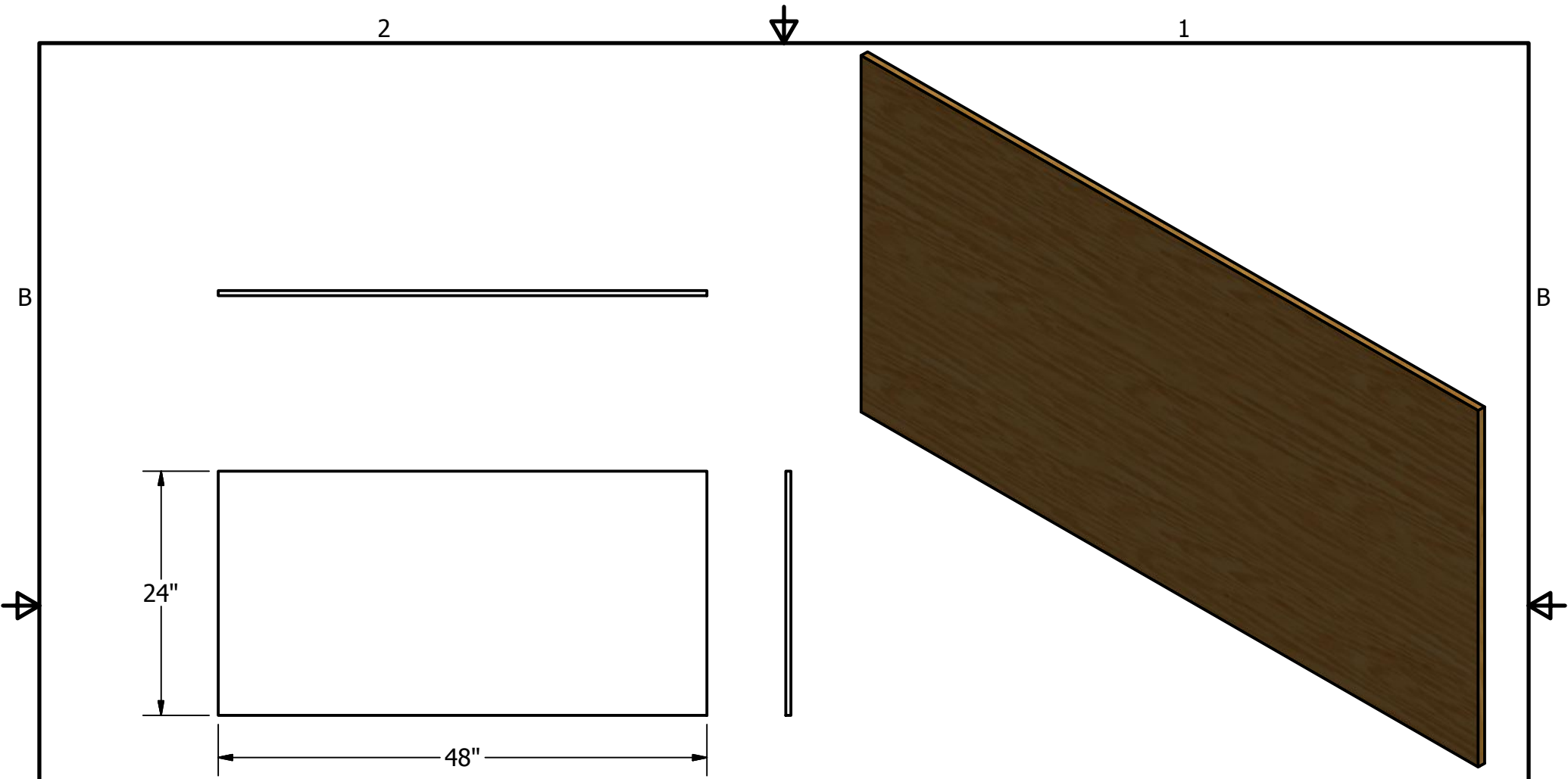

DRAWN Collin	7/8/2014
CHECKED	
QA	
MFG	
APPROVED	

Part O - (Rear Cover)			
TITLE x1 - 48" x 24" x 1/2" Plywood (Rear Cover) - Treated			
SIZE A	DWG NO Part O		REV
SCALE	SHEET 1 OF 1		

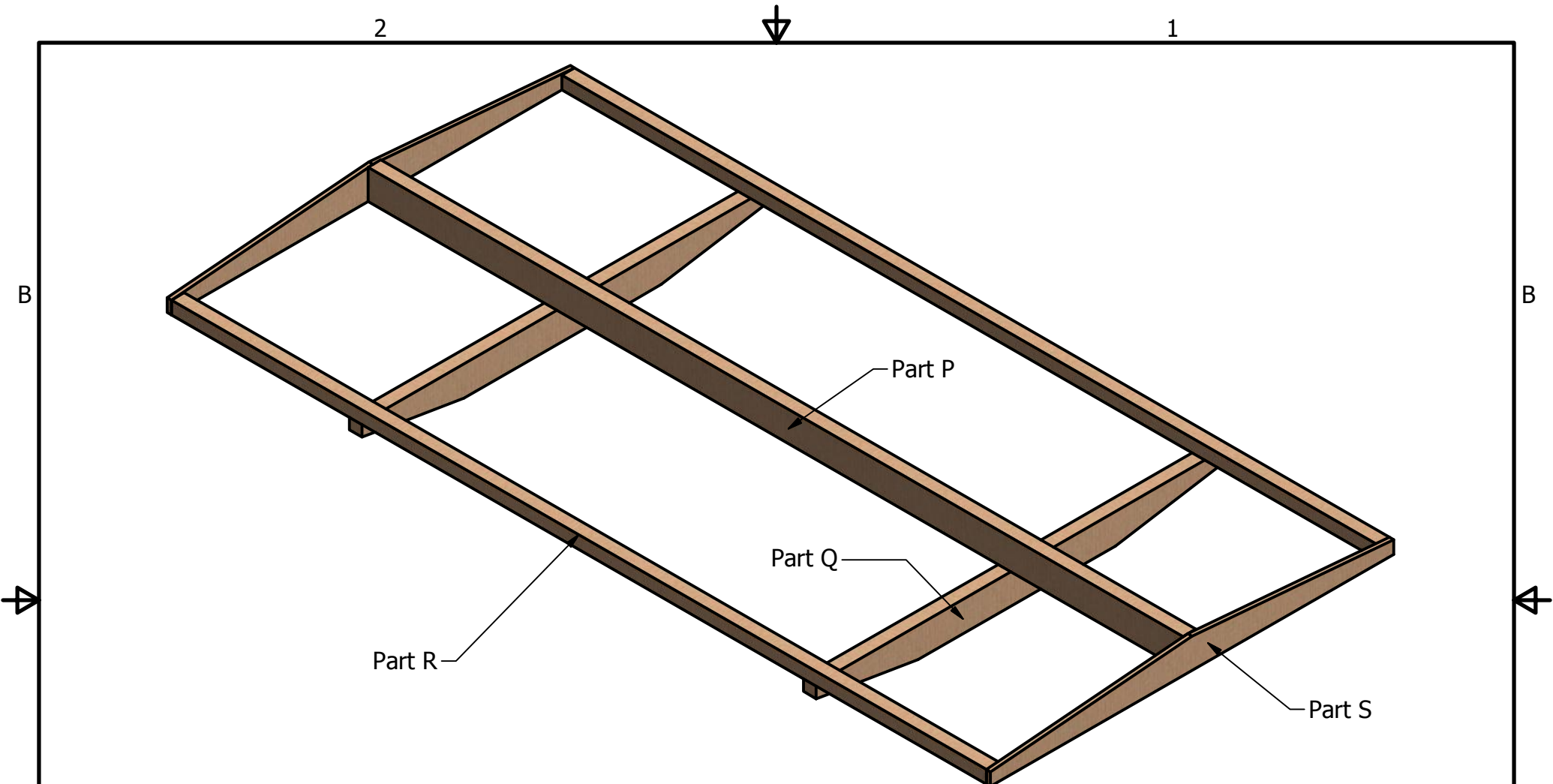

DRAWN Collin	7/15/2014
CHECKED	
QA	
MFG	
APPROVED	

<h1>Roof Assembly</h1>			
TITLE			
x1 - Part P			
x2 - Part Q			
x2 - Part R			
x2 - Part S			
SIZE		DWG NO	REV
A		Roof Asseblly	
SCALE			SHEET 1 OF 1

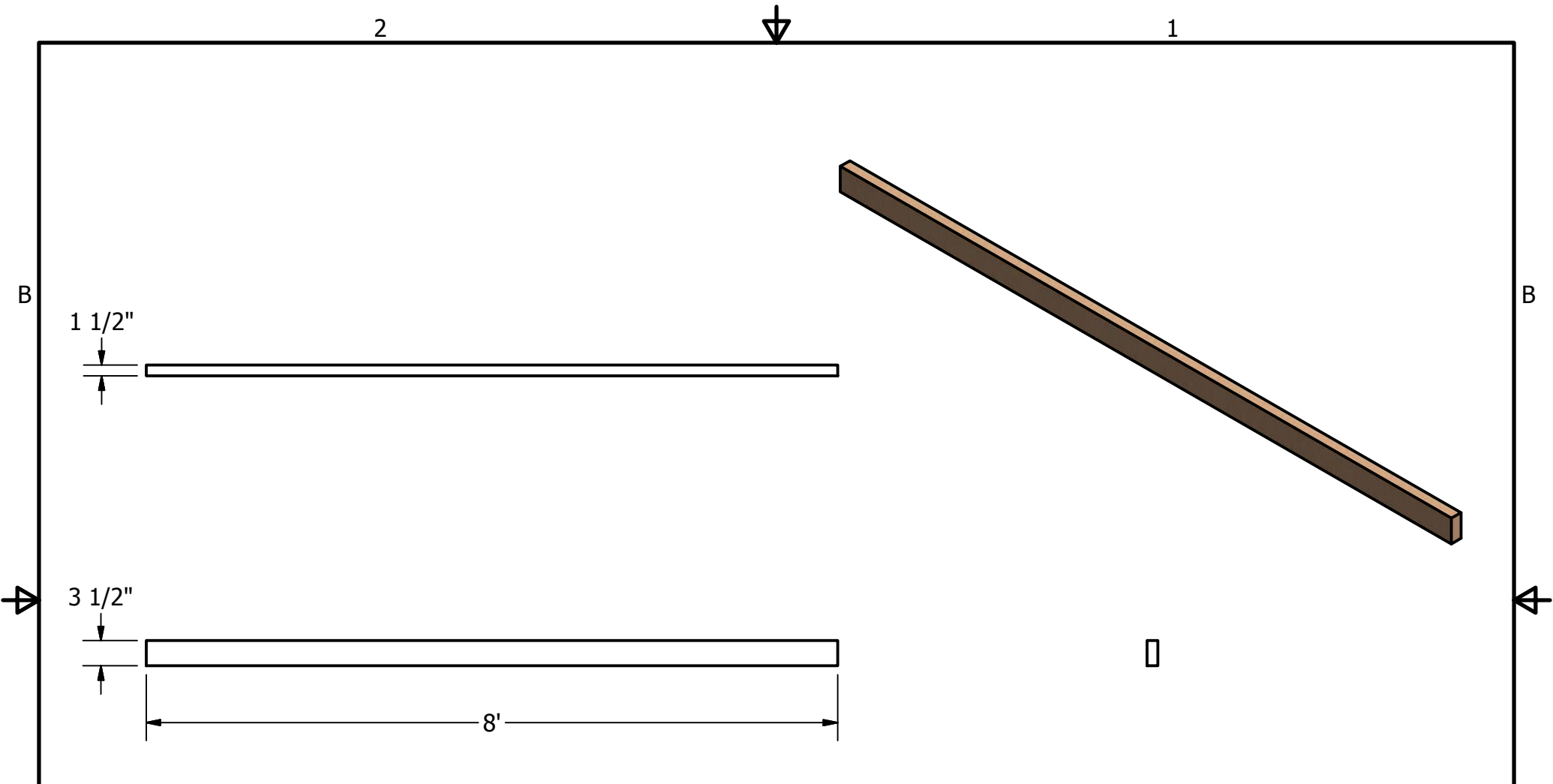

DRAWN Collin	7/8/2014	Part P - (Roof Assebly)	
CHECKED			
QA		TITLE x1 - 8' 2x4 - Treated	
MFG			
APPROVED			
		SIZE A	DWG NO Part P
		SCALE	REV
			SHEET 1 OF 1

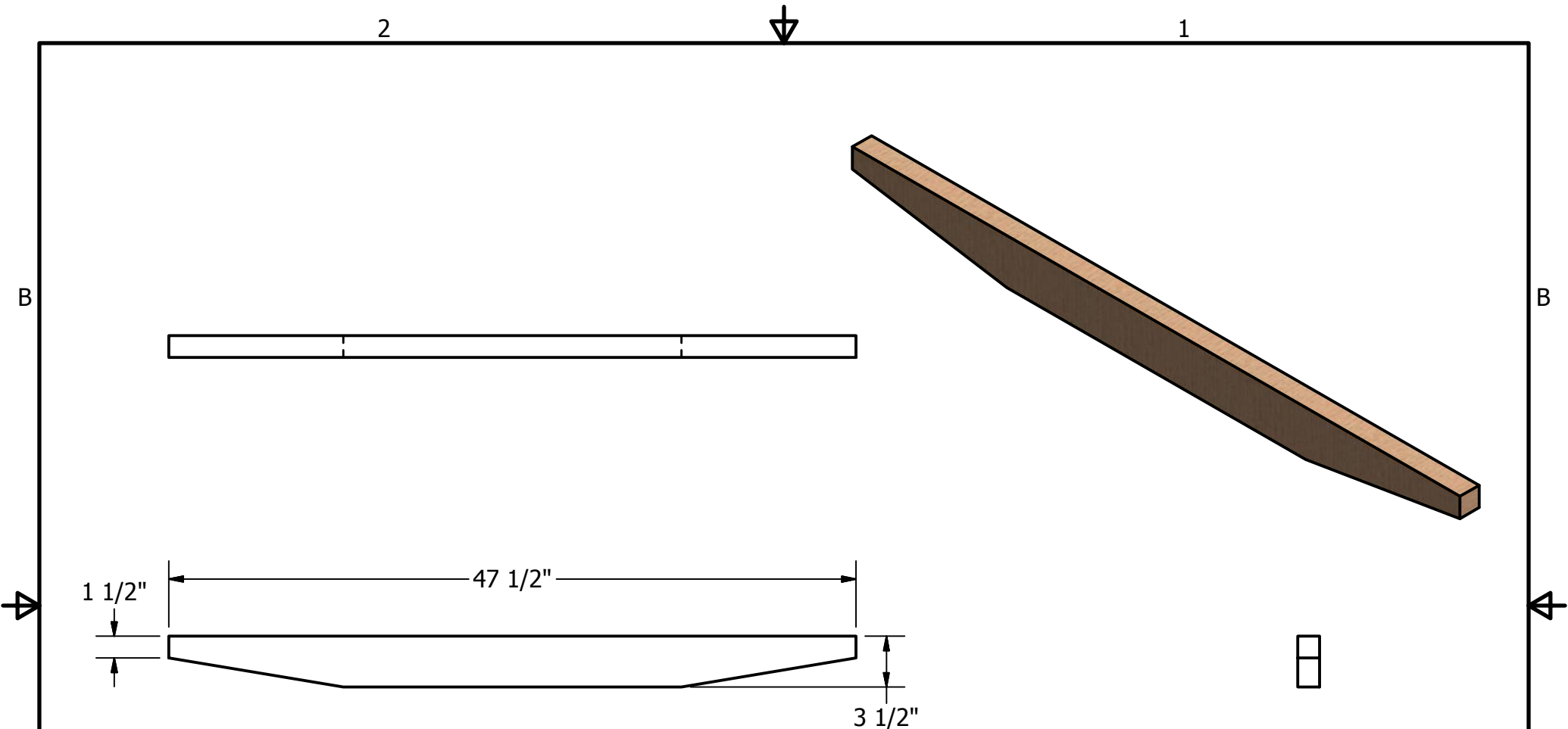

DRAWN Collin	7/8/2014
CHECKED	
QA	
MFG	
APPROVED	

Part Q - (Roof Assembly)			
TITLE x2 - 47 1/4" 2x4's - Treated			
SIZE A	DWG NO Part Q		REV
SCALE		SHEET 1 OF 1	

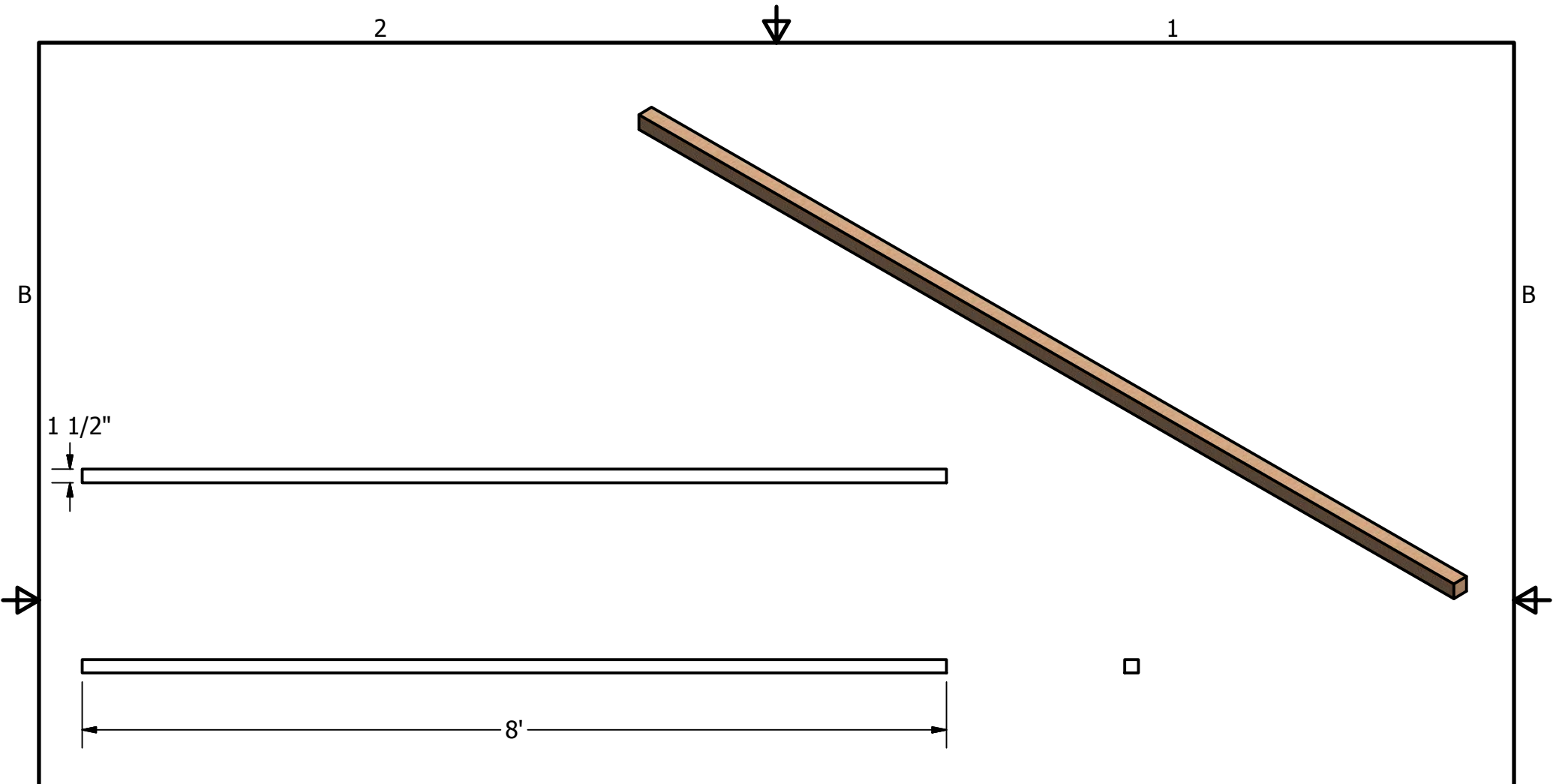

DRAWN Collin	7/8/2014
CHECKED	
QA	
MFG	
APPROVED	

Part R - (Roof Assembly)			
TITLE x2 - 8' 2x2's - Treated			
SIZE A	DWG NO Part R		REV
SCALE		SHEET 1 OF 1	

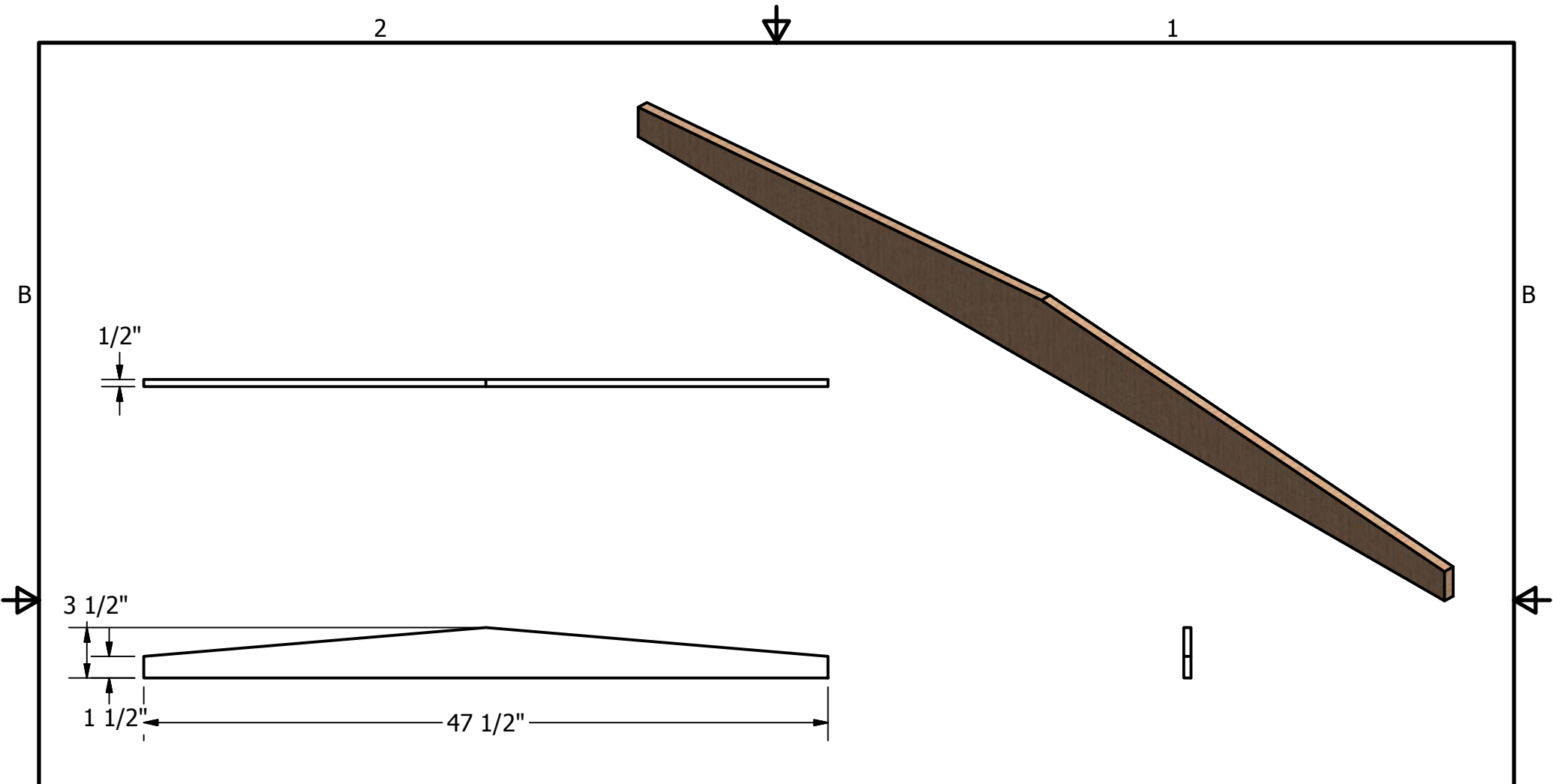

DRAWN Collin	7/8/2014
CHECKED	
QA	
MFG	
APPROVED	

Part S - (Roof Assembly)			
TITLE x2 - 47 1/2" 1x4's - Treated			
SIZE A	DWG NO Part S		REV
SCALE	SHEET 1 OF 1		