

From: Hopkins, Heidi - DNR [mailto:Heidi.Hopkins@Wisconsin.gov]
Sent: Friday, January 25, 2008 8:24 AM
To: Patrick Weier
Subject: RE: Pier Project

From what I can tell this is a Lakebed Grant area that was given by the Legislature to the City of Racine to use for public park, marina and harbor facilities. **The City of Racine would therefore, need to approve or at a minimum sign off on the structure.** Also because this is Lakebed Grant, any structures or fill in Lakebed must be for a public use, so the platform would have to be open to the public. If there are tables and chairs the use of those could not be exclusive to marina slip renters or Radisson/chancery patrons. **In terms of permitting process, there would be no formal Ch. 30 permit but the Department is required to review and approve any plans to place structures on the bed of Lake Michigan.**

If you have any questions please let me know.

Heidi A. Hopkins
Water Management Specialist
Wisconsin Department of Natural Resources
9531 Rayne Road, Suite IV
Sturtevant, WI 53177
phone: (262) 884-2355
fax: (262) 884-2307
email: heidi.hopkins@Wisconsin.gov
web page: <http://dnr.wi.gov/org/water/fhp/waterway>

EXHIBIT C

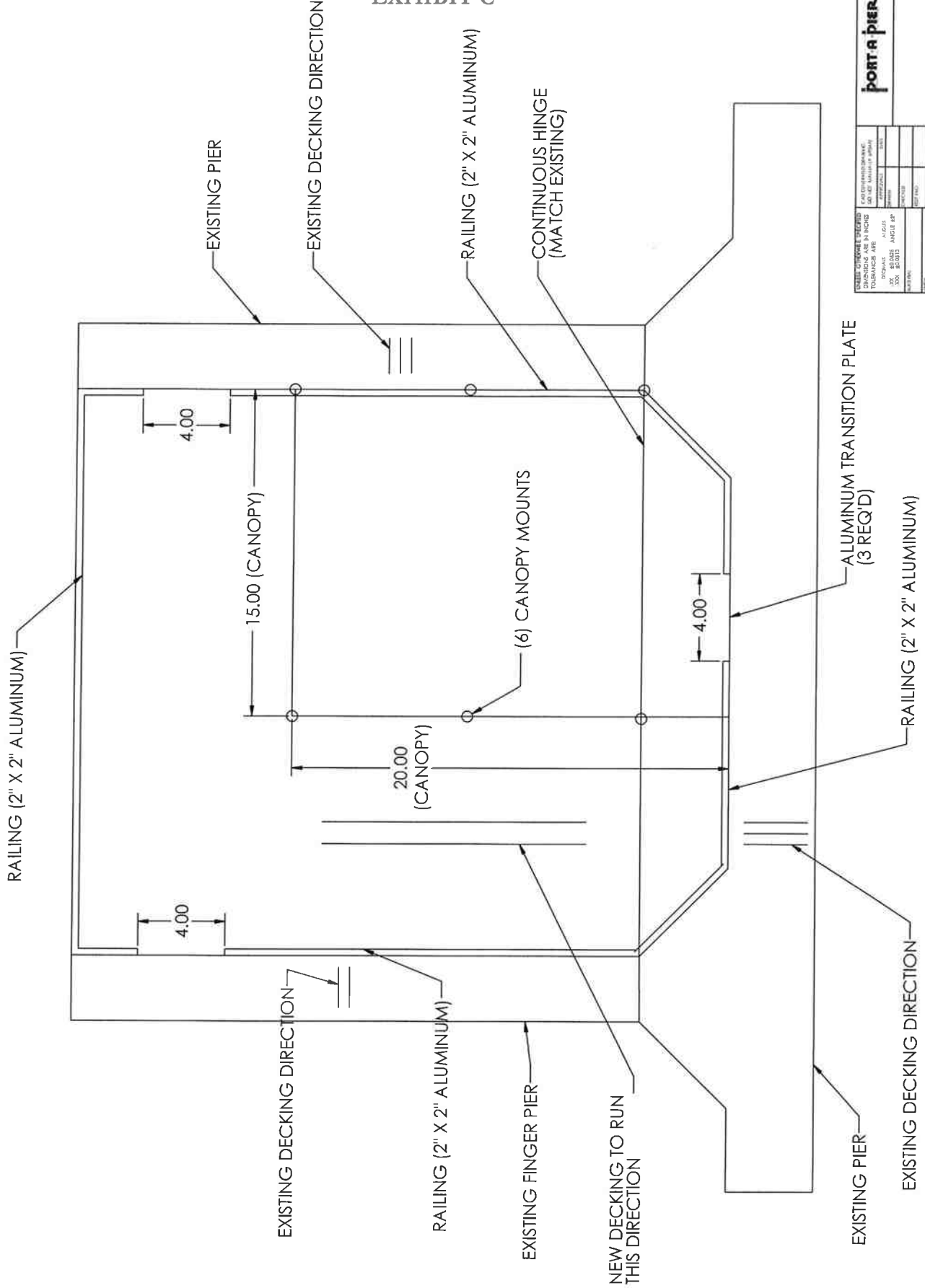

| | |
|---|---|
| <p>PORT-A-PIER 25' X 30' party dock FINAULT</p> | |
| <p>DATE: 11/11/11 DRAWN BY: J. B. BROWN CHECKED BY: J. B. BROWN SCALE: AS SHOWN SHEET NO.: 13 OF 13</p> | <p>PROJECT NO.: JOB NO.: JOB NAME: JOB ADDRESS: JOB PHONE: JOB FAX: JOB E-MAIL:</p> |
| <p>DO NOT SCALE DRAWING</p> | |

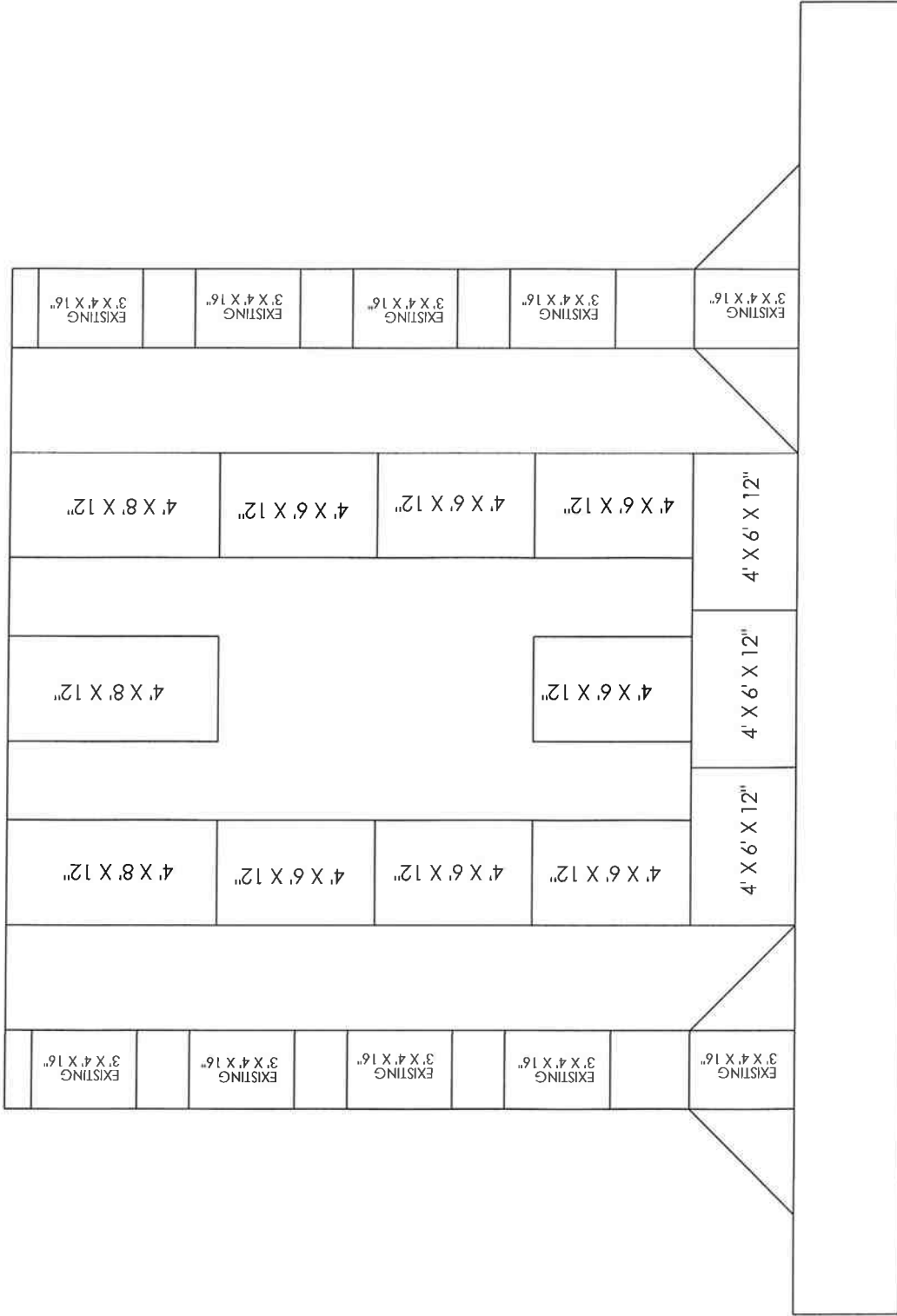

FLOAT LAYOUT

| | | |
|---|--|----------------------------|
| UNDESIGNATED PILING TOLERANCES ARE IN INCHES DO NOT SCALE DRAWING | LANDSCAPE PAVING DO NOT SCALE DRAWING | POINT-A-PIER, [®] |
| DATE: _____ | SCALE: _____ | |
| DRAWN BY: _____ | CHECKED BY: _____ | |
| PROJECT NO. _____ | PROJECT NAME _____ | |
| DATE: _____ | SUB DATE _____ | |
| PREP BY: _____ | | |
| DATE: _____ | | |
| | | |
| | | |

25' X 30' party dock_FINAL.dwg
1/26/13 12:46

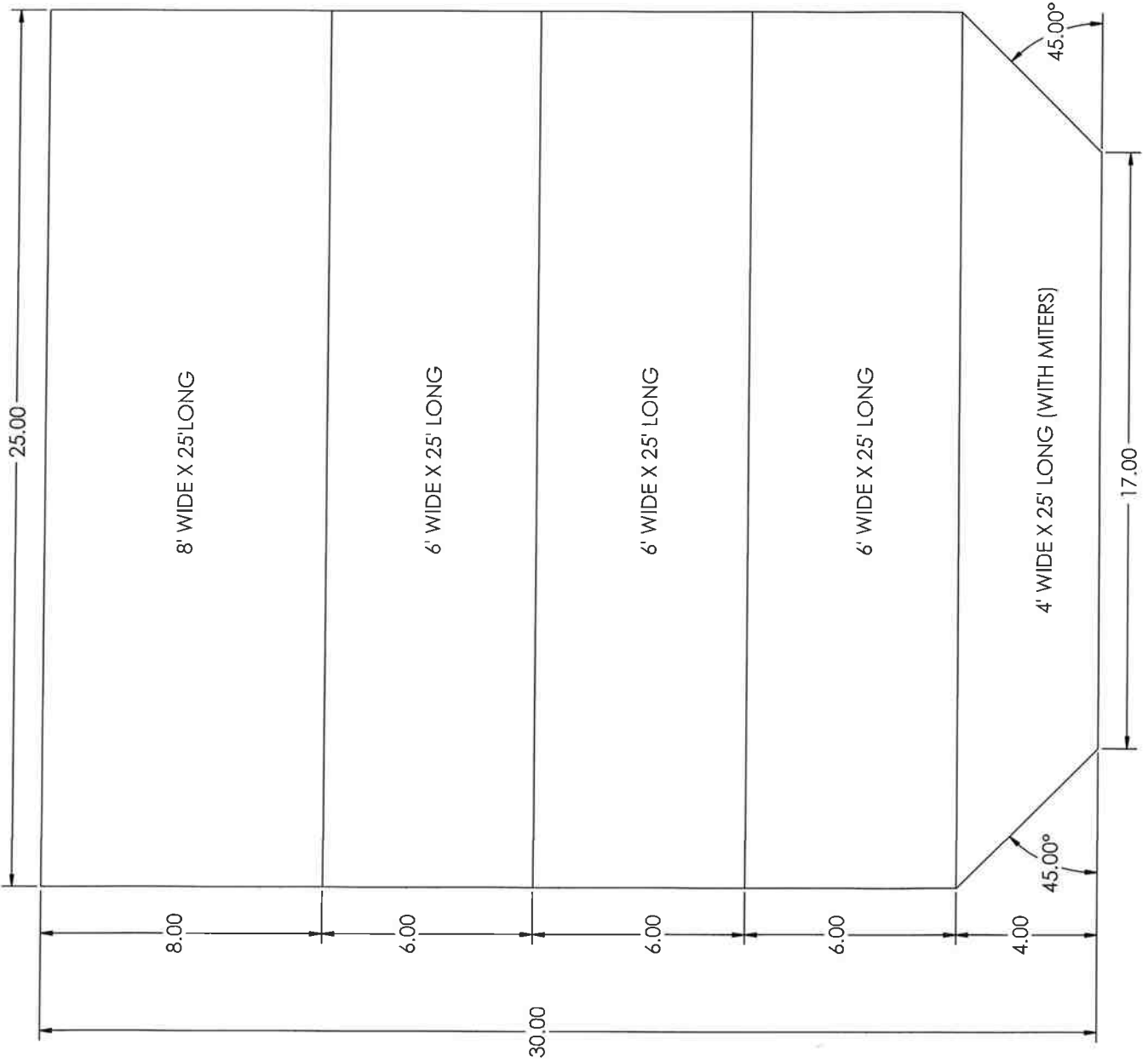

| | |
|--|----------------------------|
| ALL DIMENSIONS UNLESS OTHERWISE SPECIFIED ARE IN INCHES DIMENSIONS ARE TO FACE UNLESS OTHERWISE SPECIFIED | |
| DATE | 3/18/11 |
| BY | SJB |
| FOR | PORT-A-PIER |
| PROJECT | 26' X 30' party dock_FINAL |
| SCALE | AS SHOWN |
| NO. OF SHEETS | 1 OF 1 |

GASLIGHT POINTE MARINA, INC.

217 Gaslight Circle
Racine, WI 53403
Phone (262) 637-0400
Fax (262) 456-1627
ryanrosenthal@netzero.com

DATE: April 4, 2008
TO: City of Racine /
RE: PIER MODIFICATION APPROVAL REQUEST

Summary

Gaslight Pointe Marina, Inc. owns and manages the boat slips located on the Racine Harbor (Lakebed) located in front of The Radisson Hotel, The Link Building, The Chancery, and the new Atwater Condos as well as the slips located on the west side of The Root River in front of the Gaslight Pointe Condominiums.

Gaslight Pointe Marina, Inc. is requesting permission from the City of Racine to construct a “floating platform” in place of slip numbers 90 and 91 which are located in front of the Link Building and The Chancery Restaurant (See Exhibit A - Map).

The purpose of this area is to serve as a common area that will be used primarily by the boaters of Gaslight Pointe Marina as a place to congregate, picnic, etc. There will be no goods or services provided or sold in this area. On the platform there will be picnic tables, trash receptacles, a canopy and a couple of imitation palm trees.

All rules of the existing piers will apply to this platform. Examples are; Quiet hours apply (from 10:00 P.M. to 7:00 A.M.), and like the existing piers, the platform will be for public use.

For safety, the platform is being constructed by one of the most reputable commercial and residential pier construction companies in the Midwest. The name of their company is Port A Pier. Port A Pier has been in business for over 37 years (See Exhibit B – Company History). They are building the platform to commercial standards with heights consistent with the existing piers of Gaslight Pointe Marina. In addition, the platform will be built to OSHA Standards and featuring a 42” railing to go around the perimeter with 3 access locations (See Exhibit C – Building Specifications).

After reviewing this material, Gaslight Pointe Marina, Inc. is requesting the City of Racine to “sign off” via letter of permission (or equivalent) for the structure.

Sincerely,



Ryan Rosenthal
Gaslight Pointe Marina Manager

EXHIBIT A

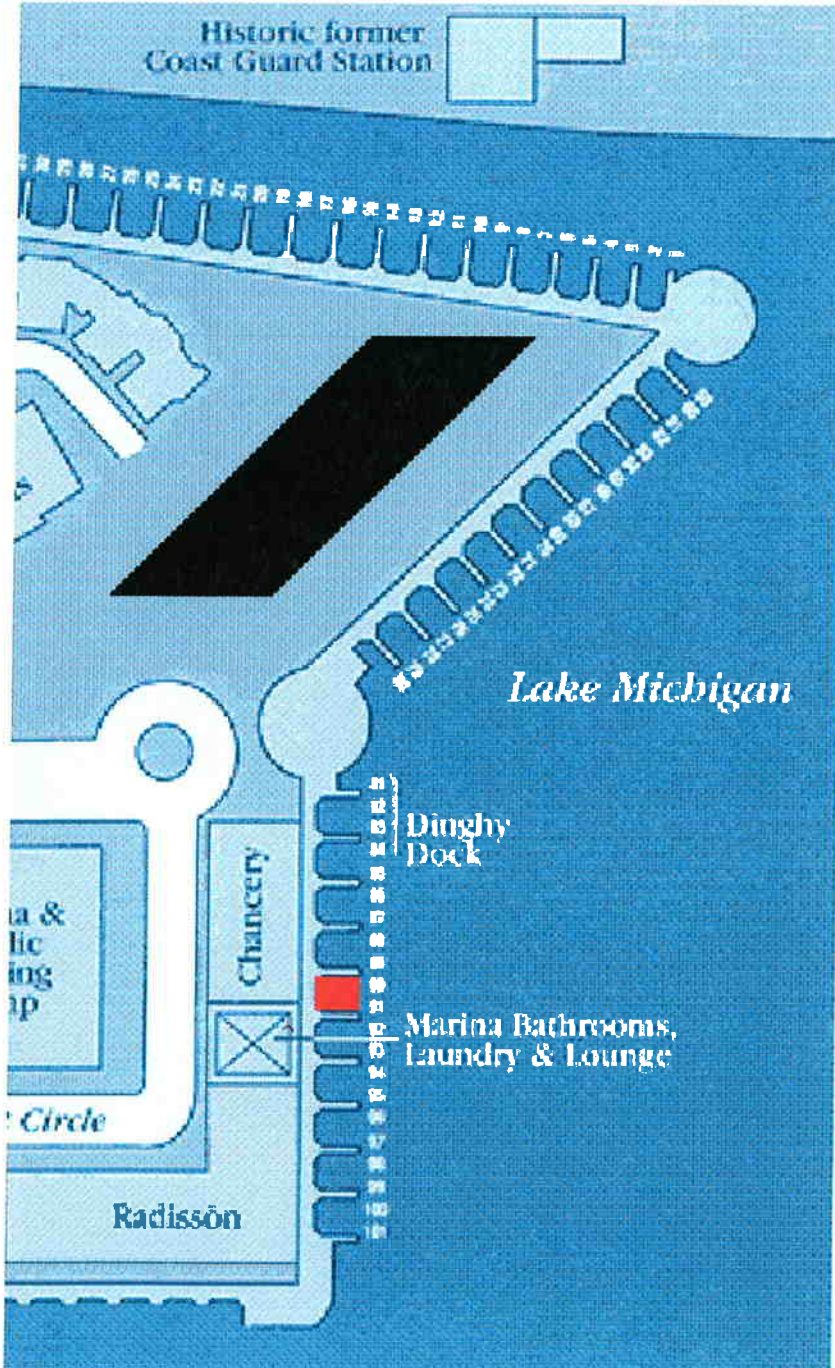

EXHIBIT B

Incomparable. Unbeatable. Port-A-Pier.



2212 South 35th Street Phone:(920)682-4908
 Manitowoc, WI 54220 Fax:(920)682-8754
 info@port-a-pier.com

Your Waterfront Specialist since 1970

History:



On a family vacation to Eli, Minnesota in 1970, the potential of a pier business was realized. William Paulson, along with his parents, Walter and Betty Paulson, and two of his sons, William and Rick, were enrolled in a fishing competition. While standing on a creaking and cracking old dock for 12 hours, Bill thought to himself, "there has to be a better way."

As he and his family were packing up their things that night in Minnesota, Bill spotted a man across the lake driving an old Chevrolet pick up truck into the water. He then saw the man get out of his truck and attach what looked like the frame of an old crane sitting in the water to the front of the pier. With this, the man got back in his truck and backed out of the water pulling a removable dock out with him. Bill, after seeing this, and knowing in his mind that there had to be a better way of building piers, drove over and talked to the man in the wet overalls with the pick up truck.

It turned out that the man was a retired farmer, and in his retirement enjoyed a private business of building docks for residential applications. Bill told his elder, "I like what you're doing with these removable docks and I think you have a good product. Would you mind if I started building and selling piers like this in Wisconsin?" The man obliged, and through a gentleman's agreement the rights were given to Bill. Thus, out of the shimmer of the setting sun that day in 1970, Port-A-Pier was born.



Old Style Paint Frame



Bill and Bonnie Paulson
 Founders of Port-A-Pier



The first Port-A-Pier piers were designed and built in the family single car garage. The prototype model for the first 24' straight section was completed in the fall of 1970. In 1971, the prototype for the T section and the first T section were completed.

More and more steel was ordered and the little single car garage sitting at the bottom of the hill was turned into a fabrication shop. The first piers had a towing hitch attached to the front and they were sandblasted and painted safety yellow. These piers had the option of having a white painted or stained cedar deck.



Transportation of the first couple of piers was a family affair. Bill sold most of the first piers in Door County, Wisconsin. Usually, a "pier trip" consisted of Bill pulling one pier behind the van, while his wife, Bonnie pulled another behind her Mercury station wagon, stopping every fifteen miles or so to grease the hubs. At the job site, Bill and his sons would assemble, position, and anchor the pier sections in the water by hand.

Through the years, modifications were made to the frames to improve the structure, maintenance, and overall appearance of the piers. The frames were no longer sandblasted and painted but instead were galvanized to ensure longer life. Analogously, at about the same time the traditional cedar deck was replaced with a maintenance free, recycled, white plastic decking and the zinc nails were replaced with stainless steel carriage bolts. In addition, the prototypes for the floating and inland lake piers were also developed.

In 1993, Bill's son, Rick Paulson, purchased the business from his parents and formed a corporation. To this day, he strives to uphold the mission that his father put in place 37 years ago: To produce strong, durable, zero maintenance floating and stationary structures for both residential and commercial waterfront applications.



PORT-A-PIER

2212 South 35th Street
Manitowoc, WI 54220

Phone: (920) 682-4908
Fax: (920) 682-8754

info@port-a-pier.com

Incomparable. Unbeatable. Port-A-Pier.

Your Waterfront Specialist since 1970

Contact:

[Home](#)
[Sales](#)
[Service](#)
[Mfg.](#)
[History](#)

Please contact us with any comments or questions you might have regarding any of our products or services. We'd be happy to work with you in any way we can!



Port-A-Pier
2212 South 35th Street
Manitowoc, WI 54220
Phone: (920) 682-4908
Fax: (920) 682-8754
Email: info@port-a-pier.com



President: Rick Paulson
email: rpaulson@port-a-pier.com

Office Manager: Cathy Mertens Paulson
email: cmertenspaulson@port-a-pier.com

Product Design and Purchasing: Pat Weier
email: pweier@port-a-pier.com

Sales and Service: Laura Stecker
email: lstecker@port-a-pier.com

Sales: Richard Fernbach
email: rfernbach@port-a-pier.com