



City of Racine

Café

Sidewalk

Permit Application

Return completed application, supporting documentation, and application fee to: City of Racine, City Clerk's Office, Room 103, 730 Washington Avenue, Racine, WI 53403. For assistance, please call 262 636-9171.

YEAR: 2021/2022

APPLICANT INFORMATION	Date: <u>5/17/21</u>	PERMIT TYPE: <input checked="" type="checkbox"/> New Permit (\$100) <input checked="" type="checkbox"/> w/alcohol (\$25) <input type="checkbox"/> Renewal (\$100)
	Restaurant Owner: <u>JOE MADISON</u>	
	Restaurant Name: <u>PEP'S PUB AND GRILL</u>	
	Restaurant Address: <u>618 6TH STREET</u>	
	Telephone: <u>262-633-6111</u> Fax: <u>262-633-6176</u>	
	Requested Number of Outdoor: Tables: <u>4</u> Chairs: <u>12</u>	
REQUIRED MATERIALS	Applications will not be accepted without the following:	
	<input checked="" type="checkbox"/> Copy of a valid restaurant license <input checked="" type="checkbox"/> Copy of a current certificate of insurance <u>SENT TO CITY CLERK</u> <input checked="" type="checkbox"/> A layout, drawn to scale on 8.5" x 11" paper, which accurately depicts the dimensions of the existing sidewalk area and adjacent private property, the proposed location of the sidewalk café, size and number of tables, chairs, steps, planters, and umbrellas, location of doorways, trees, obstructions, either existing or proposed, within the pedestrian area. <input checked="" type="checkbox"/> Photographs, drawings, or manufacturer's brochures describing the appearance and dimensions of all tables, chairs, umbrellas or other objects related to the sidewalk café. <input checked="" type="checkbox"/> A non-refundable application fee New Permit - \$100 New permit w/alcohol expansion - \$125 Permit renewal - \$100 Permit renewal w/alcohol expansion - \$100	
SIGNATURE	If this application is approved, I hereby agree to abide by all the relevant City regulations pertaining to the installation of sidewalk cafés, including but not limited to Sections 82-150 through 82-160 of the Municipal Code of the City of Racine. <u>[Signature]</u> Signature - Restaurant Owner	
	This application is made with my/our knowledge and consent. <u>[Signature]</u> Signature - Property Owner(s)	

EXISTING

NORTH ↑
SCALE
1" = 1'

TREE

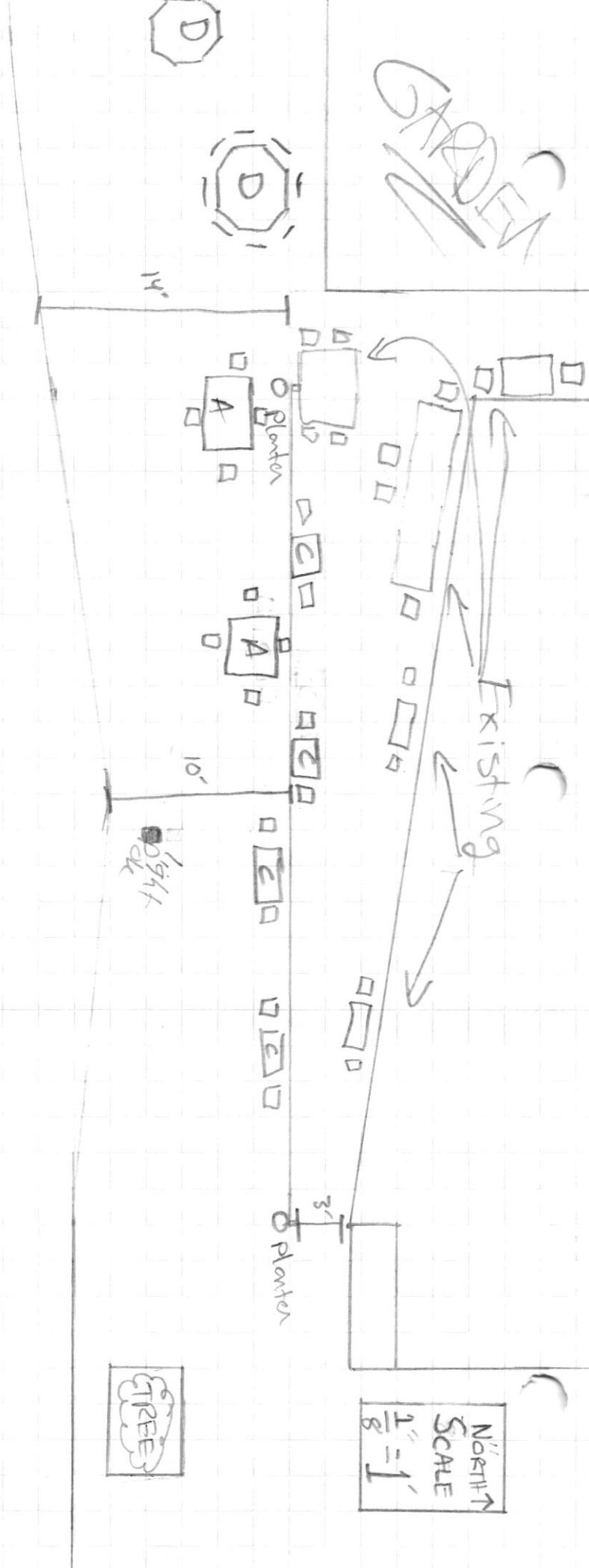

14'

Plaster

A

C

10'

1/2" = 1'

Plaster

Existing